

## ASSEMBLY INSTRUCTIONS

# MOD-7156

V1.12.12.23

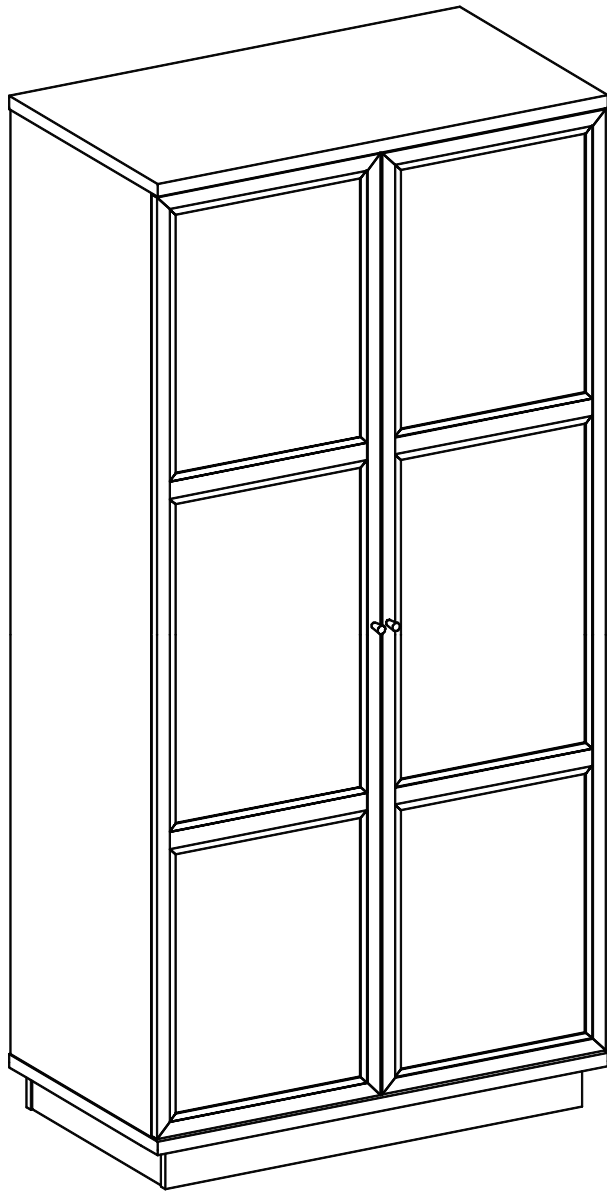

### Questions? Contact us!

609.256.9000 • [cs@modway.com](mailto:cs@modway.com)  
[www.modway.com](http://www.modway.com)

\*modway



Read through all of the instructions before starting



Care instructions are listed in the last step of this manual



Approx. 60 minutes assembly time



Make sure you have all parts and components before discarding any packing materials



2 people recommended for assembly

**Only use hand tools to assemble this item.** Do not use power tools. Do not tighten bolts or screws completely until all hardware is lined up and inserted into the holes.

Do not over-tighten screws and bolts to avoid stripping the hardware or cracking the item.

Assemble your item on a flat, carpeted area, with plenty of space to work. This will prevent damage and scratches to your floors or the item while you're assembling the product.

Keep all components and packaging out of reach of children or animals to avoid risk of choking or suffocation.

## Furniture components:

1	Top Board	x1	8	Top/Bottom Rear Board	x2
2	Bottom Board	x1	9	Middle Rear Board	x2
3	Left Board	x1	10	Front/Rear Bottom Support	x2
4	Right Board	x1	11	Middle Bottom Support	x3
5	Fix Shelf	x1	12	Door	x2
6	Adjustable Shelf	x2			
7	Front Support	x1			

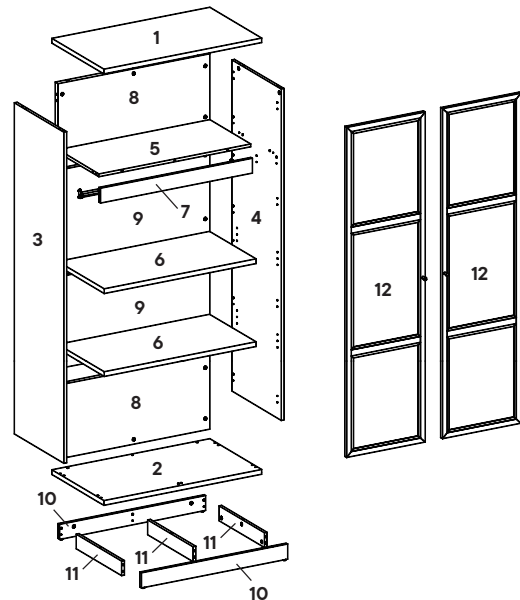

## Provided hardware:

A		Cam Lock Ø15 mm	x42	J		Pipe Support	x2
B		Cam Bolt Ø7.5 x 32 mm	x42	K		Shelf Support	x8
C		Cam Cover Ø17 mm	x24	L		Screw M6 x 13 mm	x2
D		Plastic Dowel M8 x 32 mm x46		M		Hunger Pipe	x1
E		Screw M10 x 33.5 mm	x4	N		Screw M4 x 10 mm	x16
F		Door Stopper	x2	O		Cam Cap Ø17 mm	x18
G		Door Hinge	x8	P		Wall Bracket Set	x1
H		Screw M4 x 25 mm	x2				
I		Handle	x2				

## What you need:



Wait!

Missing parts or hardware? Need assistance?  
Contact us before returning your item. We're here to help!  
609.256.9000 • cs@modway.com

# Step 1

## HARDWARE

- B** Cam Bolt  $\varnothing 7.5 \times 32$  mm      x5
- F** Door Stopper                              x1

## COMPONENTS

- 1** Top Board                                      x1

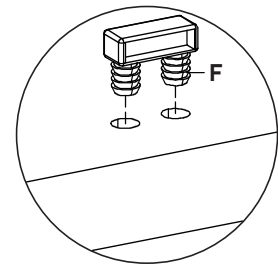
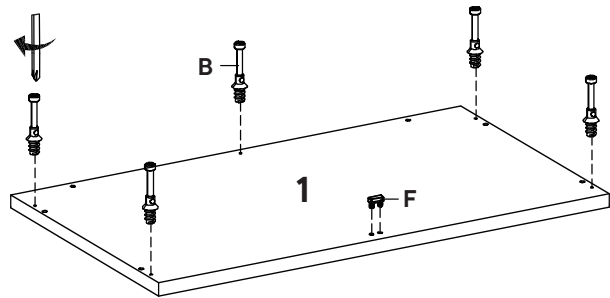

# Step 2

## HARDWARE

- B** Cam Bolt  $\varnothing 7.5 \times 32$  mm      x8
- F** Door Stopper                              x1

## COMPONENTS

- 2** Bottom Board                                x1

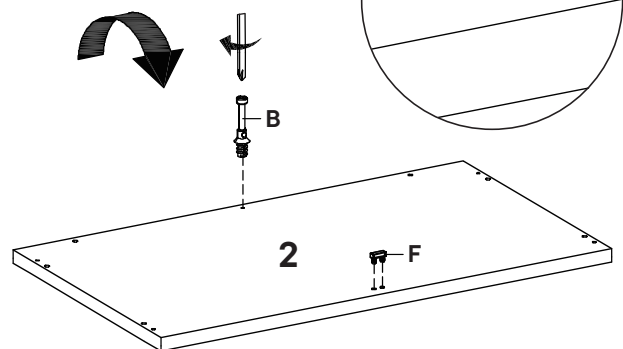
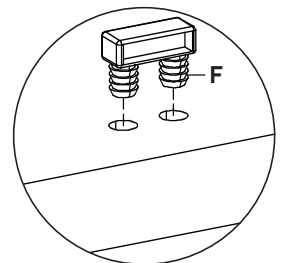
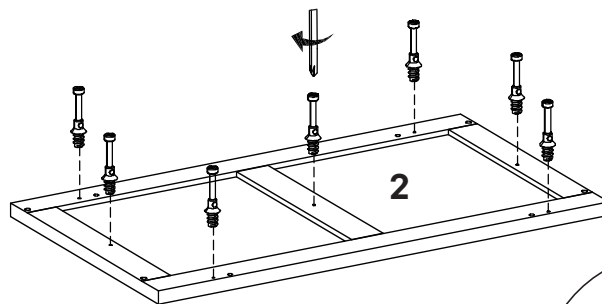

## Step 3

### HARDWARE

<b>B</b>	Cam Bolt $\varnothing 7.5 \times 32$ mm	x11
<b>D</b>	Plastic Dowel M8 x 32 mm	x4
<b>J</b>	Pipe Support	x1
<b>L</b>	Screw M6 x 13 mm	x1

### COMPONENTS

<b>3</b>	Left Board	x1
----------	------------	----

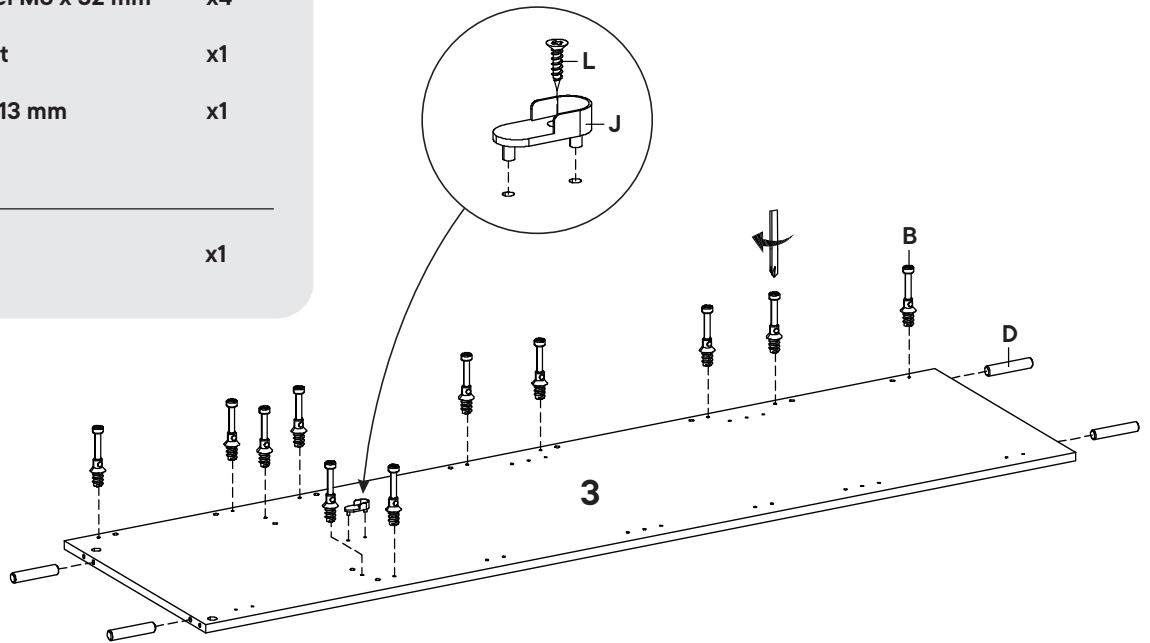

## Step 4

### HARDWARE

<b>B</b>	Cam Bolt $\varnothing 7.5 \times 32$ mm	x11
<b>D</b>	Plastic Dowel M8 x 32 mm	x4
<b>J</b>	Pipe Support	x1
<b>L</b>	Screw M6 x 13 mm	x1

### COMPONENTS

<b>4</b>	Right Board	x1
----------	-------------	----

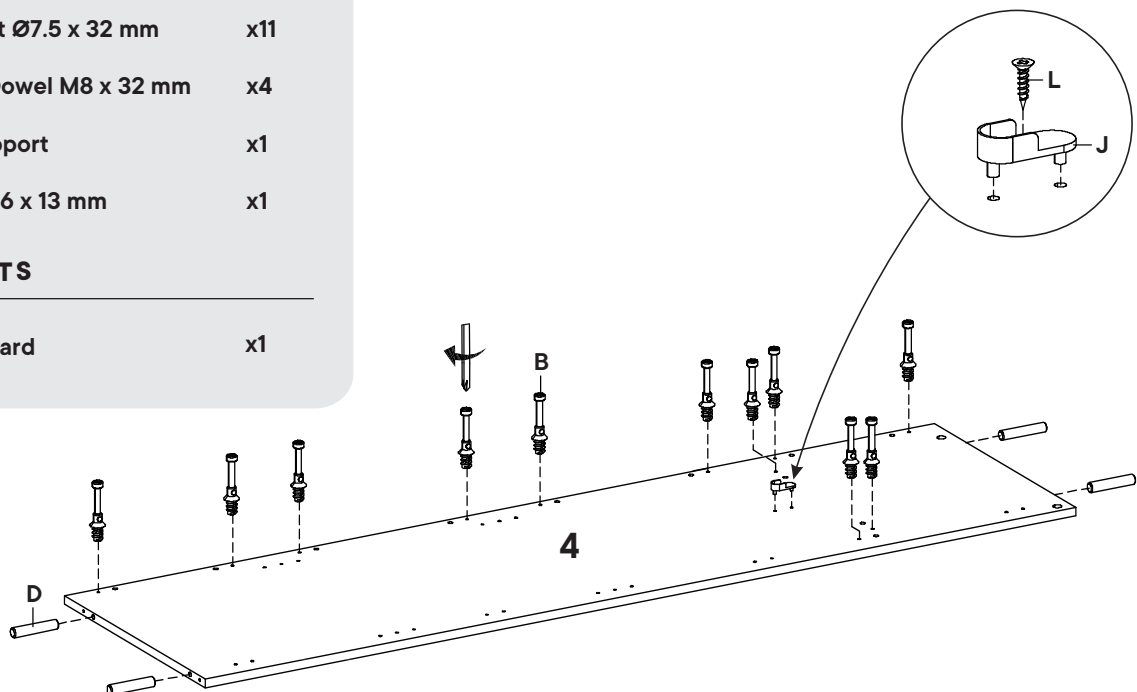

## Step 5

### HARDWARE

**D** Plastic Dowel M8 x 32 mm x26

### COMPONENTS

**5** Fix Shelf x1

**8** Top/Bottom Rear Board x2

**9** Middle Rear Board x2

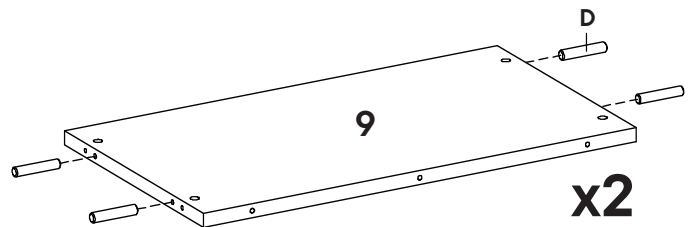
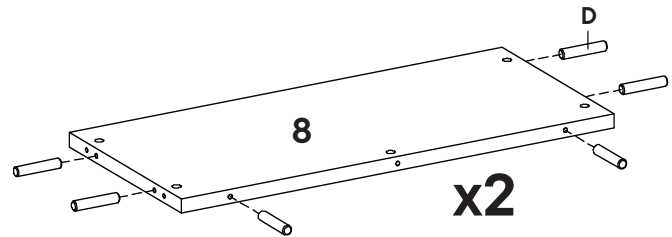
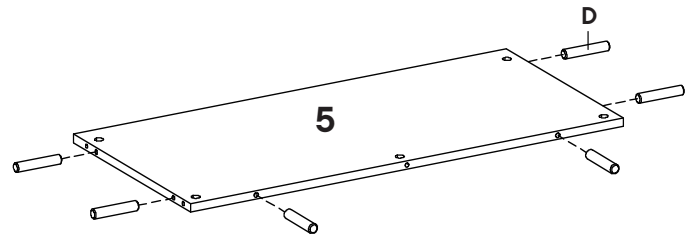

## Step 6

### HARDWARE

**B** Cam Bolt  $\varnothing 7.5 \times 32$  mm x7

**D** Plastic Dowel M8 x 32 mm x12

### COMPONENTS

**7** Front Support x1

**10** Front/Rear Bottom Support x2

**11** Middle Bottom Support x3

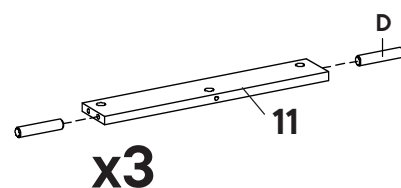
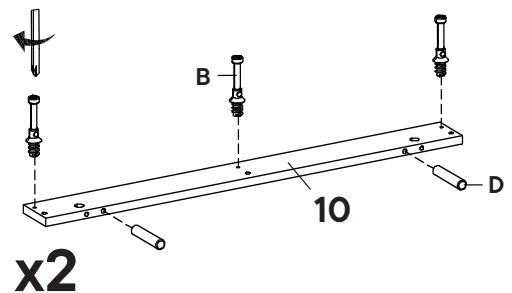
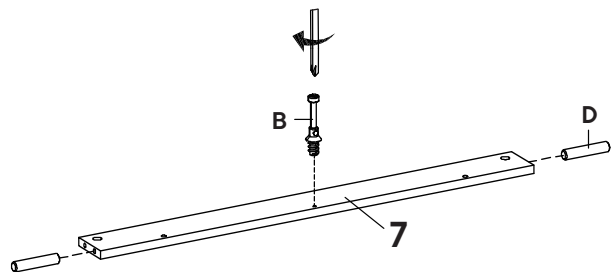

## Step 7

### HARDWARE

**D** Plastic Dowel M8 x 32 mm x9

### COMPONENTS

**8** Top/Bottom Rear Board x2

**9** Middle Rear Board x2

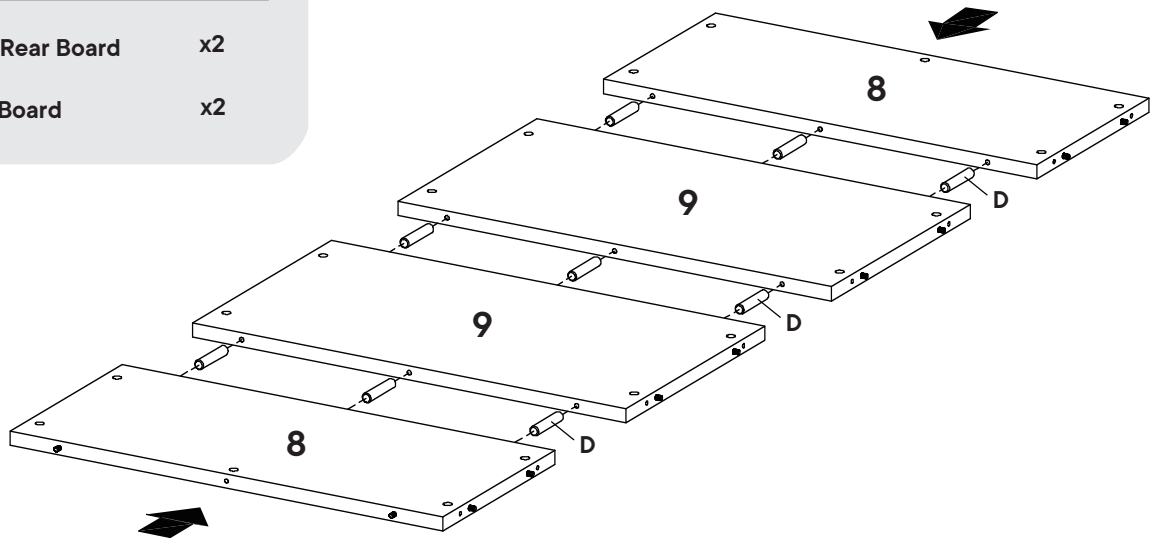

## Step 8

### HARDWARE

**A** Cam Lock Ø15 mm x8

**O** Cam Cap Ø17 mm x8

### COMPONENTS

**3** Left Board x1

**8** Top/Bottom Rear Board x2

**9** Middle Rear Board x2

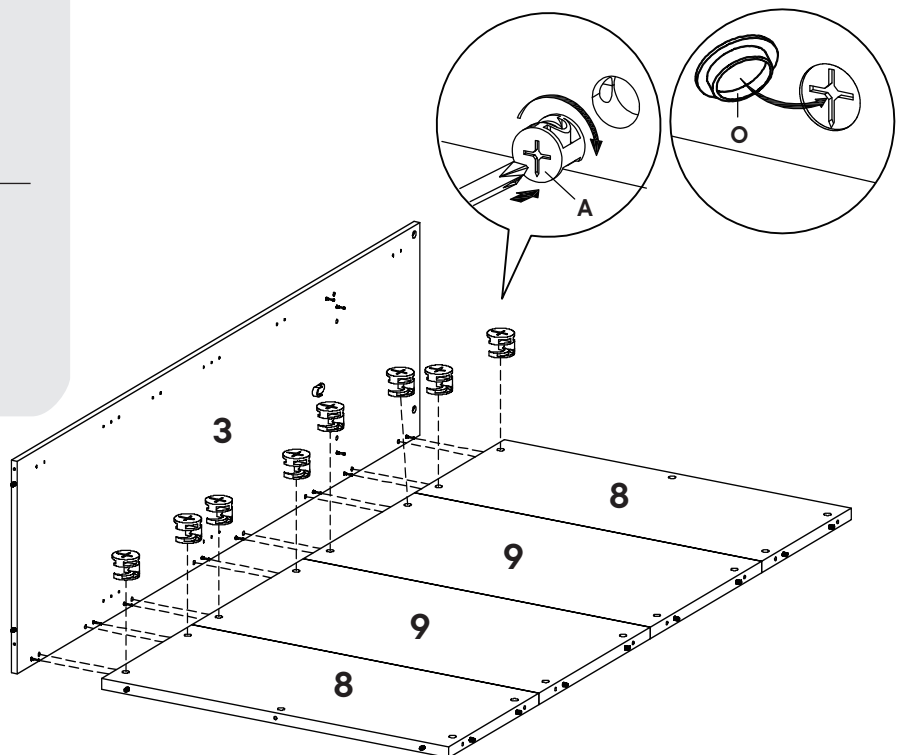

## Step 9

### HARDWARE

- A** Cam Lock Ø15 mm x1
- C** Cam Cover Ø17 mm x1

### COMPONENTS

- 5** Fix Shelf x1
- 7** Front Support x1

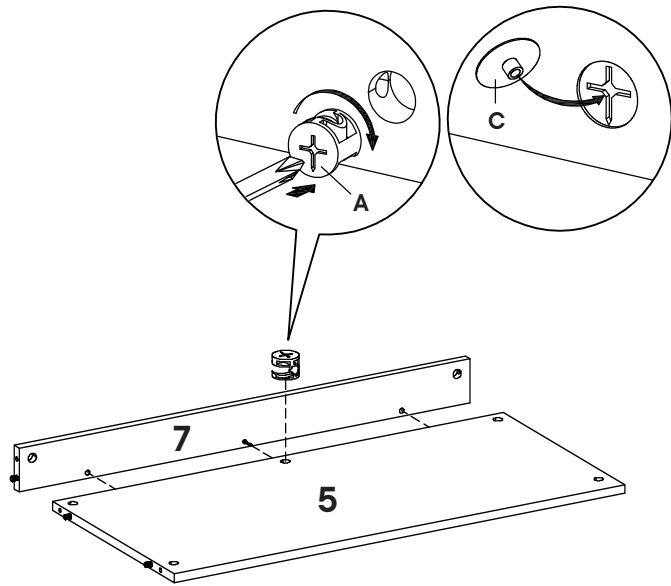

## Step 10

### HARDWARE

- A** Cam Lock Ø15 mm x3
- C** Cam Cover Ø17 mm x3

### COMPONENTS

- 3** Left Board x1
- 5** Fix Shelf x1
- 7** Front Support x1

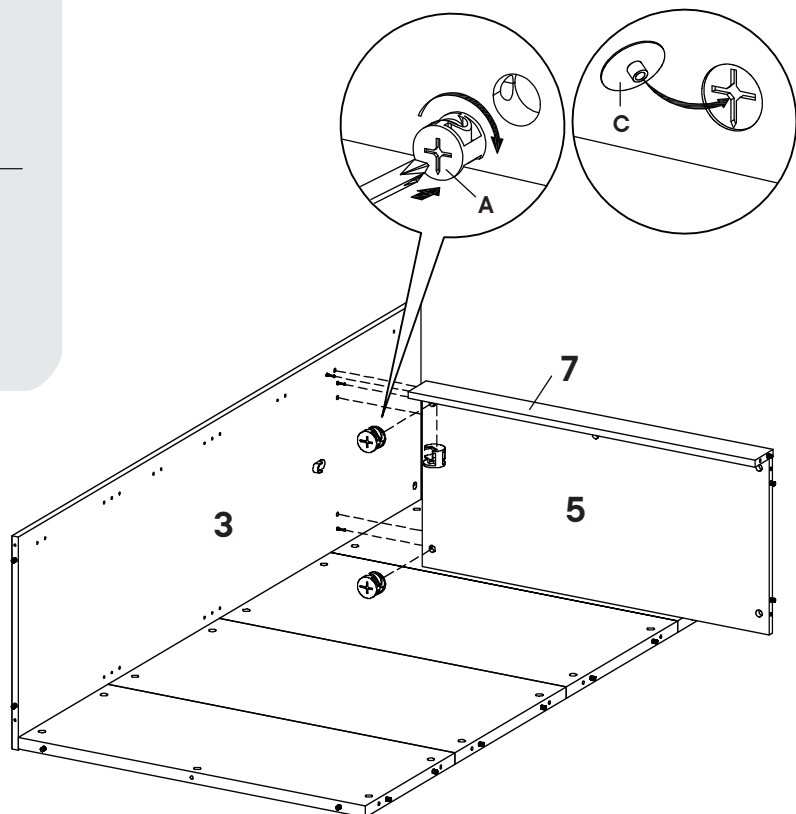

# Step 11

## HARDWARE

- A** Cam Lock Ø15 mm x11
- C** Cam Cover Ø17 mm x3
- O** Cam Cap Ø17 mm x8

## COMPONENTS

- 4** Right Board x1
- 5** Fix Shelf x1
- 7** Front Support x1
- 8** Top/Bottom Rear Board x2
- 9** Middle Rear Board x2

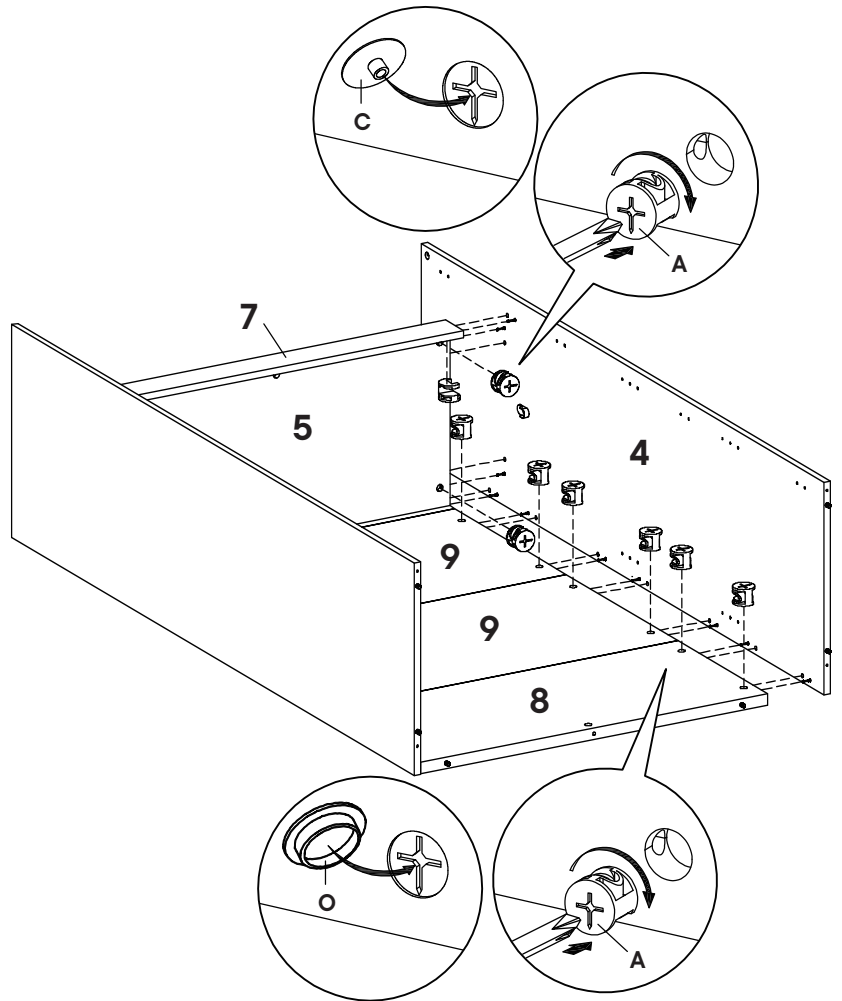

# Step 12

## HARDWARE

- A** Cam Lock Ø15 mm x1
- E** Screw M10 x 33.5 mm x4
- O** Cam Cap Ø17 mm x1

## COMPONENTS

- 2** Bottom Board x1
- 3** Left Board x1
- 4** Right Board x1
- 8** Top/Bottom Rear Board x1

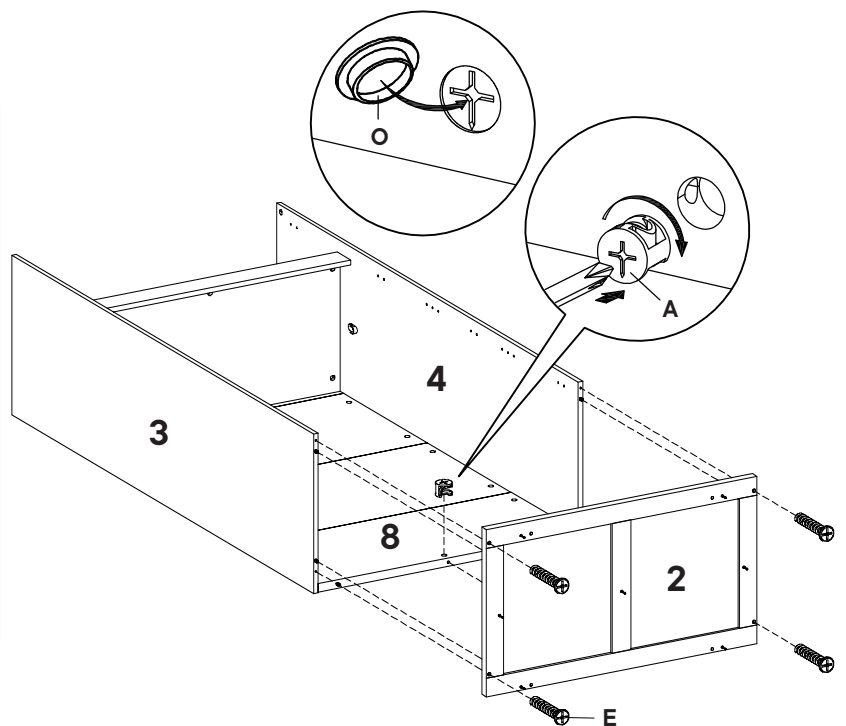



## Step 13

### HARDWARE

- A** Cam Lock Ø15 mm x6
- C** Cam Cover Ø17 mm x6

### COMPONENTS

- 10** Front/Rear Bottom Support x2
- 11** Middle Bottom Support x3

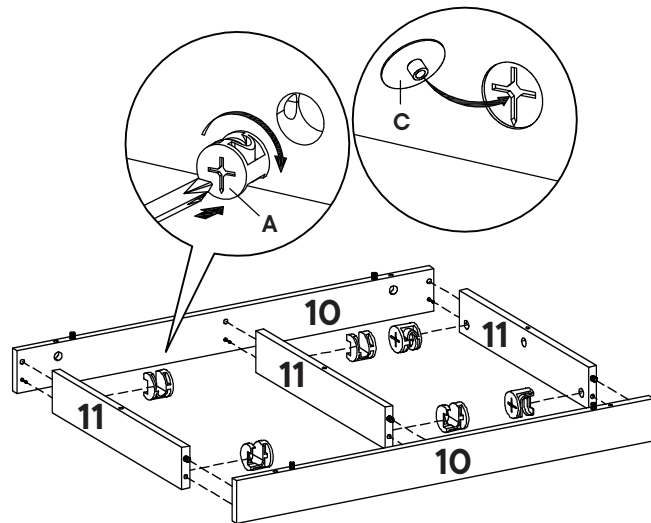

## Step 14

### HARDWARE

- A** Cam Lock Ø15 mm x7
- C** Cam Cover Ø17 mm x7

### COMPONENTS

- 2** Bottom Board x1
- 10** Front/Rear Bottom Support x2
- 11** Middle Bottom Support x3

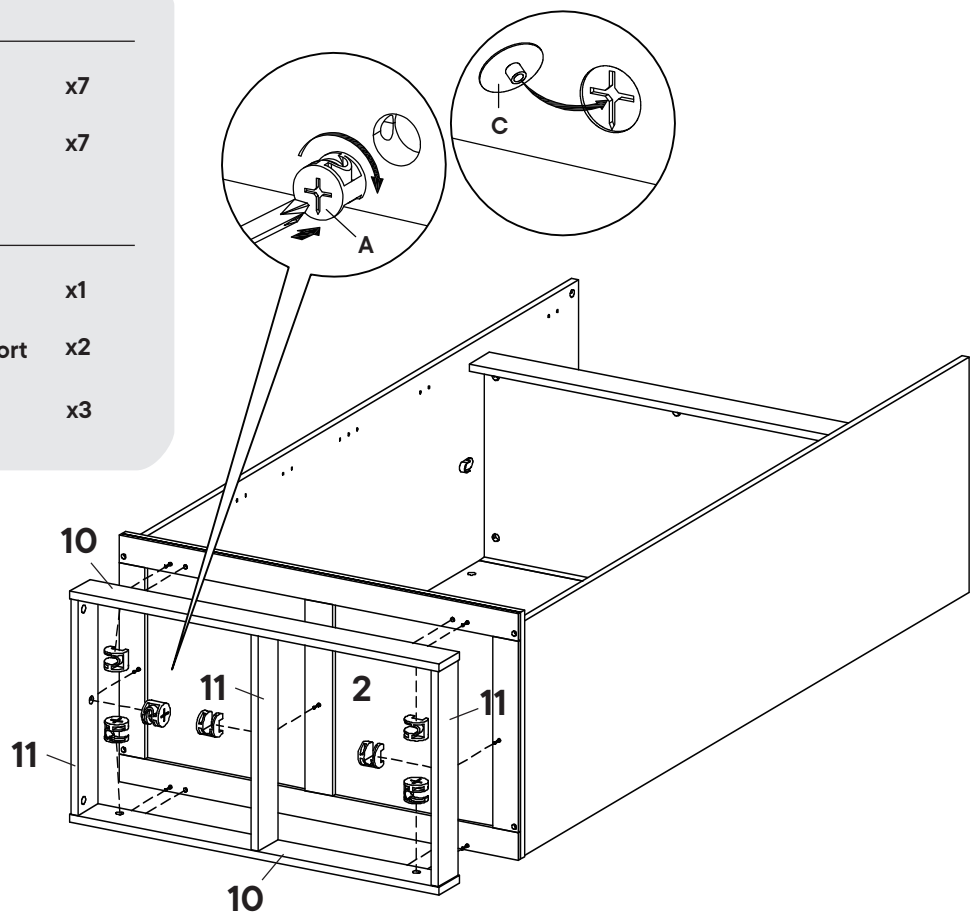

# Step 15

## HARDWARE

- A** Cam Lock Ø15 mm x5
- C** Cam Cover Ø17 mm x4
- M** Hunger Pipe x1
- O** Cam Cap Ø17 mm x1

## COMPONENTS

- 1** Top Board x1
- 3** Left Board x1
- 4** Right Board x1
- 8** Top/Bottom Rear Board x1

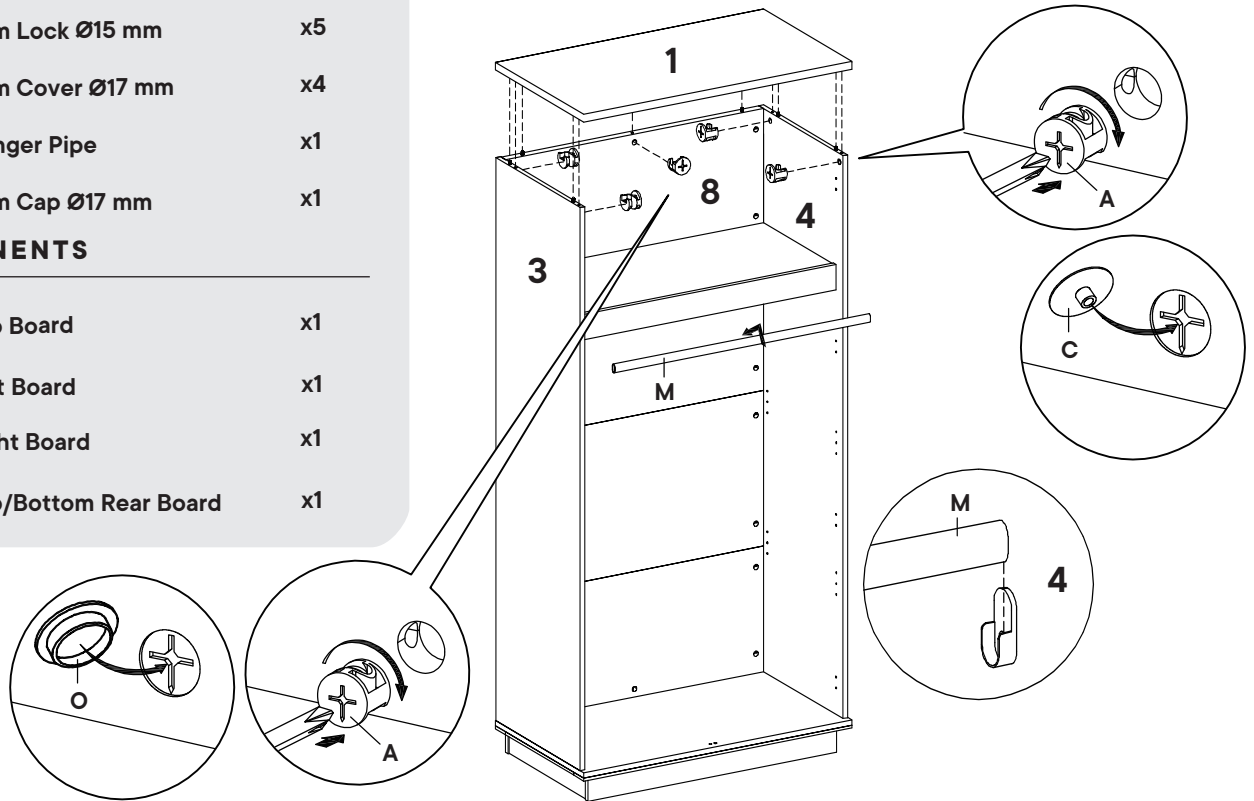

# Step 16

## HARDWARE

- K** Shelf Support x8

## COMPONENTS

- 3** Left Board x1
- 4** Right Board x1
- 6** Adjustable Shelf x2

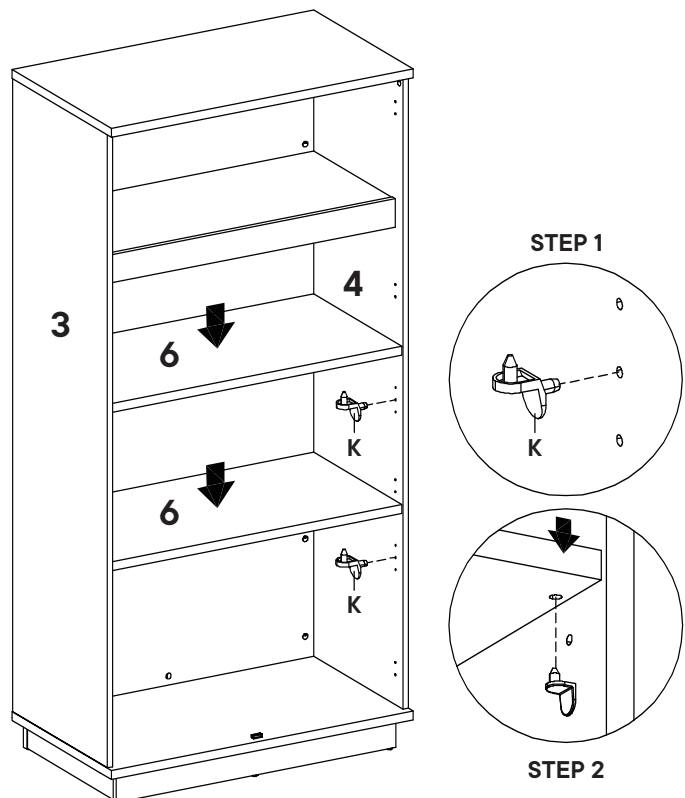

# Step 17

## HARDWARE

- G** Door Hinge x8
- H** Screw M4 x 25 mm x2
- I** Handle x2
- N** Screw M4 x 10 mm x16

## COMPONENTS

- 12** Door x2

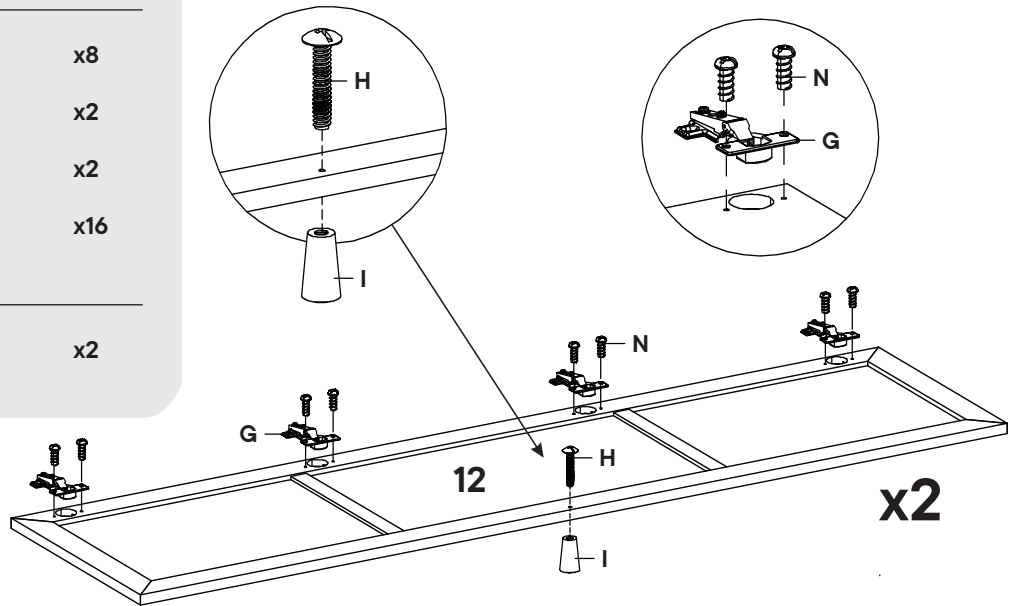

# Step 18

## COMPONENTS

- 3** Left Board x1
- 4** Right Board x1
- 12** Door x2

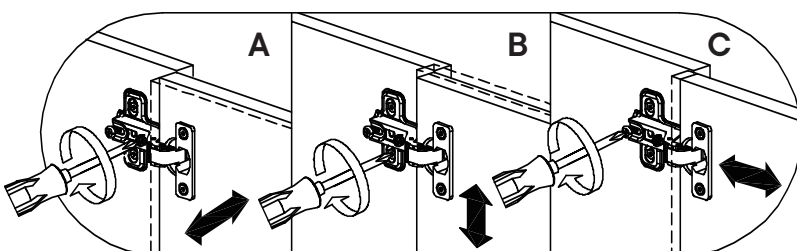
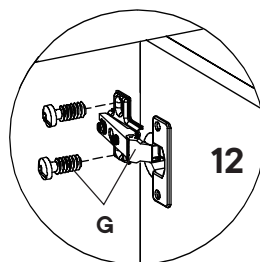
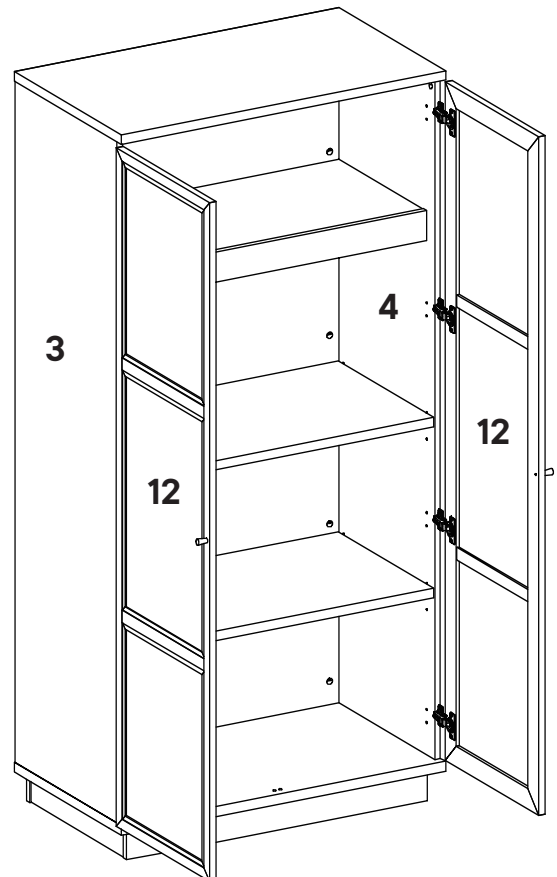

# Great job!

Tall Storage Cabinet assembly is complete.

## ♥ CARING FOR YOUR ITEM

Indoor use only.

Not contract grade.

Clean using a non-abrasive cloth and a mild cleaner.

Never use harsh chemicals, as they could damage the finish or integrity of the item.

CONNECT WITH US!   

Tag us @modway\_furniture and #modway for a chance to be featured.

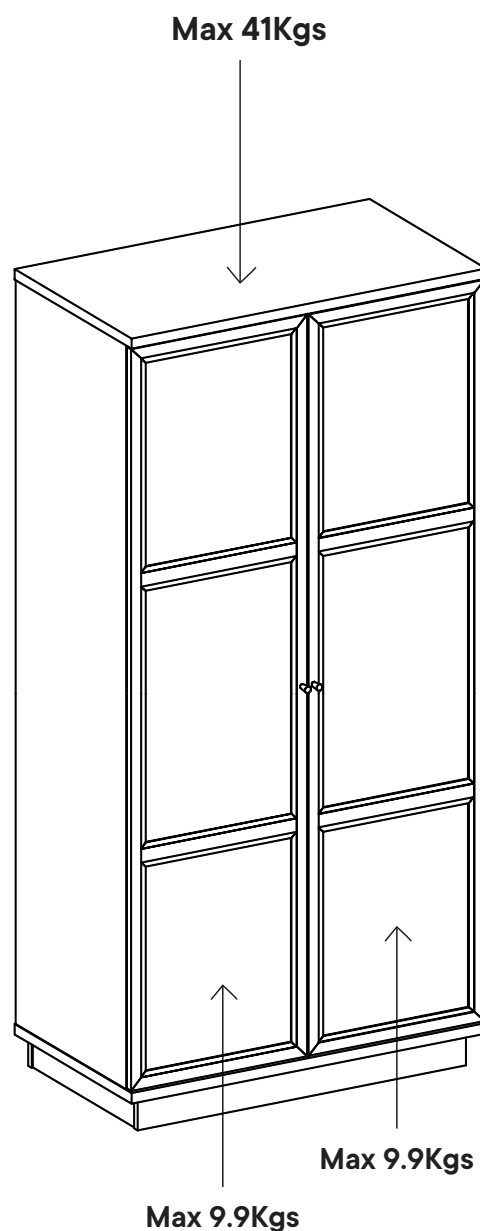

## TIPPING RESTRAINTS KIT INSTALLATION GUIDANCE

Different wall materials require unique wall fasteners.

Please consult your local hardware store to ensure you are using the correct hardware for you wall type.

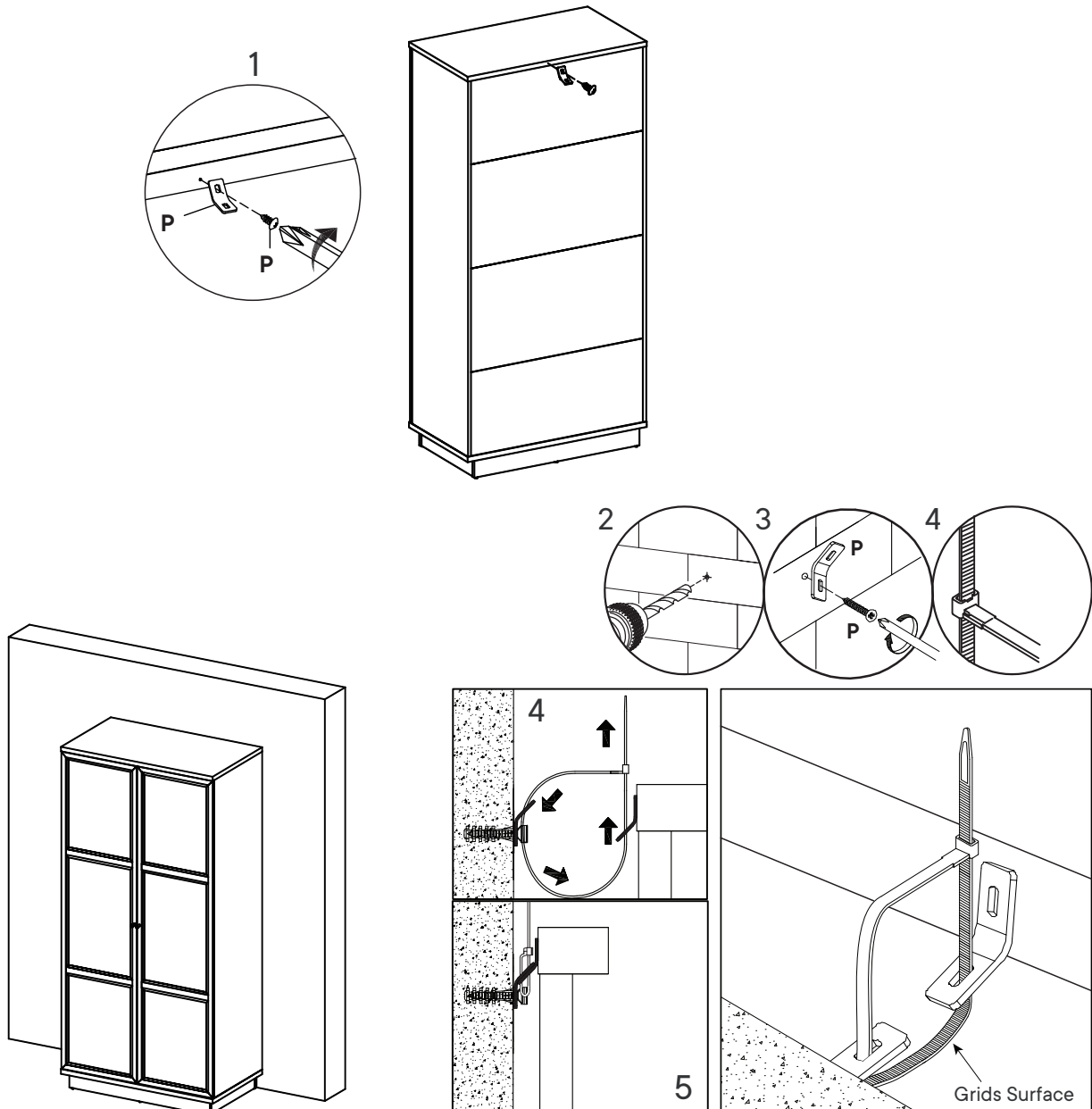
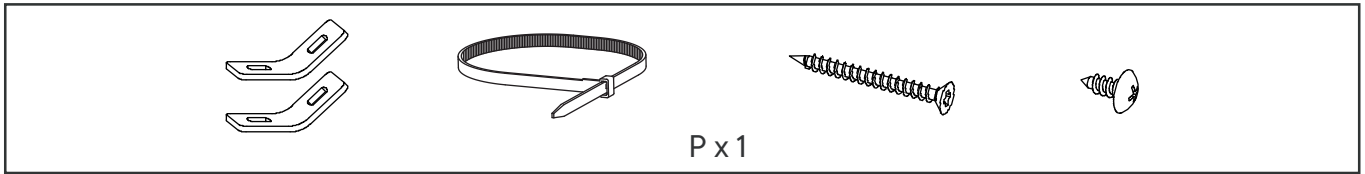

### **Installation Instructions :**

1. Attach bracket (P) securely to the back top of the furniture using short screw (P) provided.
2. Please make a hole on the wall for attach the bracket (P) to the back of unit.
3. Attach bracket (P) on the wall using long screw (P) as shown.  
Locate the other bracket (P) on the wall. Place furniture into position so both brackets (P) as shown.
4. Lace the end of the restrains strap through the larger hole in each bracket. Ensure the restrains strap with grids surface facing the inner loops. Bring both ends together and slide the flat end through the locking end and draw it through until all slack is removed.
5. Make sure that the strap is securely laced & locked.