

# ASSEMBLY INSTRUCTIONS

# MOD-7017

VO.09.12.21

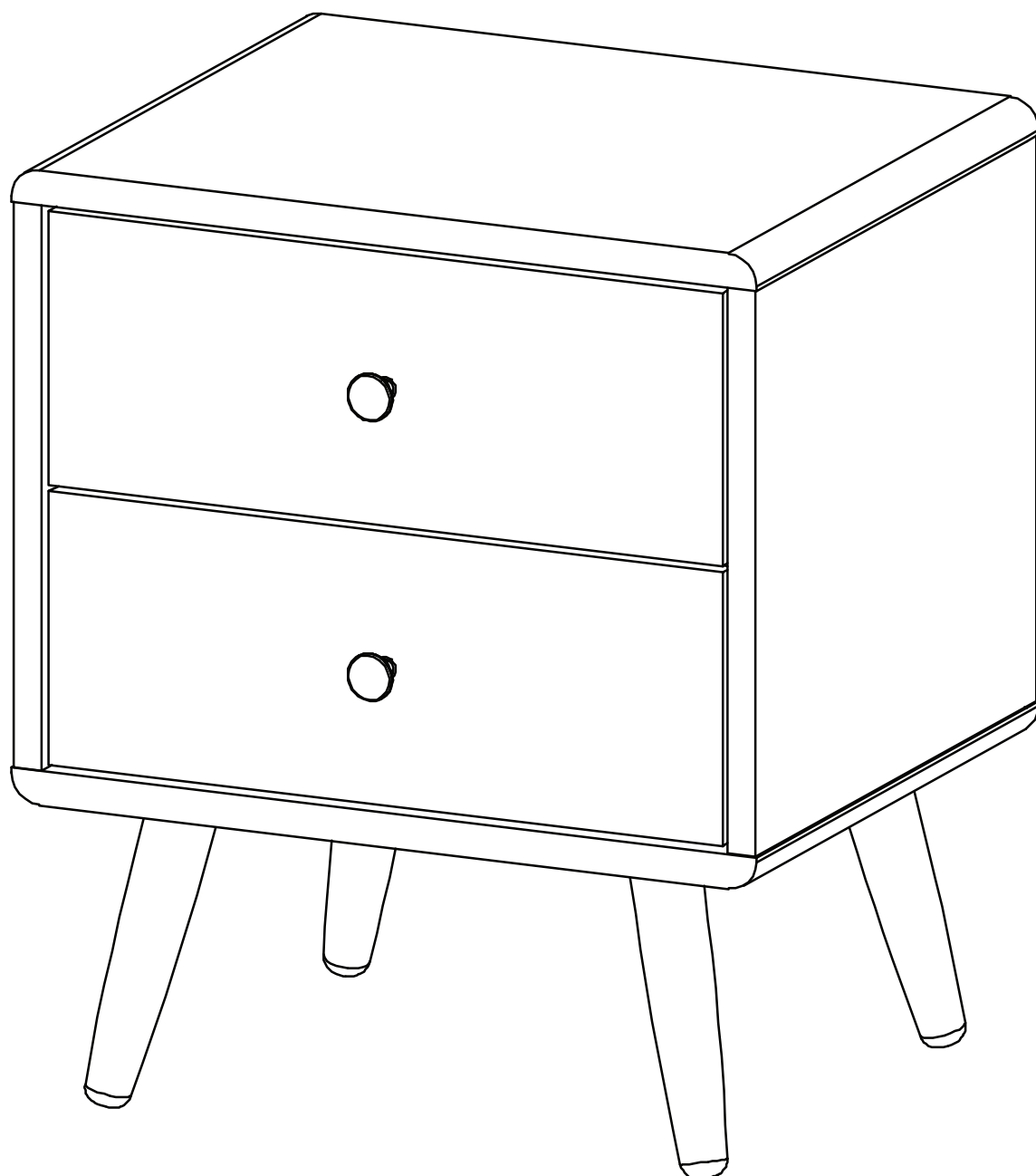

**Questions? Contact us!**

609.256.9000 • [cs@modway.com](mailto:cs@modway.com)  
[www.modway.com](http://www.modway.com)

**\*modway**



Read through all of the instructions before starting



Care instructions are listed in the last step of this manual



Approx. 60 minutes assembly time



Make sure you have all parts and components before discarding any packing materials



2 people recommended for assembly

**Only use hand tools to assemble this item.** Do not use power tools. Do not tighten bolts or screws completely until all hardware is lined up and inserted into the holes.

Do not over-tighten screws and bolts to avoid stripping the hardware or cracking the item.

Assemble your item on a flat, carpeted area, with plenty of space to work. This will prevent damage and scratches to your floors or the item while you're assembling the product.

Keep all components and packaging out of reach of children or animals to avoid risk of choking or suffocation.

## Furniture components:

1	Top Board	x1	LB18A	Leg	x4
2	Bottom Board	x1			
3	Side Board Left	x1			
4	Side Board Right	x1			
5	Front Drawer	x2			
6	Side Drawer Left	x2			
7	Side Drawer Right	x2			
8	Back Drawer	x2			
9	Bottom Drawer	x2			
10	Back Board	x1			

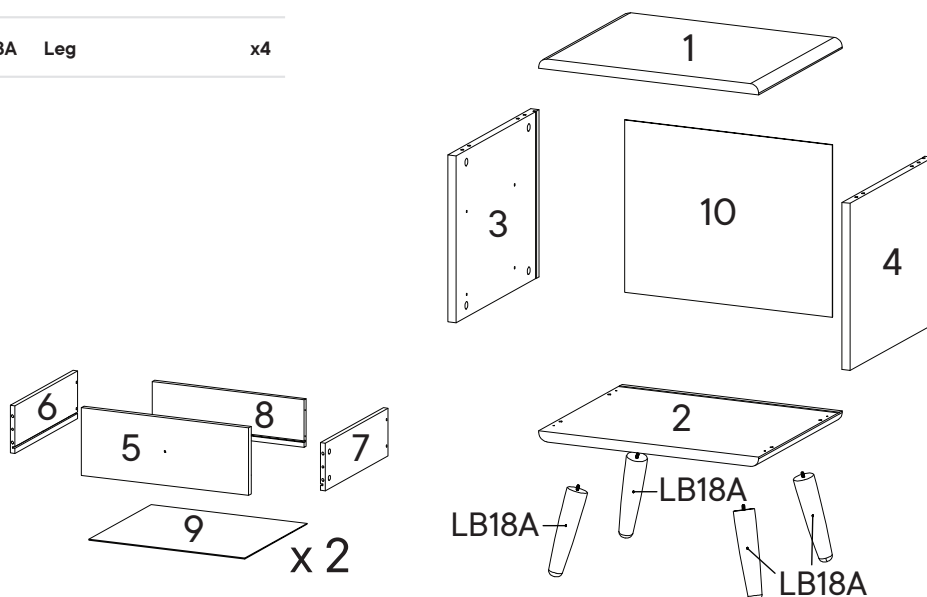

## Provided hardware:

A		Cam Bolt Ø6 x 35 mm	x16	J		Screw M 4.5 x 12.5 mm	x20
B		Cam Lock Ø15 mm	x8	K		Wedge	x12
C		Cam Lock Ø12 mm	x8	L		Screw M 3.5 x 15.5 mm	x12
D		Wood Dowel Ø8 x 30 mm	x8	M		Screw M 4 x 22 mm	x2
E		Wood Dowel Ø6 x 30 mm	x4	PM1		Mounting Plate	x4
F		Drawer Knob	x2	RM35A		Drawer Runner	x2
G		Screw M 6 x 10.5 mm	x8				
H		Screw M 3.5 x 13 mm	x12				
I		Screw M 8 x 39 mm	x8				

## What you need:

Phillips Head Screwdriver

**Missing parts or hardware? Need assistance?**  
Contact us before returning your item. We're here to help!  
609.256.9000 • cs@modway.com

# Step 1

## HARDWARE

- A** Cam Bolt Ø6 x 35 mm x8
- E** Wood Dowel Ø6 x 30 mm x4

## COMPONENTS

- 5** Front Drawer x2
- 6** Side Drawer Left x2
- 7** Side Drawer Right x2

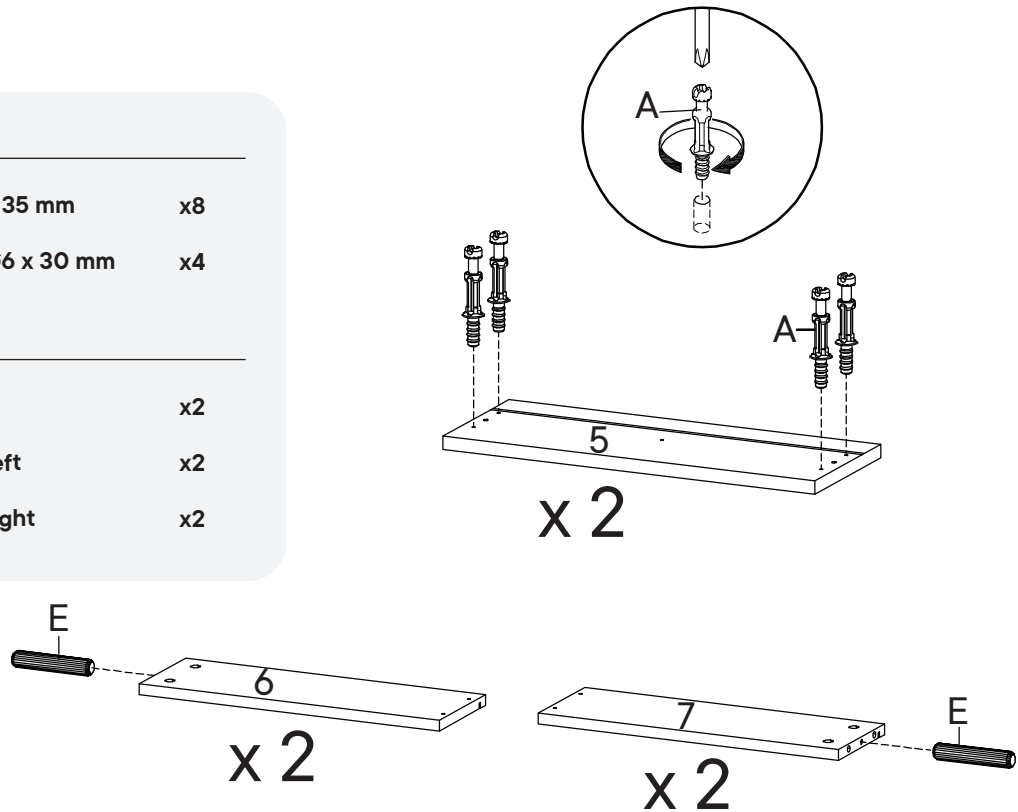

# Step 2

## HARDWARE

- C** Cam Lock Ø12 mm x8
- I** Screw M 8 x 39 mm x8

## COMPONENTS

- 5** Front Drawer x2
- 6** Side Drawer Left x2
- 7** Side Drawer Right x2
- 8** Back Drawer x2
- 9** Bottom Drawer x2

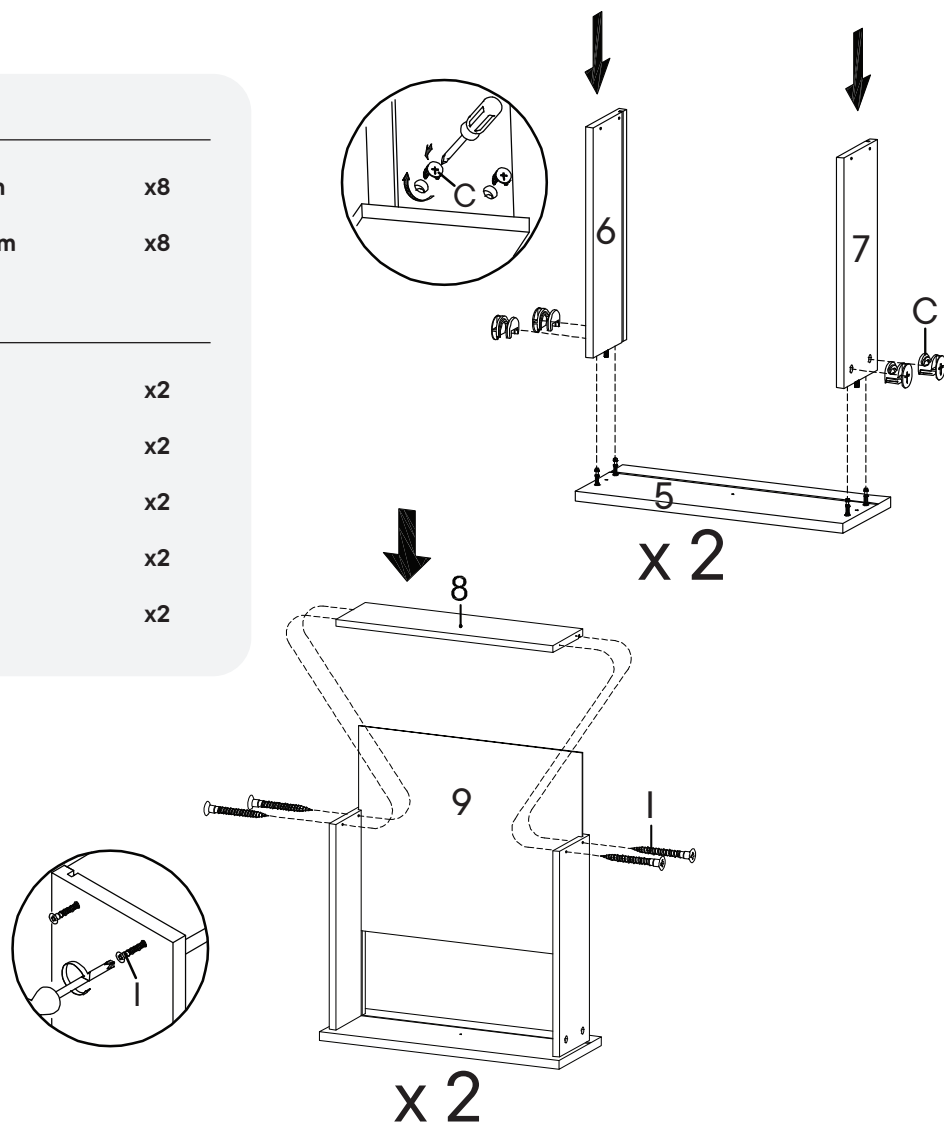

## Step 3

### HARDWARE

<b>F</b>	Drawer Knob	x2
<b>H</b>	Screw M 3.5 x 13 mm	x12
<b>M</b>	Screw M 4 x 22 mm	x2
<b>RM35A</b>	Drawer Runner	x2

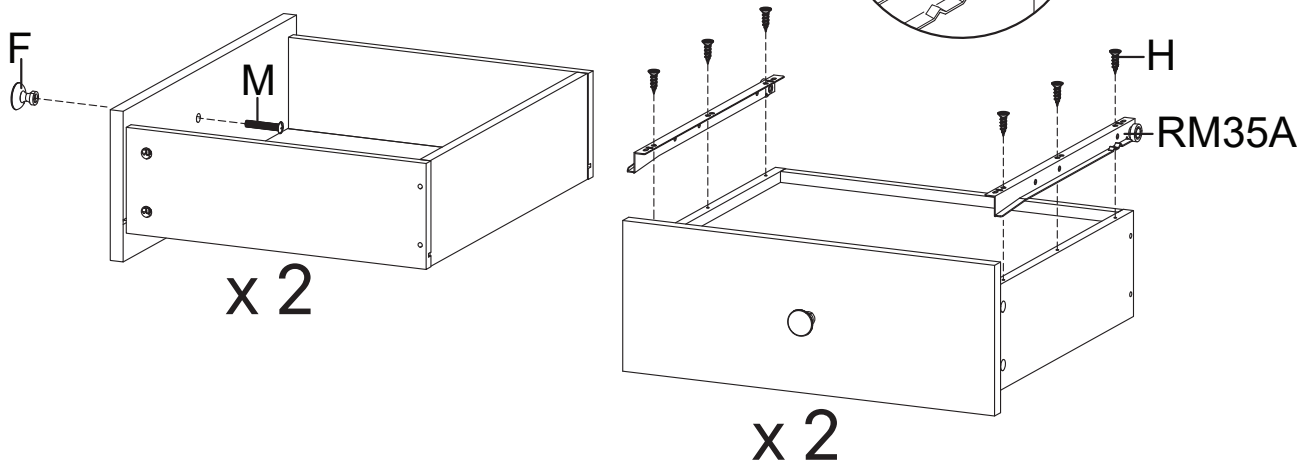

## Step 4

### HARDWARE

<b>K</b>	Wedge	x8
<b>L</b>	Screw M 3.5 x 15.5 mm	x8

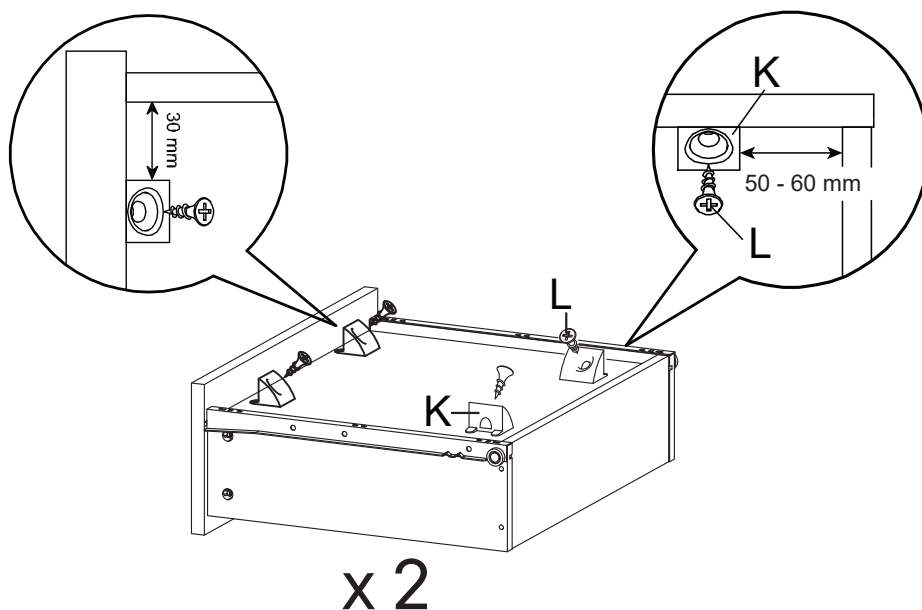

## Step 5

### HARDWARE

- A** Cam Bolt Ø6 x 35 mm x8

### COMPONENTS

- 1** Top Board x1  
**2** Bottom Board x1

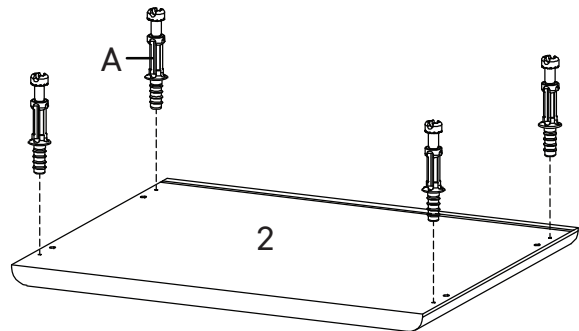
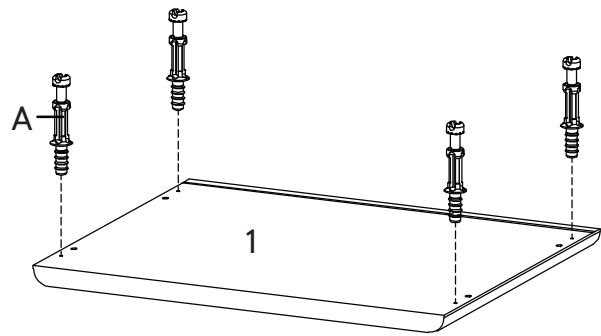
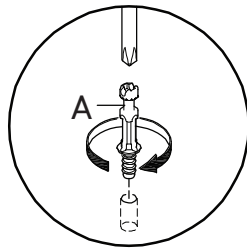

## Step 6

### HARDWARE

- D** Wood Dowel Ø8 x 30 mm x8

- G** Screw M 6 x 10.5 mm x8

- RM35A** Drawer Runner x2

### COMPONENTS

- 3** Side Board Left x1

- 4** Side Board Right x1

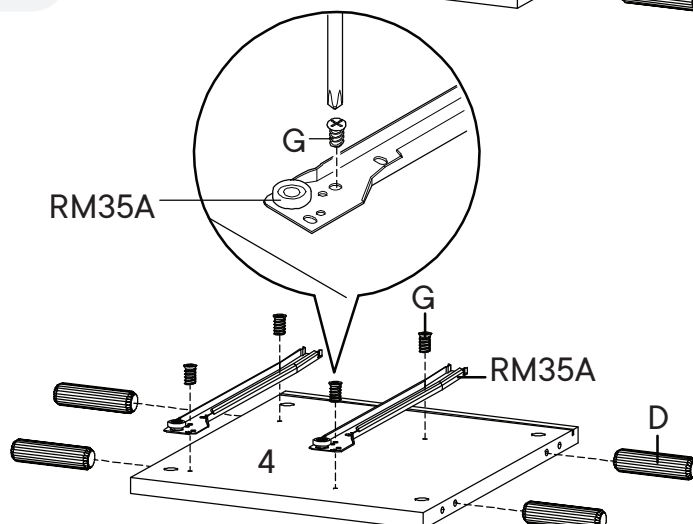
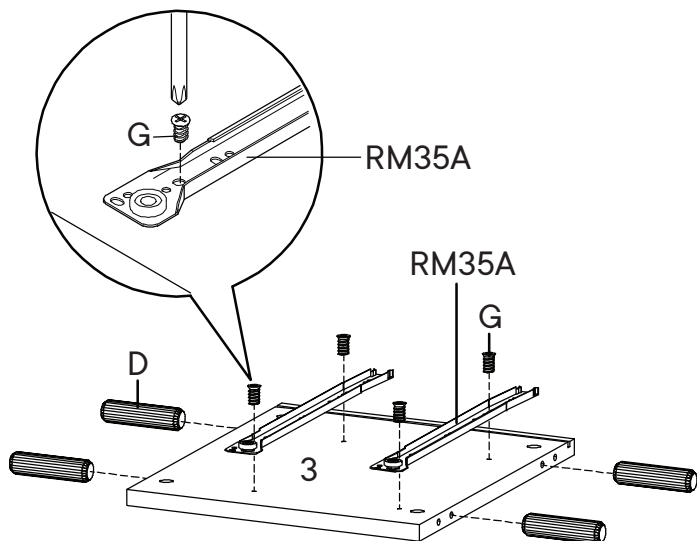

## Step 7

### HARDWARE

- B** Cam Lock Ø15 mm x4

### COMPONENTS

- 1** Top Board x1  
**3** Side Board Left x1  
**4** Side Board Right x1

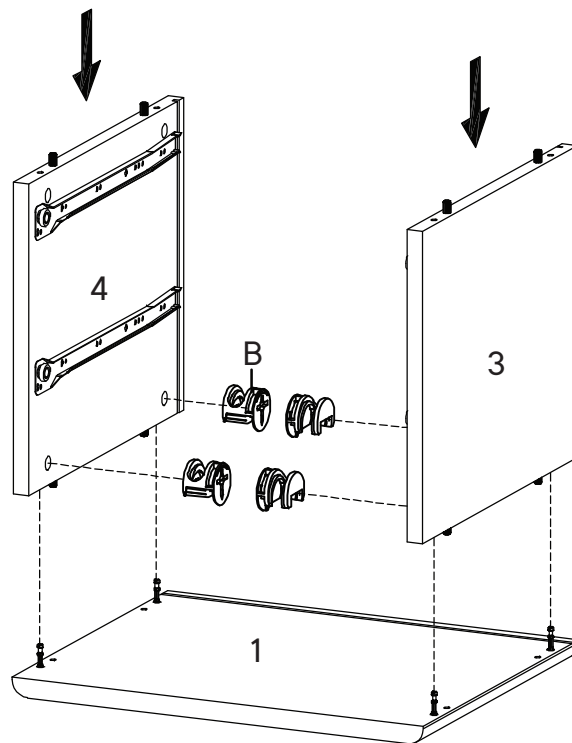
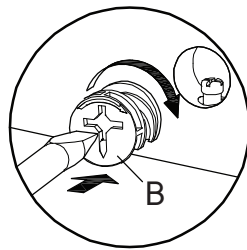

## Step 8

### HARDWARE

- B** Cam Lock Ø15 mm x4

### COMPONENTS

- 2** Bottom Board x1  
**10** Back Board x1

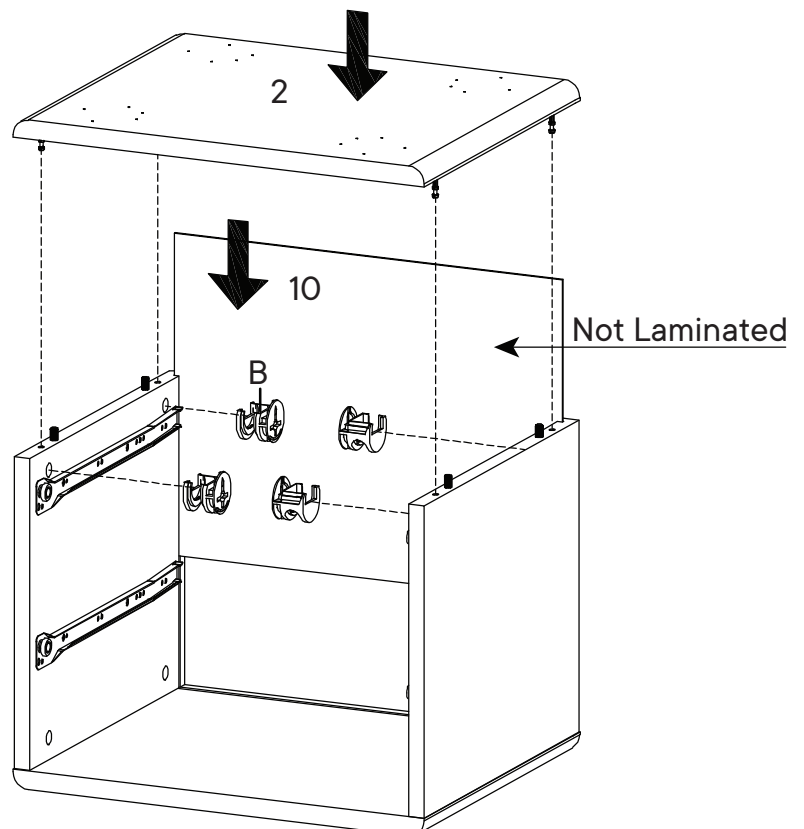
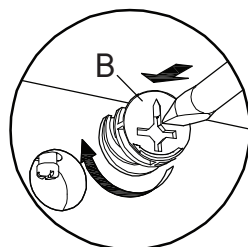

## Step 9

### HARDWARE

**J** Screw M 4.5 x 12.5 mm x20

**PM1** Mounting Plate x4

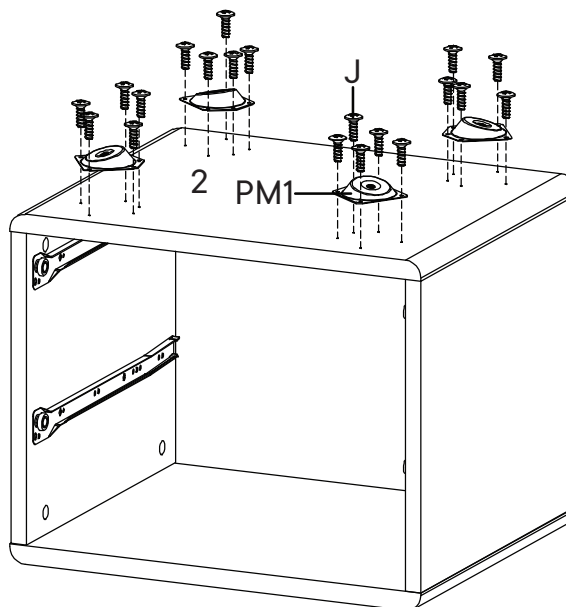
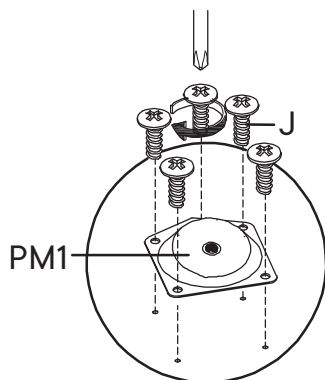

## Step 10

### COMPONENTS

**LB18A** Leg x4

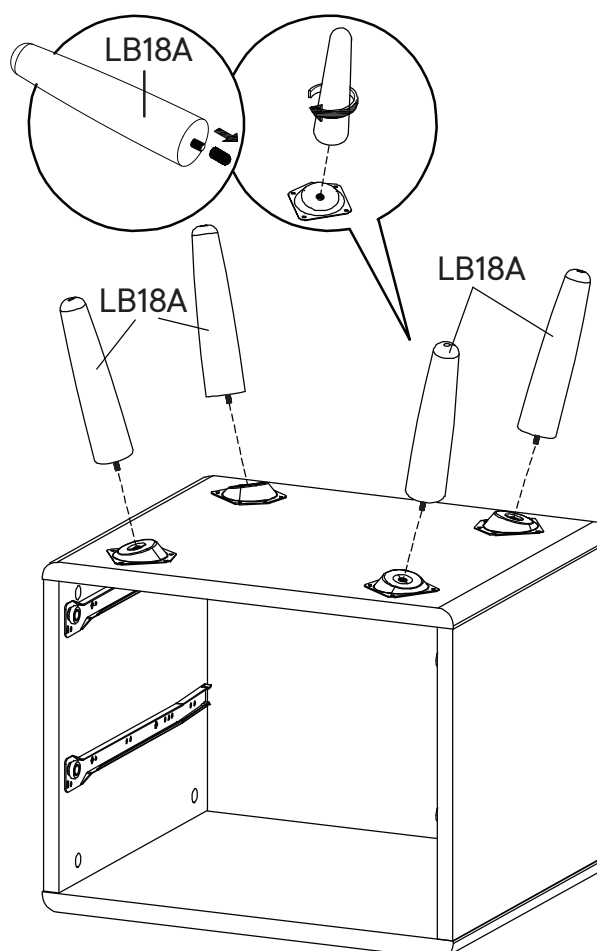

## Step 11

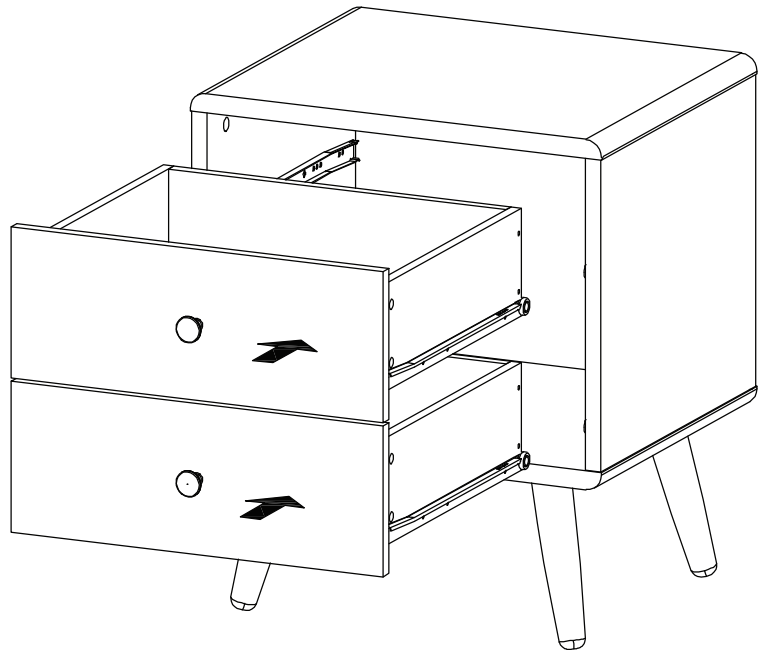
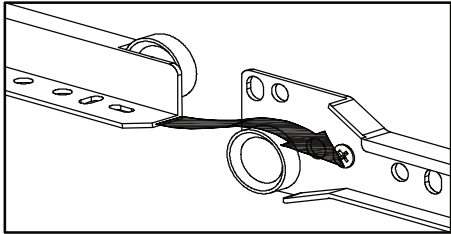

## Step 12

### HARDWARE

- K** Wedge x4
- L** Screw M 3.5 x 15.5 mm x4

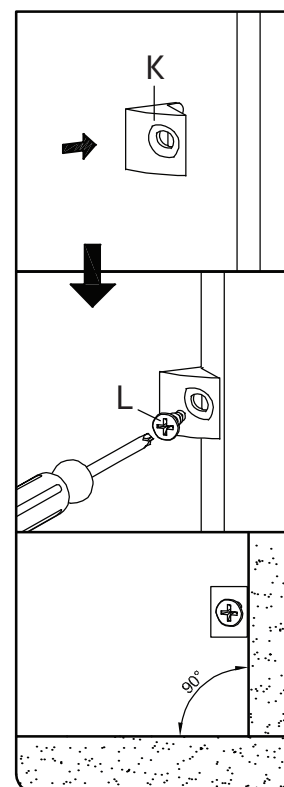
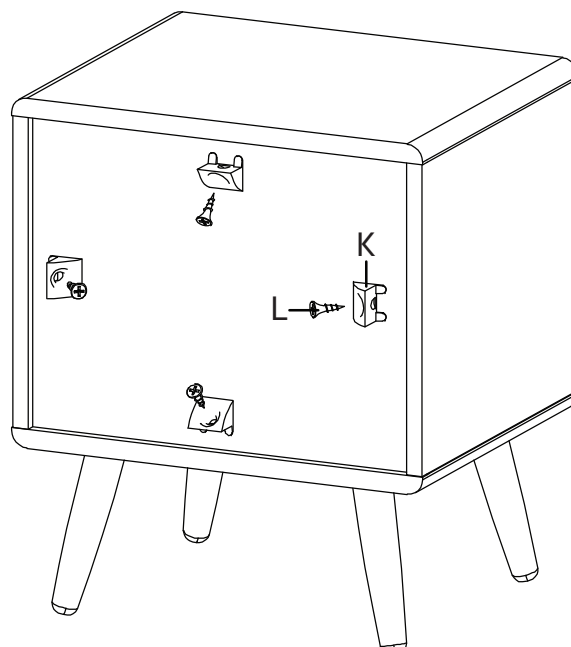



# Great job!

Nightstand assembly is complete.



## CARING FOR YOUR ITEM

Indoor use only.

Not contract grade.

Clean using a non-abrasive cloth and a mild cleaner.

Never use harsh chemicals, as they could damage the finish or integrity of the item.

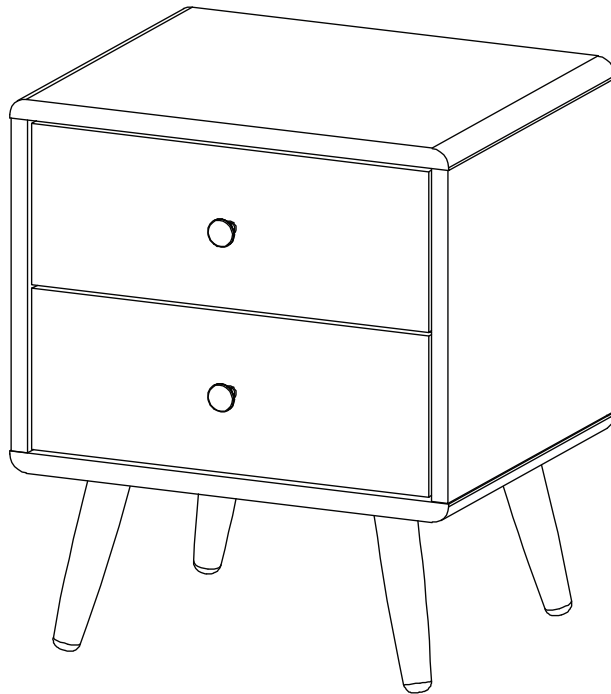

## CONNECT WITH US!



Tag us **@modway\_furniture** and **#modway** for a chance to be featured.