

ASSEMBLY INSTRUCTIONS

EEI-6531

V1.07.17.23

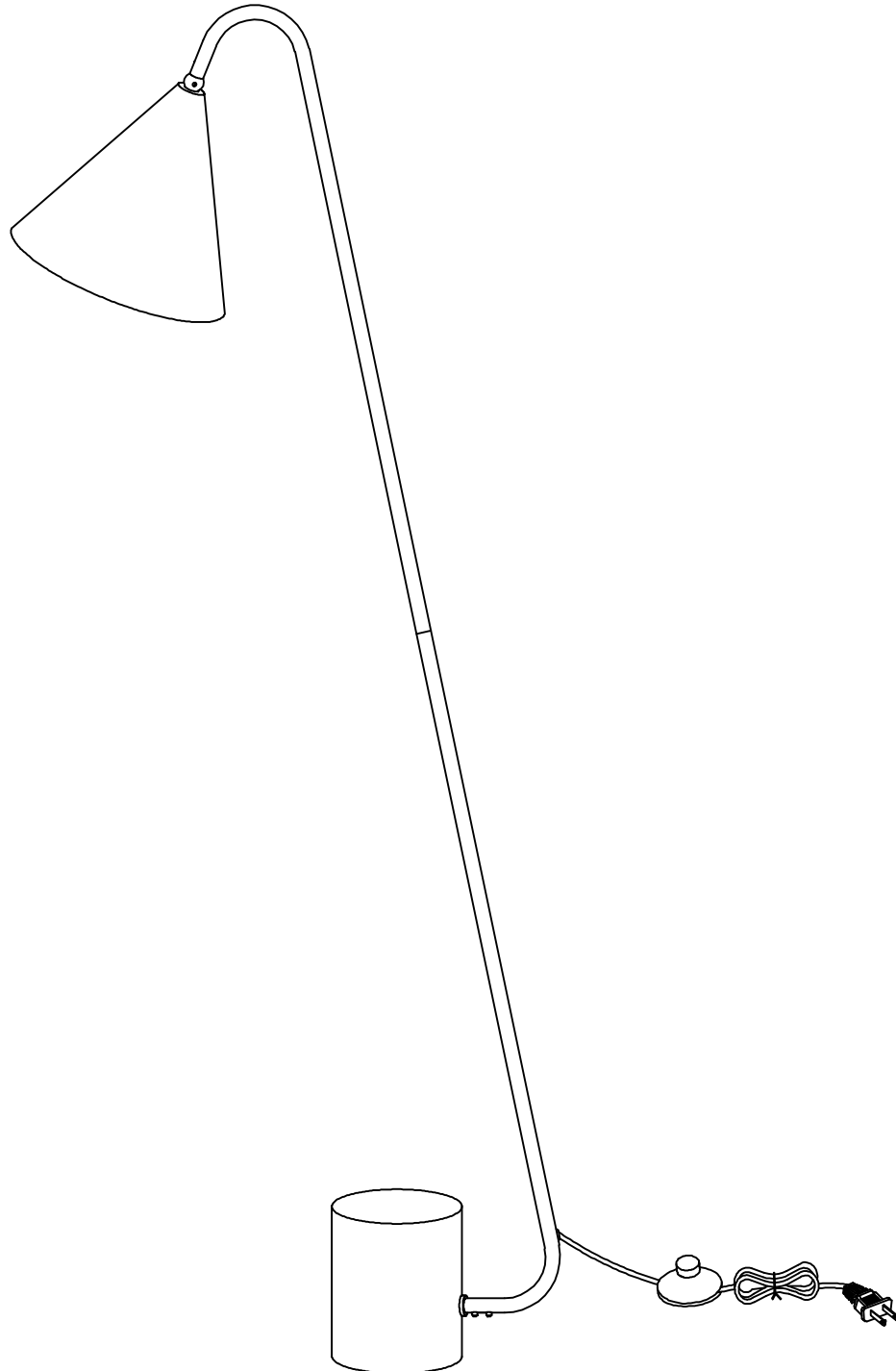

Questions? Contact us!

609.256.9000 • cs@modway.com
www.modway.com

*modway

Let's get started!



Read through all of the instructions before starting



Make sure you have all parts and components before discarding any packing materials



For hardwiring installation, we suggest hiring a professional electrician.

Do not over-tighten screws and bolts to avoid stripping the hardware or cracking the item.

Keep all components and packaging out of reach of children or animals to avoid risk of choking or suffocation.

Check all parts and hardware for damage. If the product is damaged, it should not be used.

Assemble your item on a flat, carpeted area, with plenty of space to work. This will prevent damage and scratches to your floors or the item while you're assembling the product.

Installation and electrical connections must follow local and National Electric Code standards.

Ensure the main power supply is OFF before starting work to prevent electrical shock.

Allow the fixture to cool before changing the bulb. Fixture may get hot when in use.

We recommend LED bulbs. LEDs are better for energy consumption and can prolong the life of the fixture.

Provided hardware:

A		Inner Hexagon Screw +1 Spare Included	x3
B		2mm Allen Key	x1
C		2.5MM Allen Key	x1
D		Short Screw	x2
E		Short Screw	x1

What you need:



Phillips

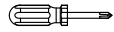

Phillips Head Screwdriver

You may also need:

+ One (1) E26 (medium-base) Light Bulb (MAX. 40W)

Wait!

Missing parts or hardware? Need assistance?
Contact us before returning your item. We're here to help!
609.256.9000 • cs@modway.com

Step 1

HARDWARE

- A** Inner Hexagon Screw x1
- B** 2mm Allen Key x1

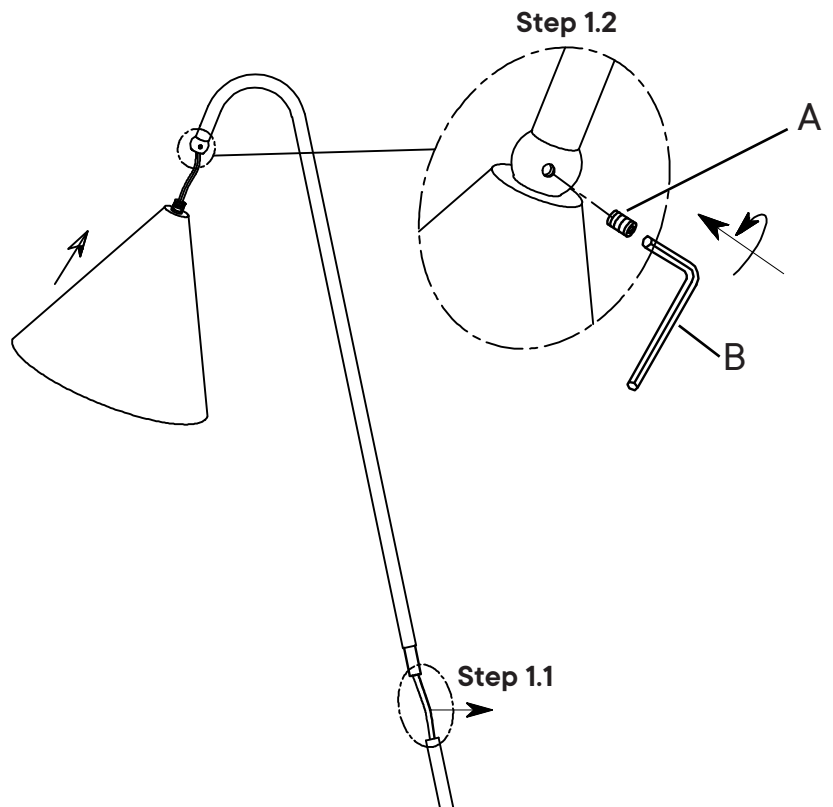

Step 1.1 Pulling out the power cable.

Step 1.2 Use the **2mm Allen Key (B)** to unscrew the **Inner Hexagon Screw (A)**, then attach the lamp shade onto round part of metal tube and tighten the **Inner Hexagon Screw (A)**.

Step 2

HARDWARE

- A** Inner Hexagon Screw x2

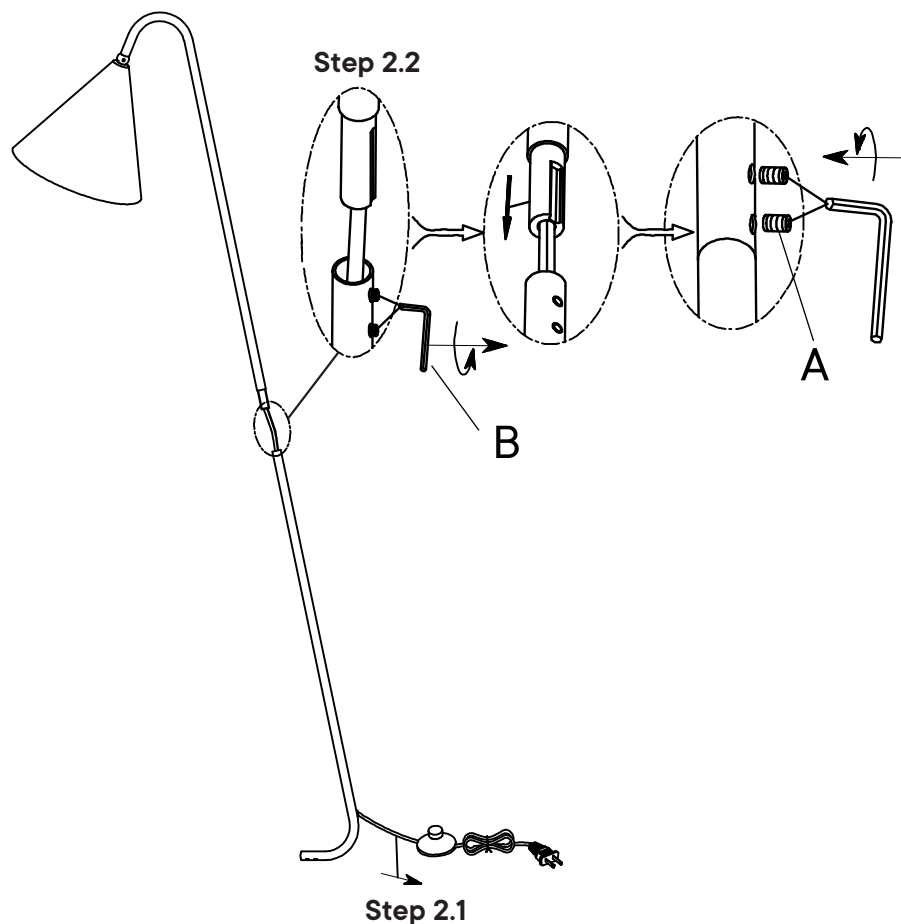

Step 2.1 Pulling out the power cable.

Step 2.2 Use the **2mm Allen Key (B)** to unscrew the **Inner Hexagon Screws (A)**, then insert the upper metal tube into the lower metal tube and tighten the **Inner Hexagon Screw (A)**.

Step 3

HARDWARE

C	2.5MM Allen Key	x1
D	Short Screw	x2
E	Short Screw	x1

Step 3.1 Use the **2.5MM Allen Key (C)** unscrew the **Short Screws (D)**, **Short Screws (E)**. insert the metal tube to the base and tighten **Short Screws (D)**, **Short Screws (E)**.

Step 3.2 Install light bulb according to the wattage label (E26, MAX. 40W, bulbs not included).

ATTENTION: To avoid the risk of fire, do not exceed the recommended wattage indicated on the wattage label.

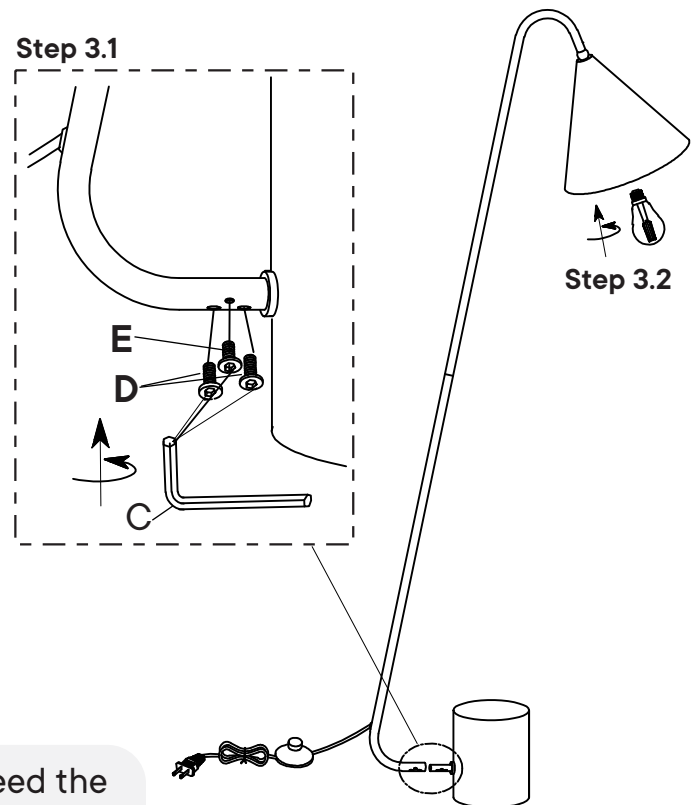

Great job!

Your lamp is complete and ready to enjoy.

♥ CARING FOR YOUR ITEM

Indoor use only.

Not contract grade.

Clean using a non-abrasive cloth and a mild cleaner.

Never use harsh chemicals, as they could damage the finish or integrity of the item.

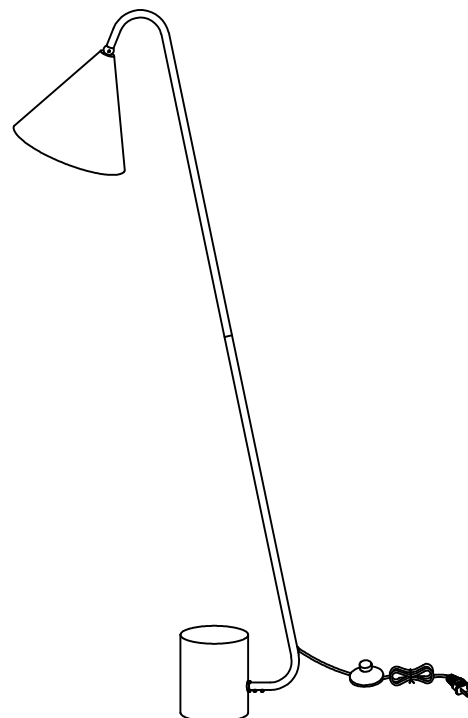

CONNECT WITH US!   

Tag us @modway_furniture and #modway for a chance to be featured.