

ASSEMBLY INSTRUCTIONS

EEI-6040

V0.03.14.22

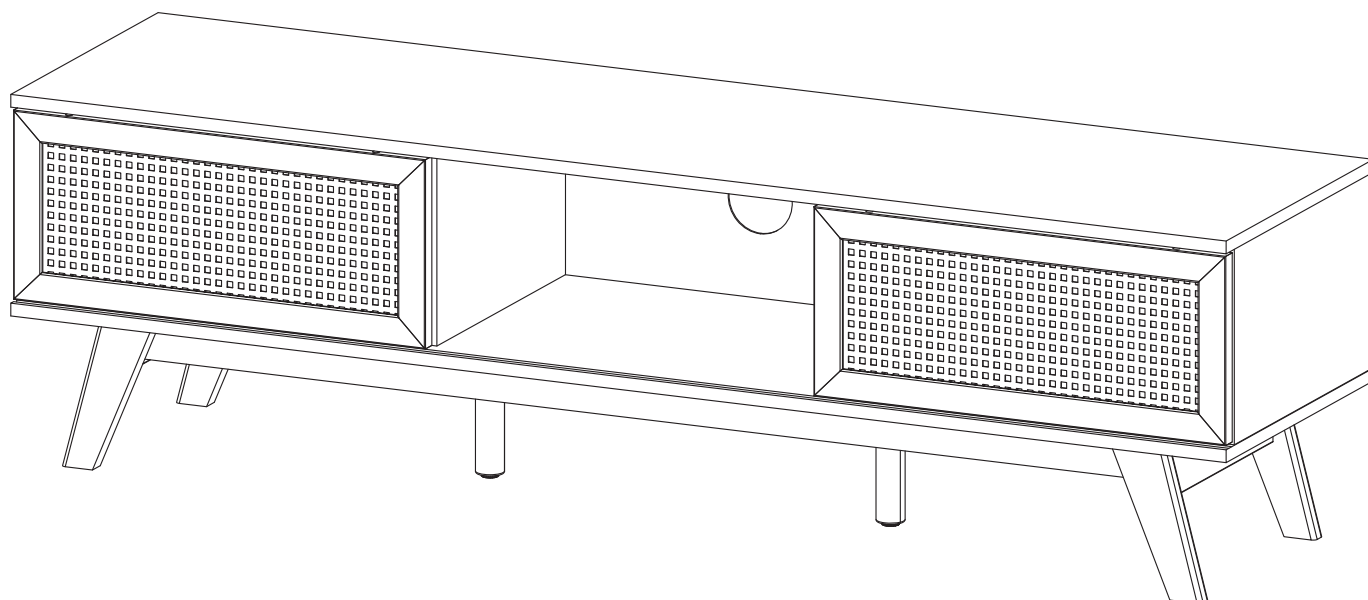

Questions? Contact us!

609.256.9000 • cs@modway.com
www.modway.com

*modway

For use with televisions
weighing a maximum of 135 lb / 61.4 kg or less,
with a maximum width of 50 inches / 127.0 cm.

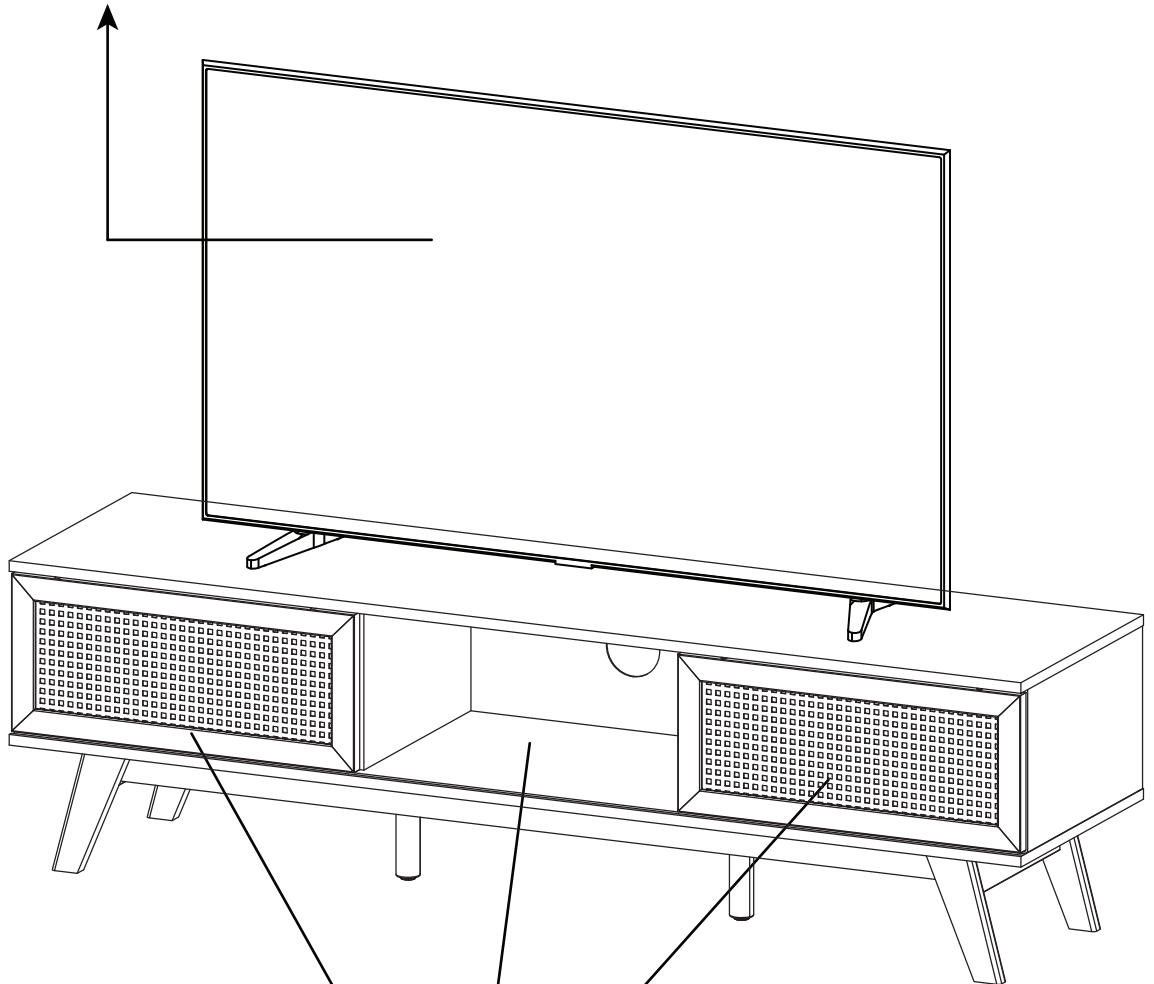

22 lb / 9.9 kg weight limit per shelf



Read through all of the instructions before starting



Care instructions are listed in the last step of this manual



Approx. 60 minutes assembly time



Make sure you have all parts and components before discarding any packing materials



2 people recommended for assembly

Only use hand tools to assemble this item. Do not use power tools. Do not tighten bolts or screws completely until all hardware is lined up and inserted into the holes.

Do not over-tighten screws and bolts to avoid stripping the hardware or cracking the item.

Assemble your item on a flat, carpeted area, with plenty of space to work. This will prevent damage and scratches to your floors or the item while you're assembling the product.

Keep all components and packaging out of reach of children or animals to avoid risk of choking or suffocation.

Furniture components:

1	Top Board	x1	11	Back Board	x3
2	Bottom Board	x1	LC16A1	Center Leg	x2
3	Side Board Left	x1			
4	Side Board Right	x1			
5	Center Board	x2			
6	Bottom Skirt 1	x2			
7	Bottom Skirt 2	x2			
8	Leg 1	x2			
9	Leg 2	x2			
10	Frame Door	x2			

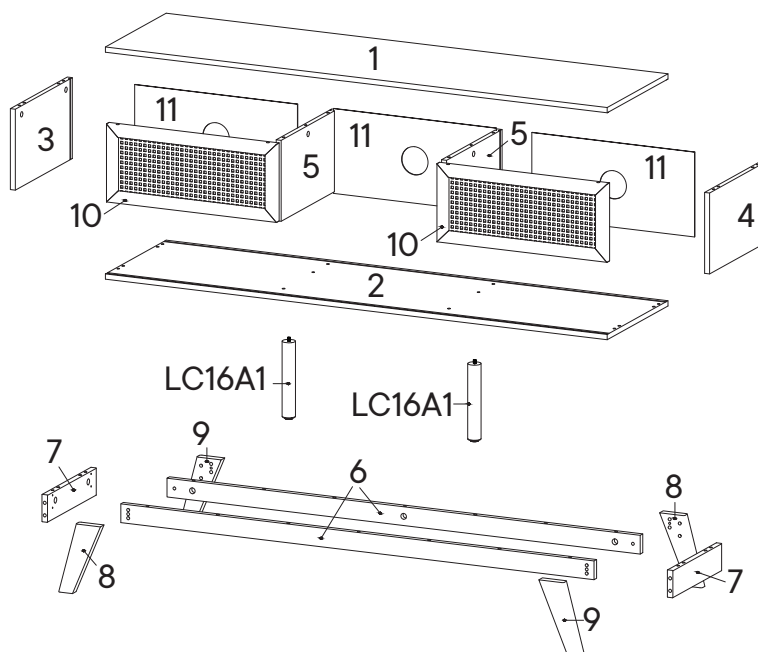

Provided hardware:

A		Cam Bolt Ø6 x 35 mm	x16	J		Screw M 4.5 x 12.5 mm	x16
B		Cam Lock Ø15 mm	x16	K		Pin Sliding Top	x4
C		Wood Dowel Ø8 x 30 mm	x44	L		Pin Sliding Bottom	x4
D		Allen Key	x1	M		Silicon Bumper	x1
E		Screw M 7 x 50 mm	x6	N		Wedge	x12
F		Screw Cap Ø15 mm	x6	O		Screw M 3.5 x 15.5 mm	x12
G		Stopper	x2	P		Floor Protector	x4
H		Bracket	x4	PM2		Mounting Plate	x2
I		Screw M 6.4 x 35 mm	x4				

What you need:



Wait!

Missing parts or hardware? Need assistance?
Contact us before returning your item. We're here to help!
609.256.9000 • cs@modway.com

Step 1

HARDWARE

- A** Cam Bolt Ø6 x 35 mm x6
- C** Wood Dowel Ø8 x 30 mm x16

COMPONENTS

- 1** Top Board x1
- 3** Side Board Left x1
- 4** Side Board Right x1
- 5** Center Board x2

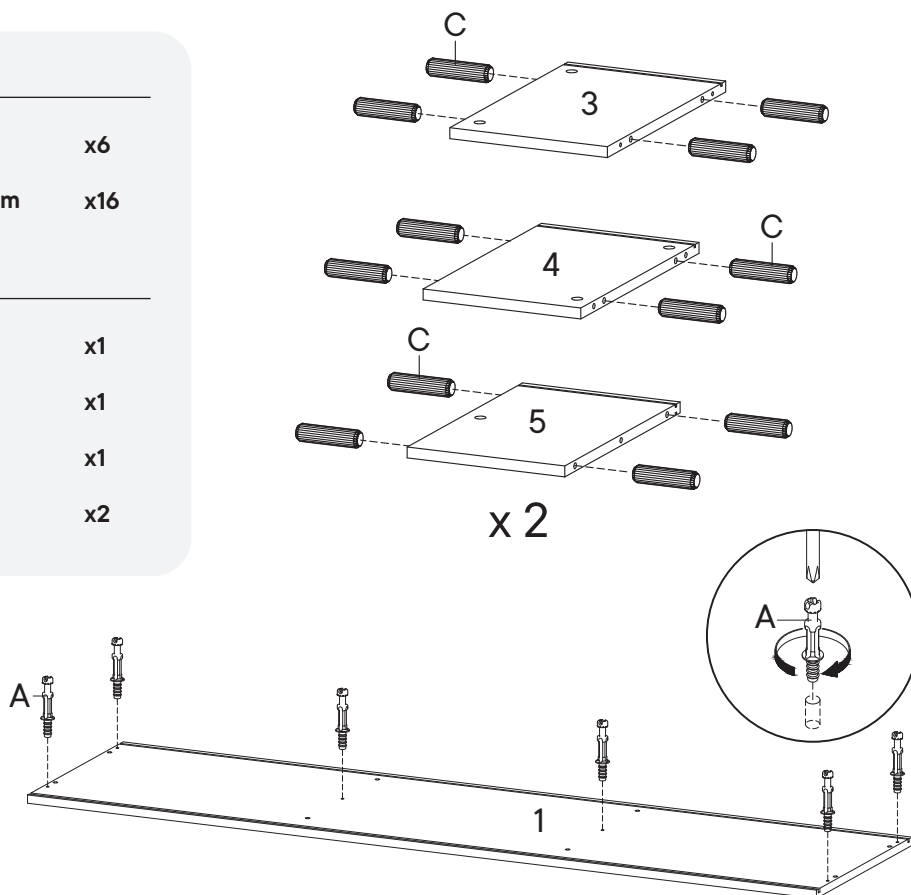

Step 2

HARDWARE

- B** Cam Lock Ø15 mm x6
- F** Screw Cap Ø15 mm x6

COMPONENTS

- 1** Top Board x1
- 3** Side Board Left x1
- 4** Side Board Right x1
- 5** Center Board x2

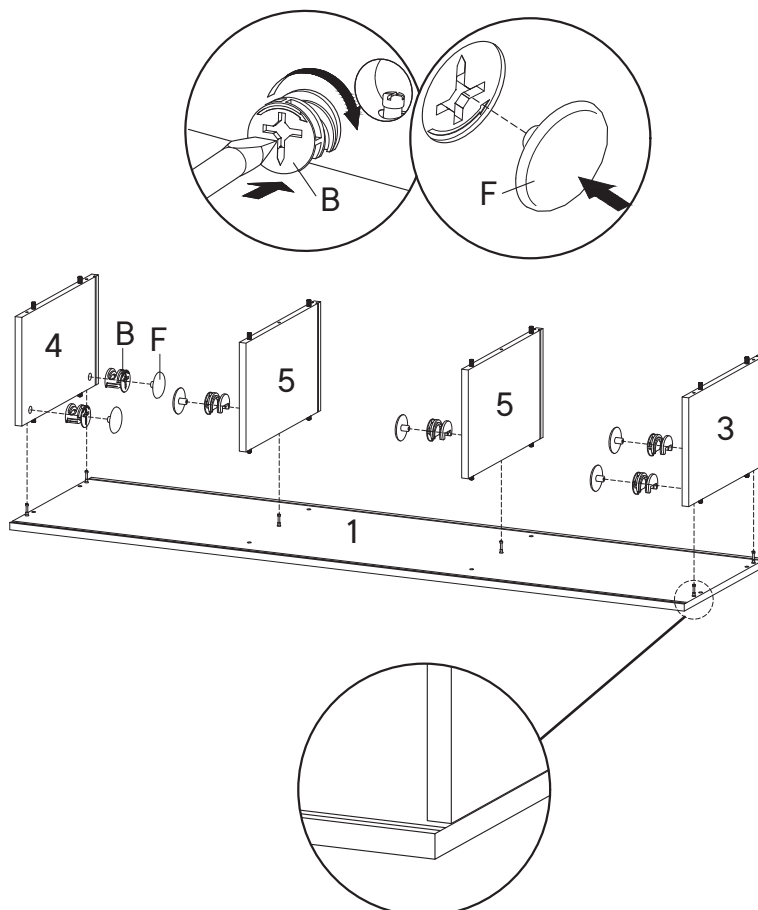

Step 3

HARDWARE

- D** Allen Key x1
- E** Screw M 7 x 50 mm x6

COMPONENTS

- 2** Bottom Board x1
- 11** Back Board x3

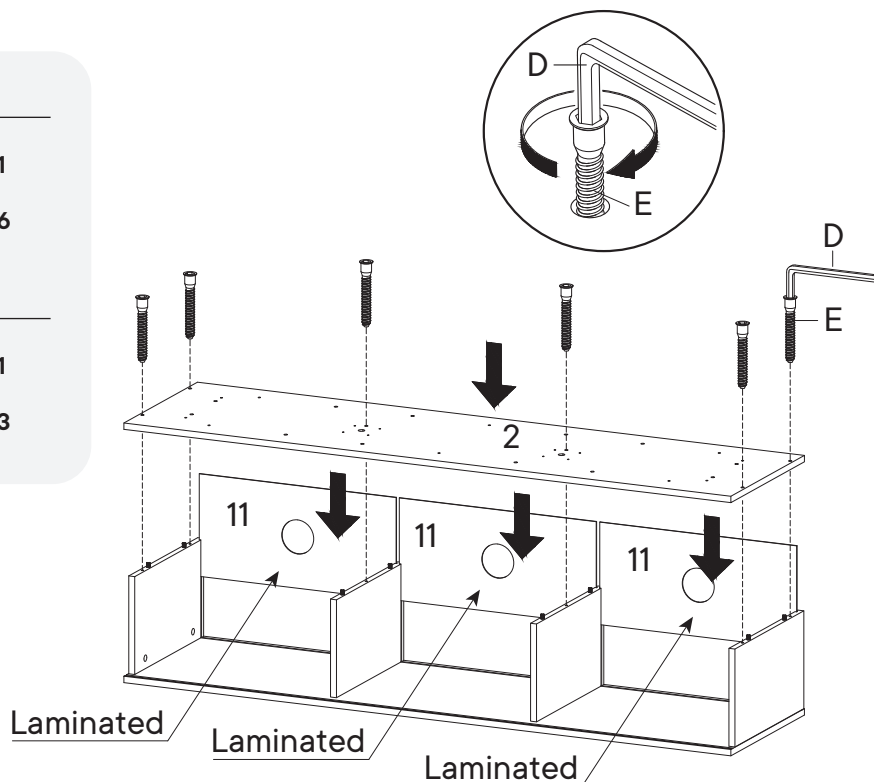

Step 4

HARDWARE

- A** Cam Bolt $\varnothing 6 \times 35$ mm x10
- J** Screw M 4.5 x 12.5 mm x8
- PM2** Mounting Plate x2

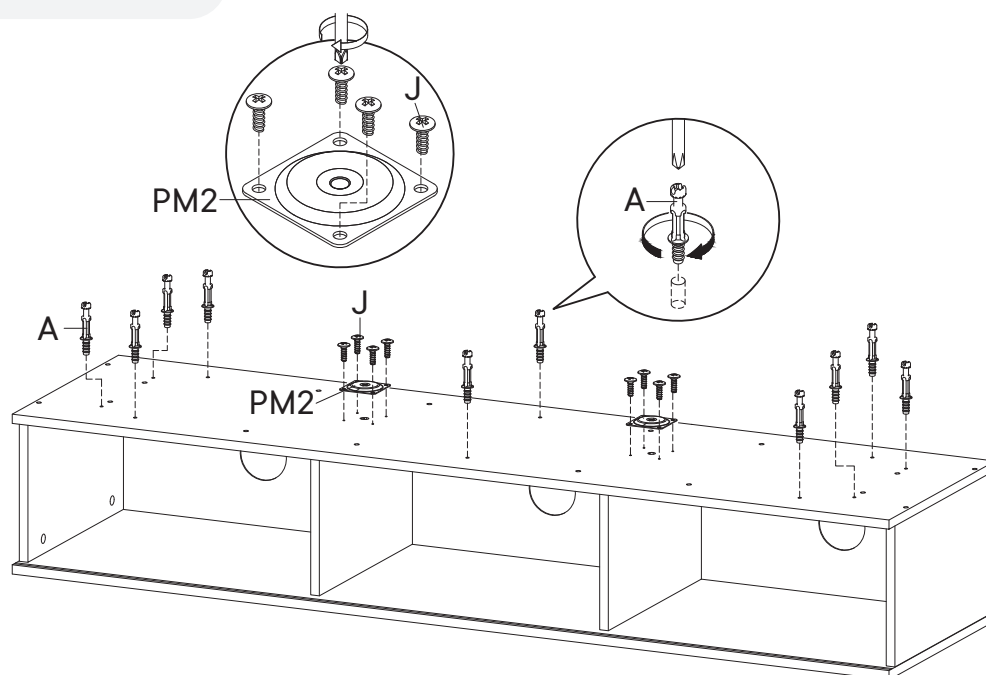

Step 5

HARDWARE

- C** Wood Dowel Ø8 x 30 mm x16
- P** Floor Protector x4

COMPONENTS

- 8** Leg 1 x2
- 9** Leg 2 x2

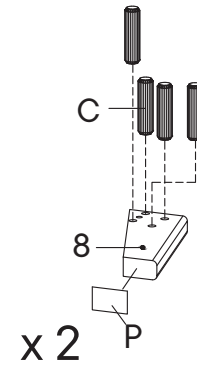
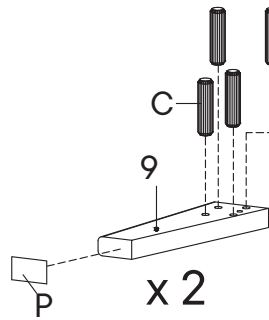
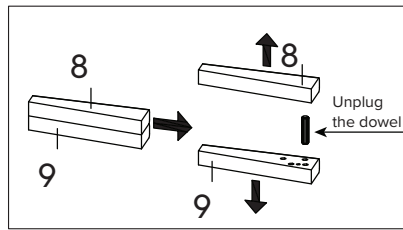

Step 6

HARDWARE

- H** Bracket x4
- J** Screw M 4.5 x 12.5 mm x8

COMPONENTS

- 7** Bottom Skirt 2 x2

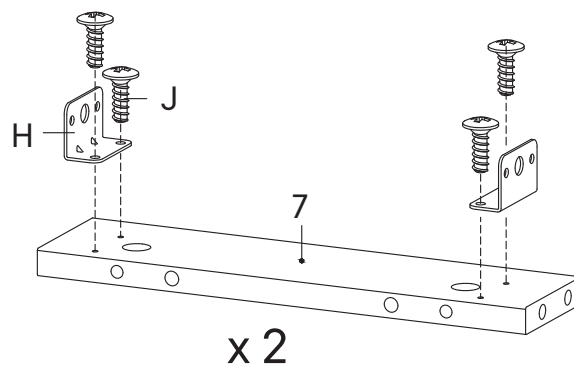
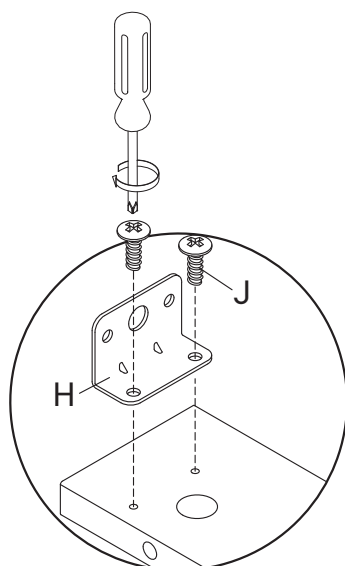

Step 7

COMPONENTS

- 6 Bottom Skirt 1 x2
- 7 Bottom Skirt 2 x2

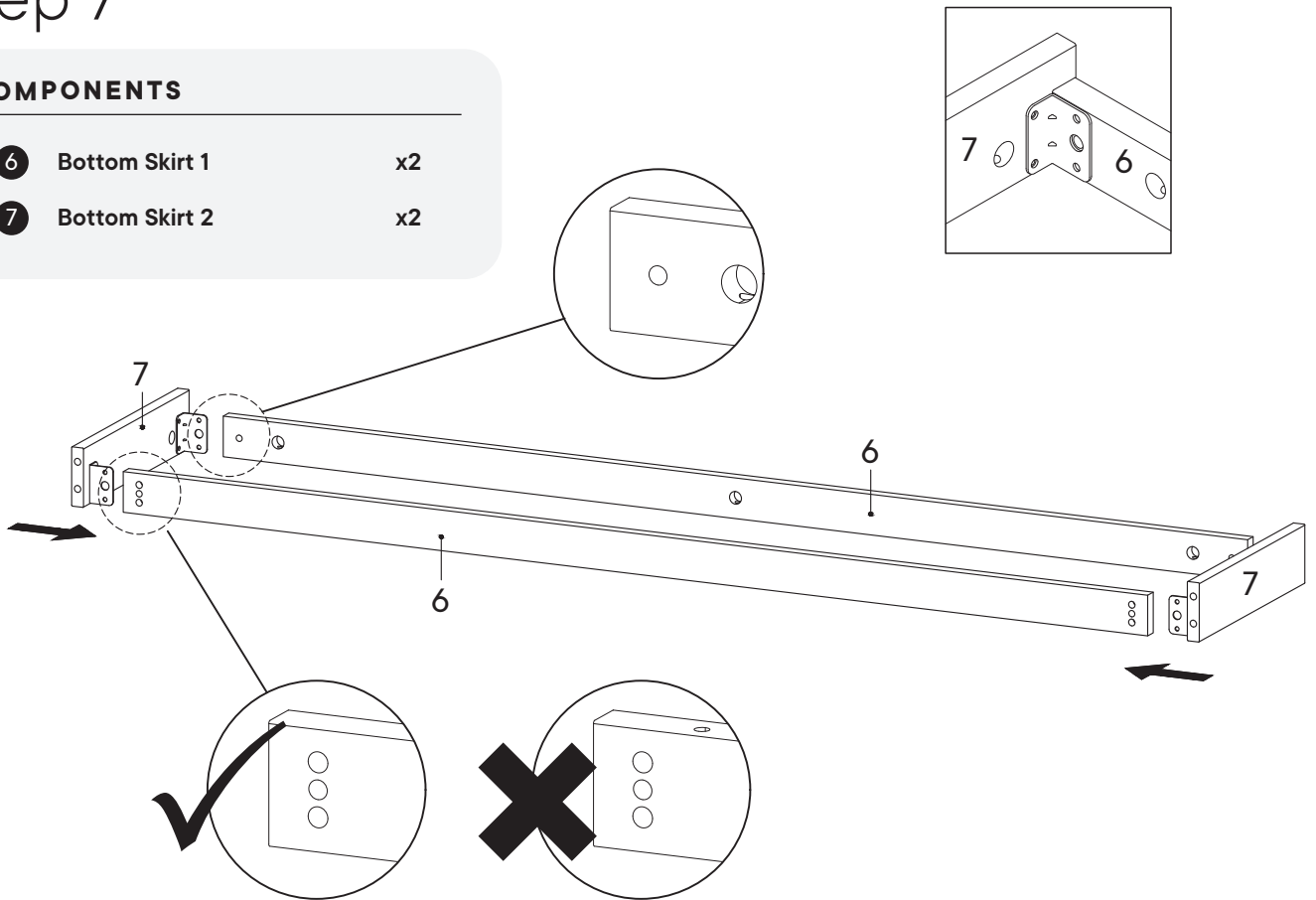

Step 8

COMPONENTS

- 8 Leg 1 x2
- 9 Leg 2 x2

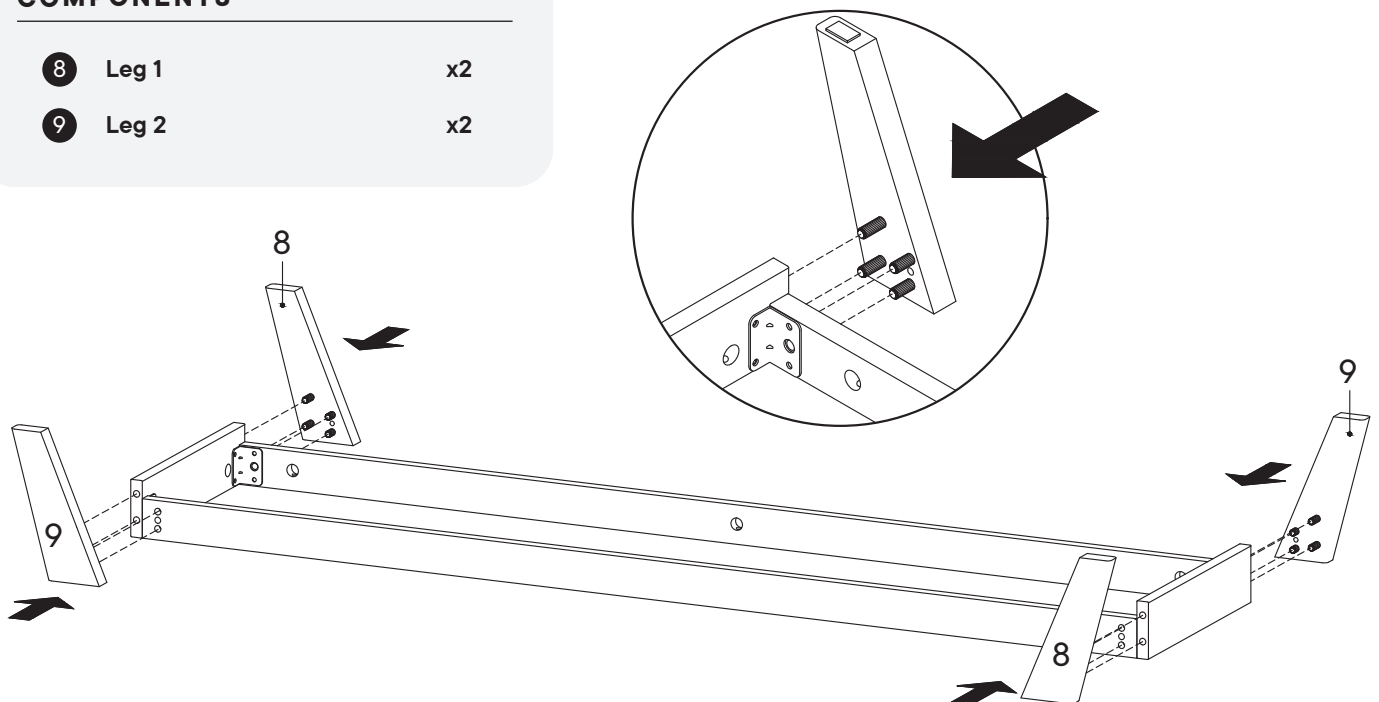

Step 9

HARDWARE

C Wood Dowel $\varnothing 8 \times 30$ mm x12

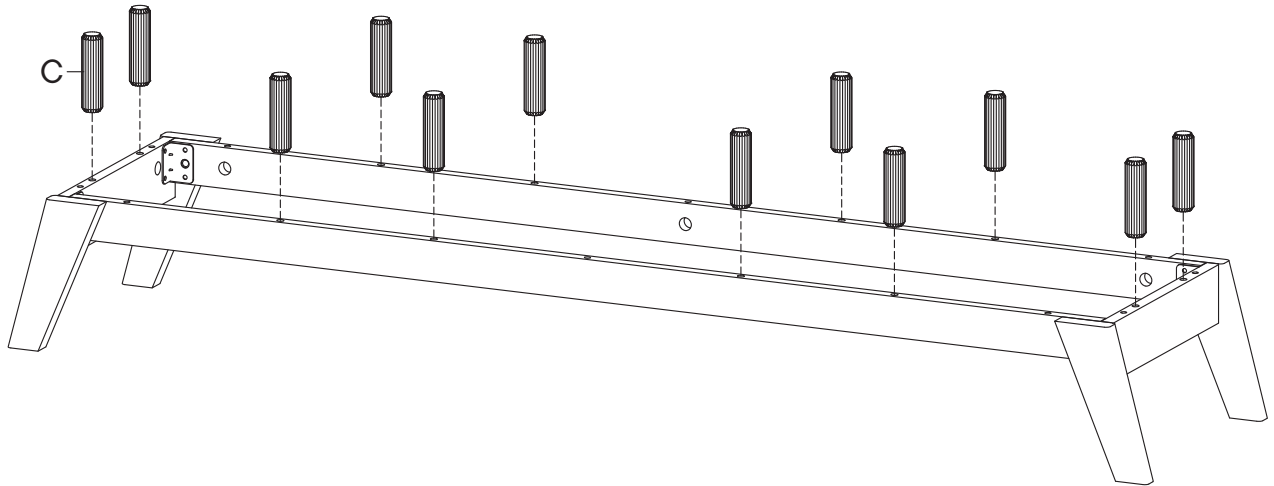

Step 10

HARDWARE

B Cam Lock $\varnothing 15$ mm x10

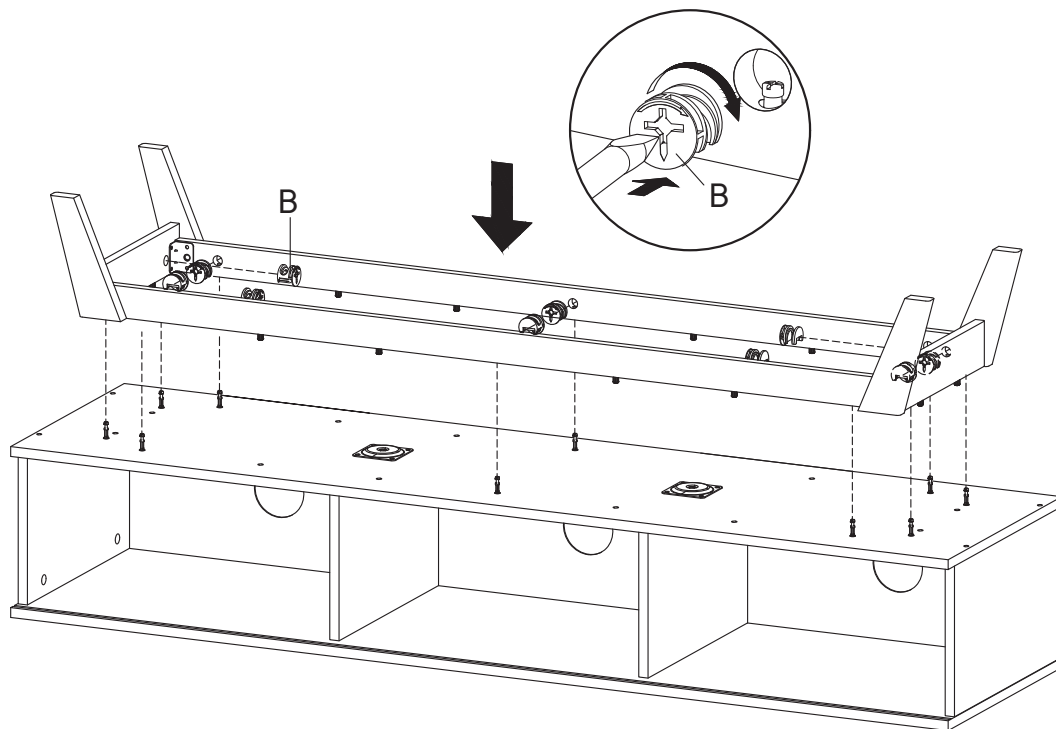

Step 11

HARDWARE

- D** Allen Key x1
- I** Screw M 6.4 x 35 mm x4

COMPONENTS

- LC16A1** Center Leg x2

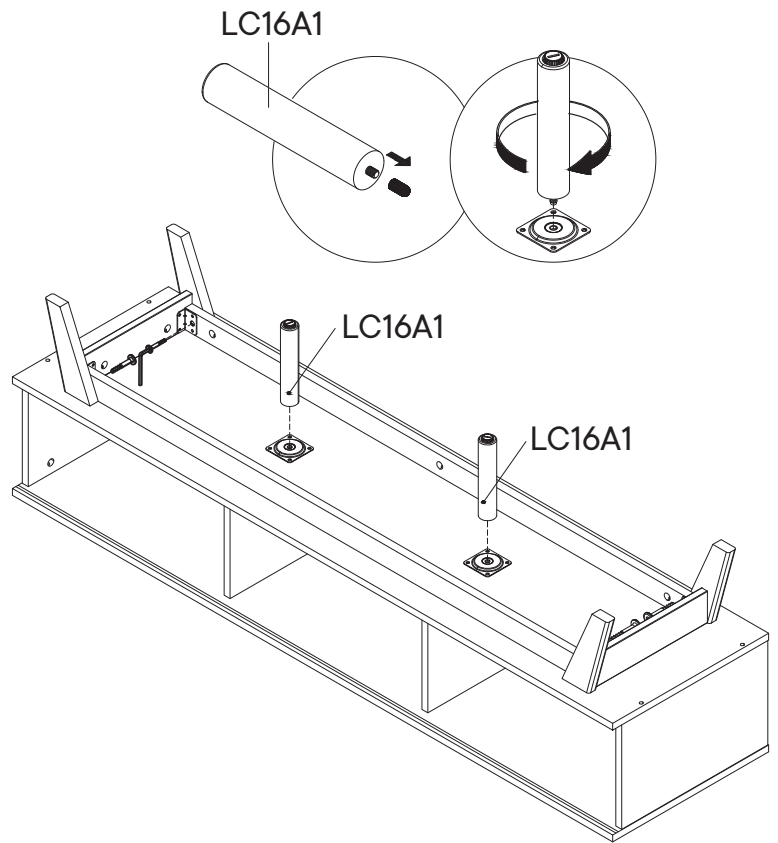
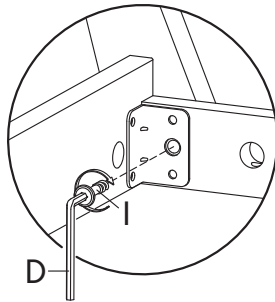

Step 12

HARDWARE

- G** Stopper x2
- K** Pin Sliding Top x4
- L** Pin Sliding Bottom x4

COMPONENT

- 10** Frame Door x2

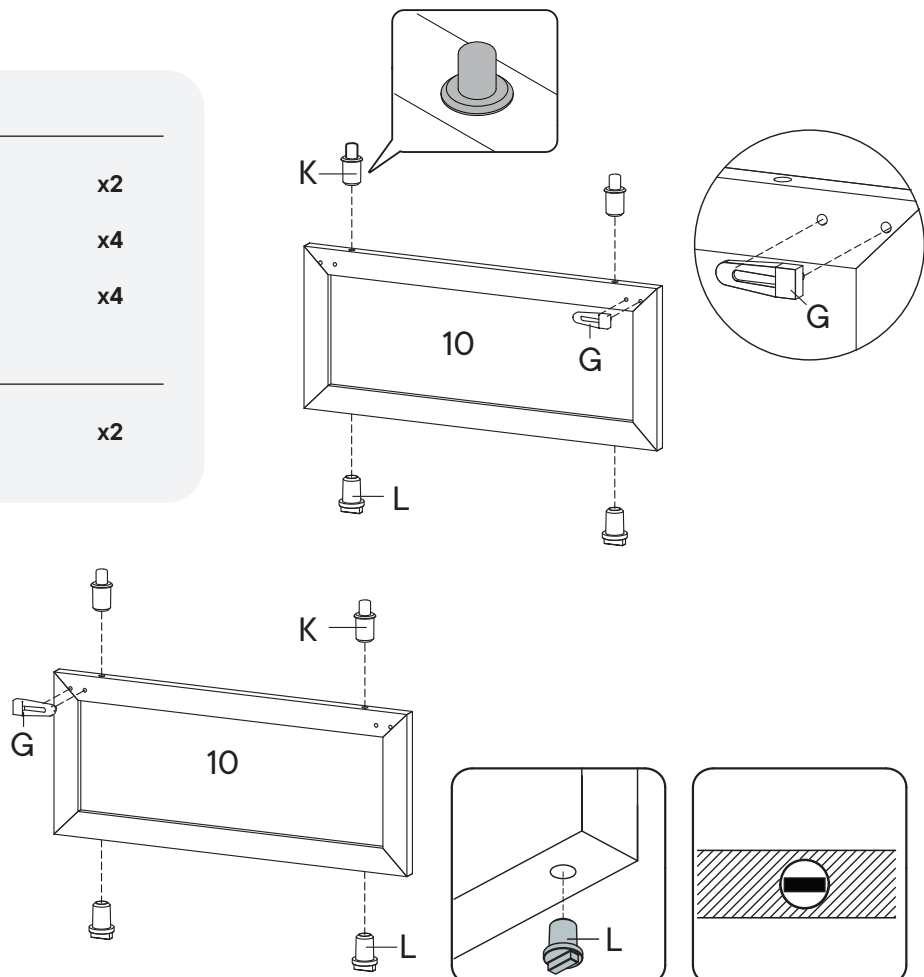
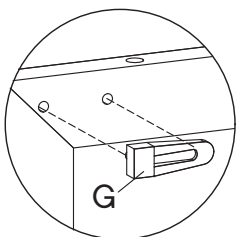

Step 13

HARDWARE

M Silicon Bumper x1

COMPONENTS

10 Frame Door x2

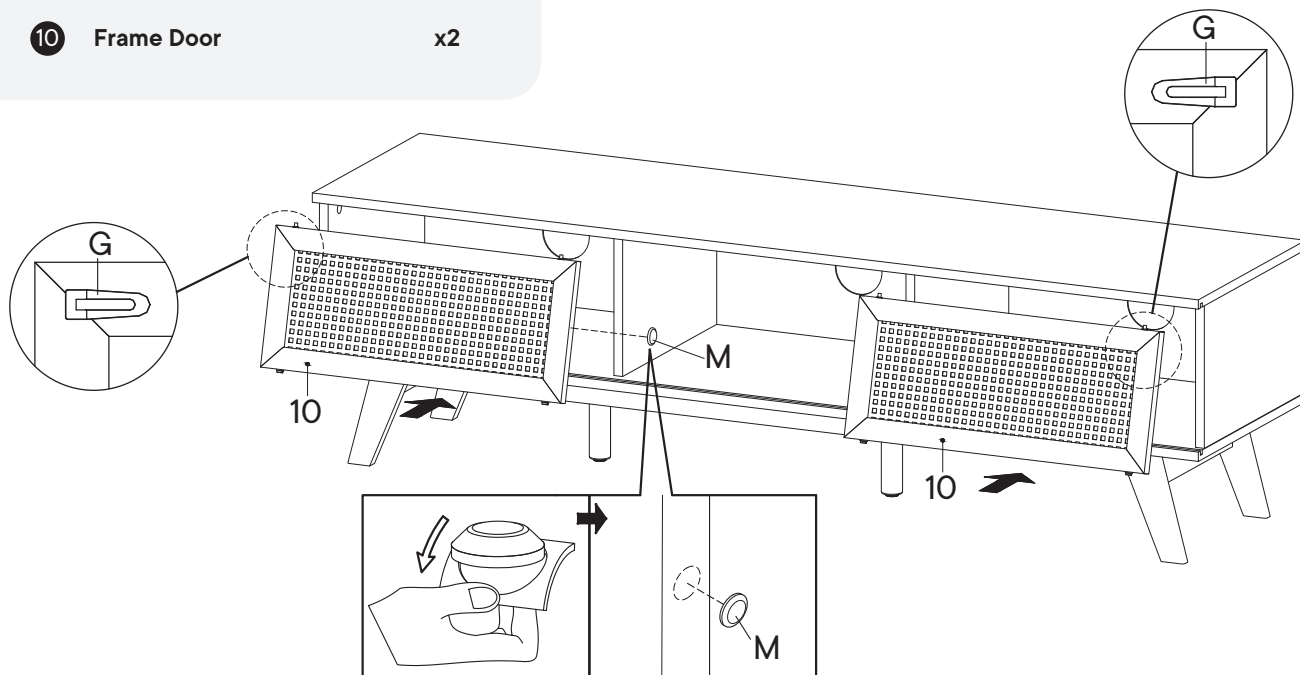
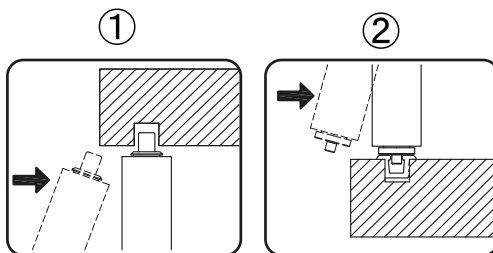

Step 14

HARDWARE

N Wedge x12

O Screw M 3.5 x 15.5 mm x12

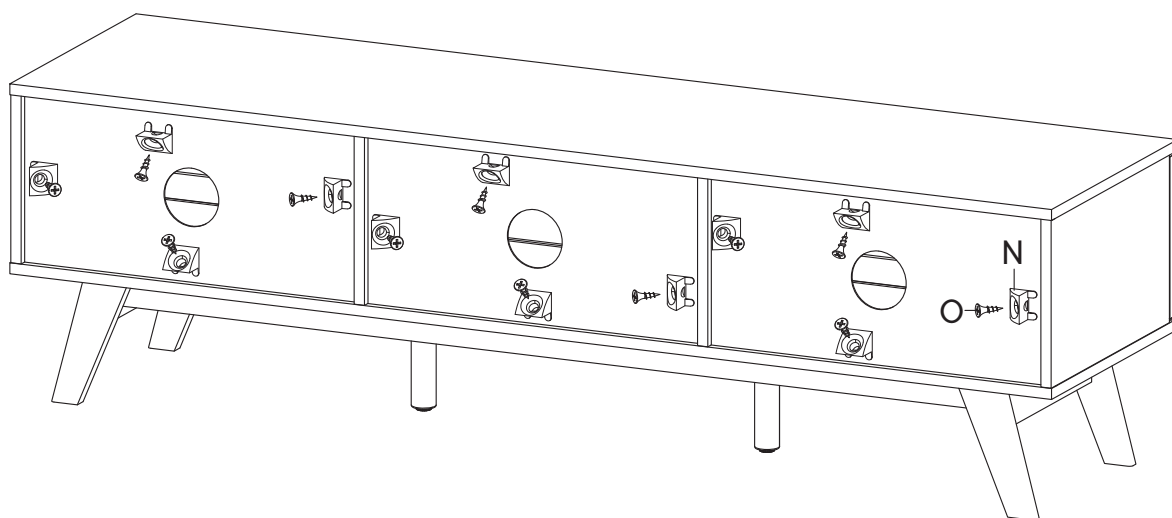
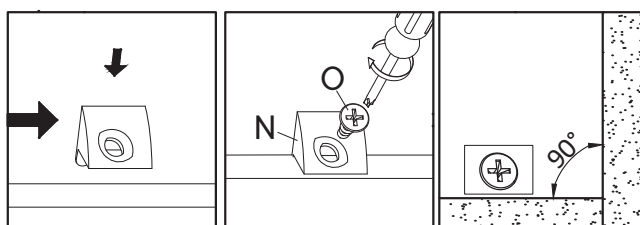

Great job!

TV Stand assembly is complete.

♥ CARING FOR YOUR ITEM

Indoor use only.

Not contract grade.

Clean using a non-abrasive cloth and a mild cleaner.

Never use harsh chemicals, as they could damage the finish or integrity of the item.

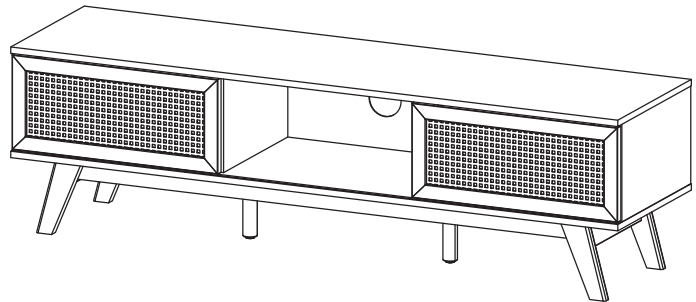

CONNECT WITH US!

Tag us [@modway_furniture](#) and [#modway](#) for a chance to be featured.