

ASSEMBLY INSTRUCTIONS

EEI-5864

VO.01.10.21

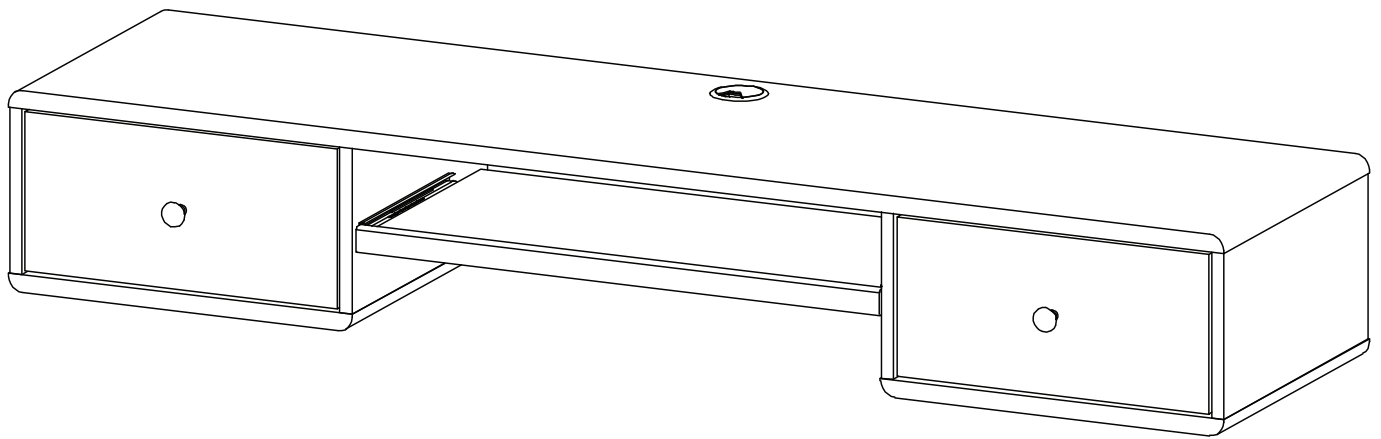

Questions? Contact us!

609.256.9000 • cs@modway.com
www.modway.com

***modway**

Let's get started!

*modway



Read through all of the instructions before starting



Care instructions are listed in the last step of this manual



Approx. 90 minutes assembly time



Make sure you have all parts and components before discarding any packing materials



2 people recommended for assembly

Only use hand tools to assemble this item. Do not use power tools. Do not tighten bolts or screws completely until all hardware is lined up and inserted into the holes.

Do not over-tighten screws and bolts to avoid stripping the hardware or cracking the item.

Assemble your item on a flat, carpeted area, with plenty of space to work. This will prevent damage and scratches to your floors or the item while you're assembling the product.

Keep all components and packaging out of reach of children or animals to avoid risk of choking or suffocation.

Furniture components:

1	Top Board	x1	11	Bottom Drawer	x2
2	Bottom Board	x2	12	Keyboard Drawer Base	x1
3	Side Board Left	x1	13	Front Skirt	x1
4	Side Board Right	x1	14	Back Board Small	x2
5	Center Board Left	x1	15	Back Board Big	x1
6	Center Board Right	x1			
7	Front Drawer	x2			
8	Side Drawer Left	x2			
9	Side Drawer Right	x2			
10	Back Drawer	x2			

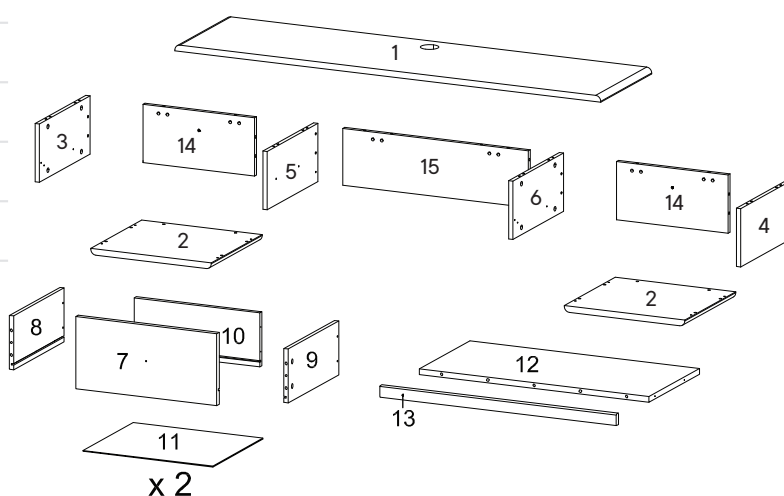

Provided hardware:

A		Cam Bolt Ø6 x 35 mm	x31	J		Drawer Knob	x2	S		Screw M4 x 22 mm	x2
B		Cam Lock Ø15 mm	x23	K		JCN Nut	x12	RM30A		Drawer Runner	x2
C		Cam Lock Ø12 mm	x8	L		Screw M 3.5 x 15.5 mm	x8	PA63		Long Bracket	x1
D		Wood Dowel Ø8 x 30 mm	x40	M		Wedge	x8	PA37		Medium Bracket	x2
E		Wood Dowel Ø6 x 30 mm	x4	N		Grommet Cover	x1	PA05		Short Bracket	x6
F		Screw M 6 x 10.5 mm	x20	O		Screw 5.5 x 45 mm	x16	RB25A		Keyboard Drawer Runner	x1
G		Screw M 3.5 x 13 mm	x12	P		Wall Plug	x16				
H		Screw M 8 x 39 mm	x8	Q		Screw M 6 x 15 mm	x12				
I		Allen Key	x2	R		Wall Mounted Bolt	x2				

What you need:



Phillips

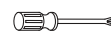

Phillips Head Screwdriver

Wait!

Missing parts or hardware? Need assistance?
Contact us before returning your item. We're here to help!
609.256.9000 • cs@modway.com

Step 1

HARDWARE

- A** Cam Bolt Ø6 x 35 mm x8
- E** Wood Dowel Ø6 x 30 mm x4

COMPONENTS

- 7** Front Drawer x2
- 8** Side Drawer Left x2
- 9** Side Drawer Right x2

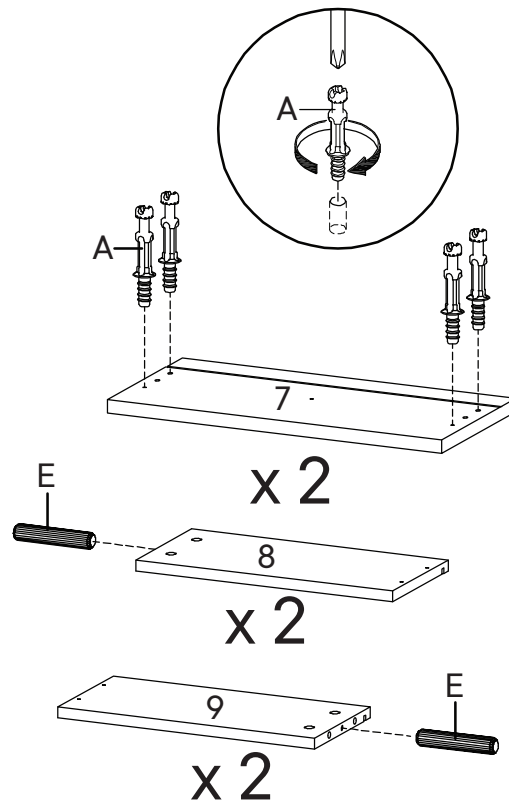

Step 2

HARDWARE

- C** Cam Lock Ø12 mm x8
- H** Screw M 8 x 39 mm x8

COMPONENTS

- 7** Front Drawer x2
- 8** Side Drawer Left x2
- 9** Side Drawer Right x2
- 10** Back Drawer x2
- 11** Bottom Drawer x2

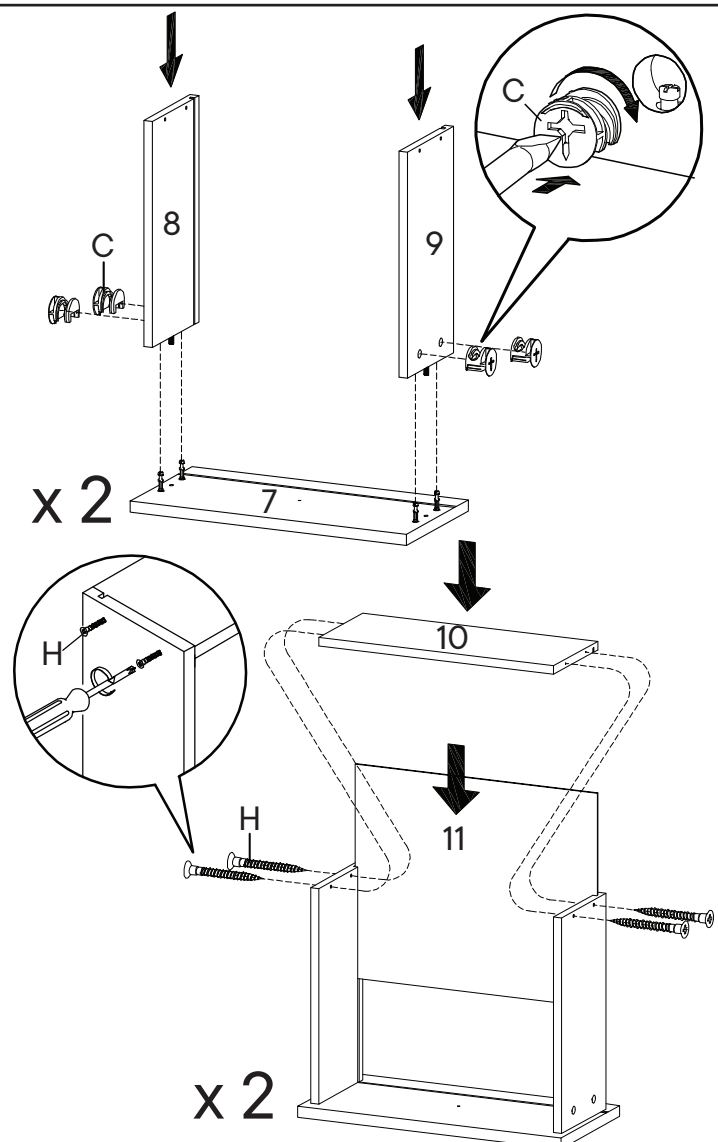

Step 3

HARDWARE

G	Screw M 3.5 x 13 mm	x12
J	Drawer Knob	x2
S	Screw M4 x 22 mm	x2
RM30A	Drawer Runner	x2

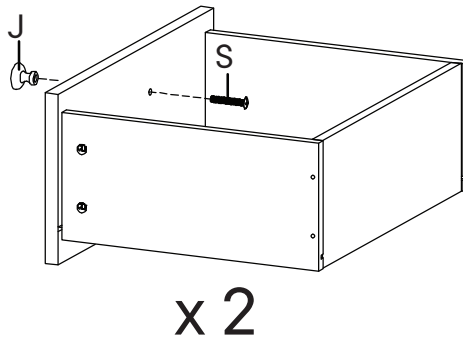
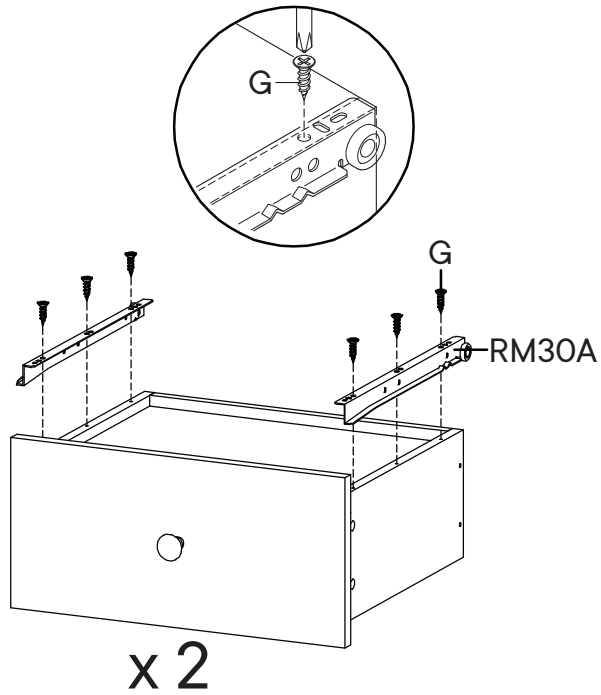

Step 4

HARDWARE

L	Screw M 3.5 x 15.5 mm	x8
M	Wedge	x8

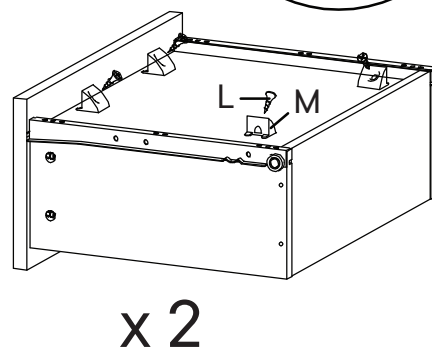
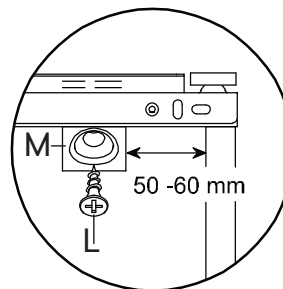
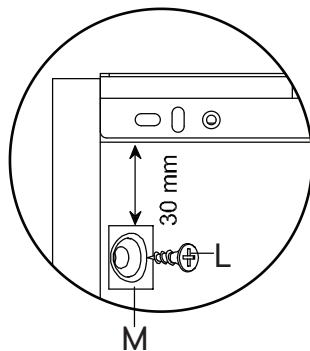

Step 5

HARDWARE

- A** Cam Bolt Ø6 x 35 mm x3
- D** Wood Dowel Ø8 x 30 mm x2
- F** Screw M 6 x 10.5 mm x4
- RB25A** Keyboard Drawer Runner x1

COMPONENTS

- 12** Keyboard Drawer Base x1
- 13** Front Skirt x1

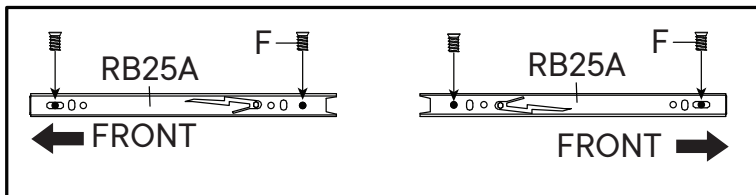
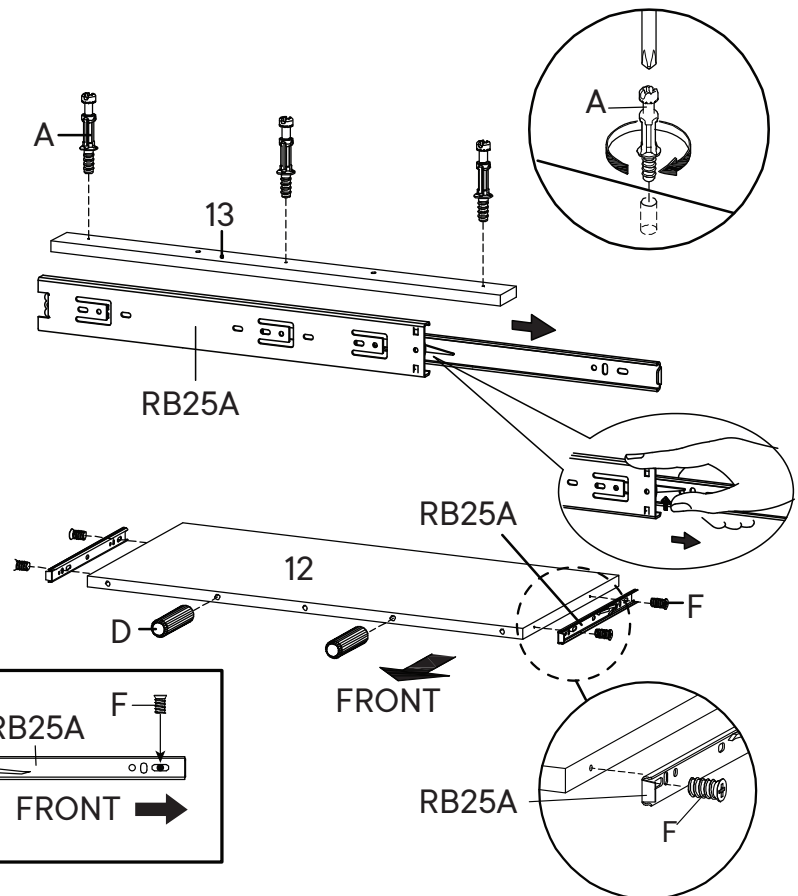

Step 6

HARDWARE

- B** Cam Lock Ø15 mm x3

COMPONENTS

- 12** Keyboard Drawer Base x1
- 13** Front Skirt x1

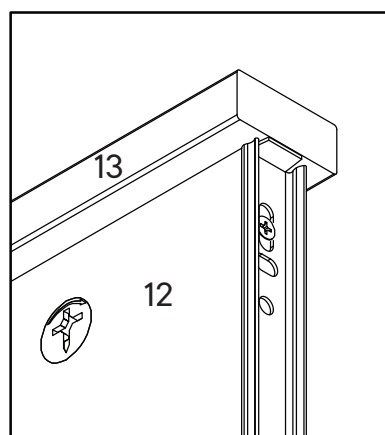
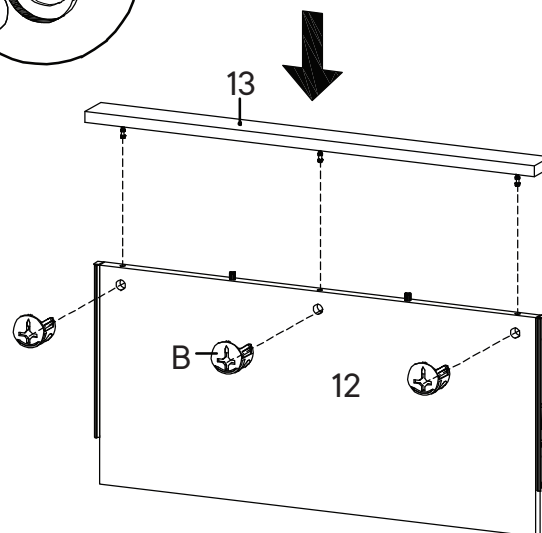
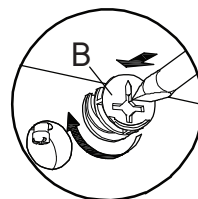

Step 7

HARDWARE

D	Wood Dowel Ø8 x 30 mm	x16
F	Screw M 6 x 10.5 mm	x12
RM30A	Drawer Runner	x2

COMPONENTS

3	Side Board Left	x1
4	Side Board Right	x1
5	Center Board Left	x1
6	Center Board Right	x1

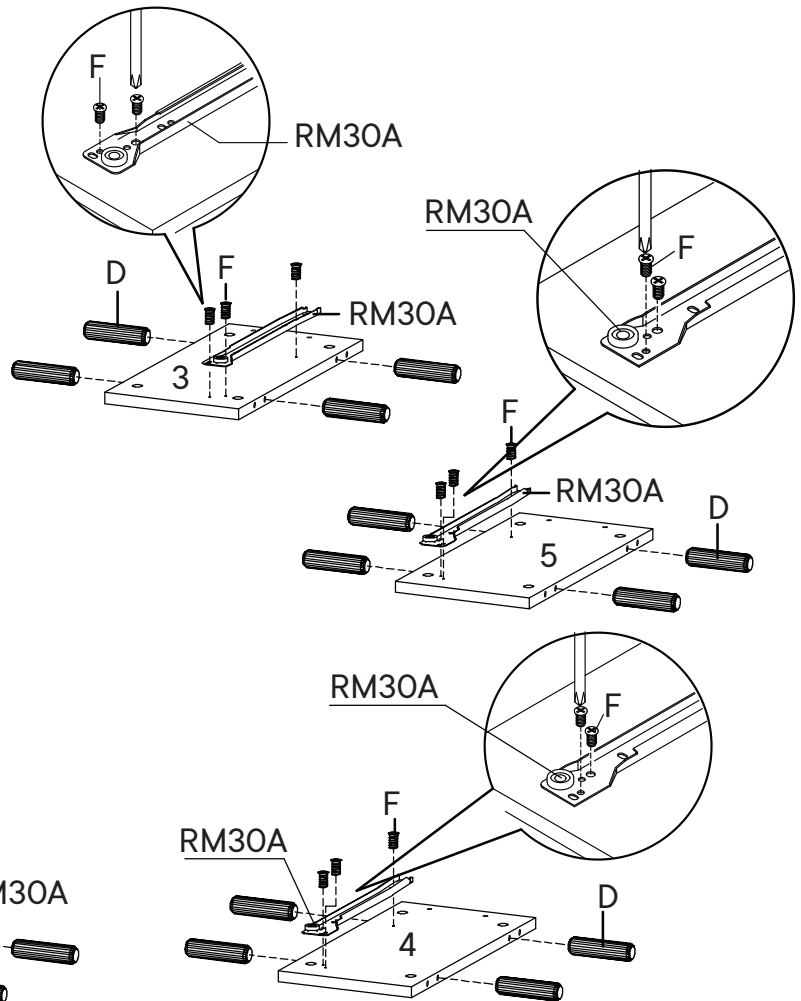

Step 8

HARDWARE

A	Cam Bolt Ø6 x 35 mm	x8
D	Wood Dowel Ø8 x 30 mm	x22

COMPONENTS

2	Bottom Board	x2
14	Back Board Small	x2
15	Back Board Big	x1

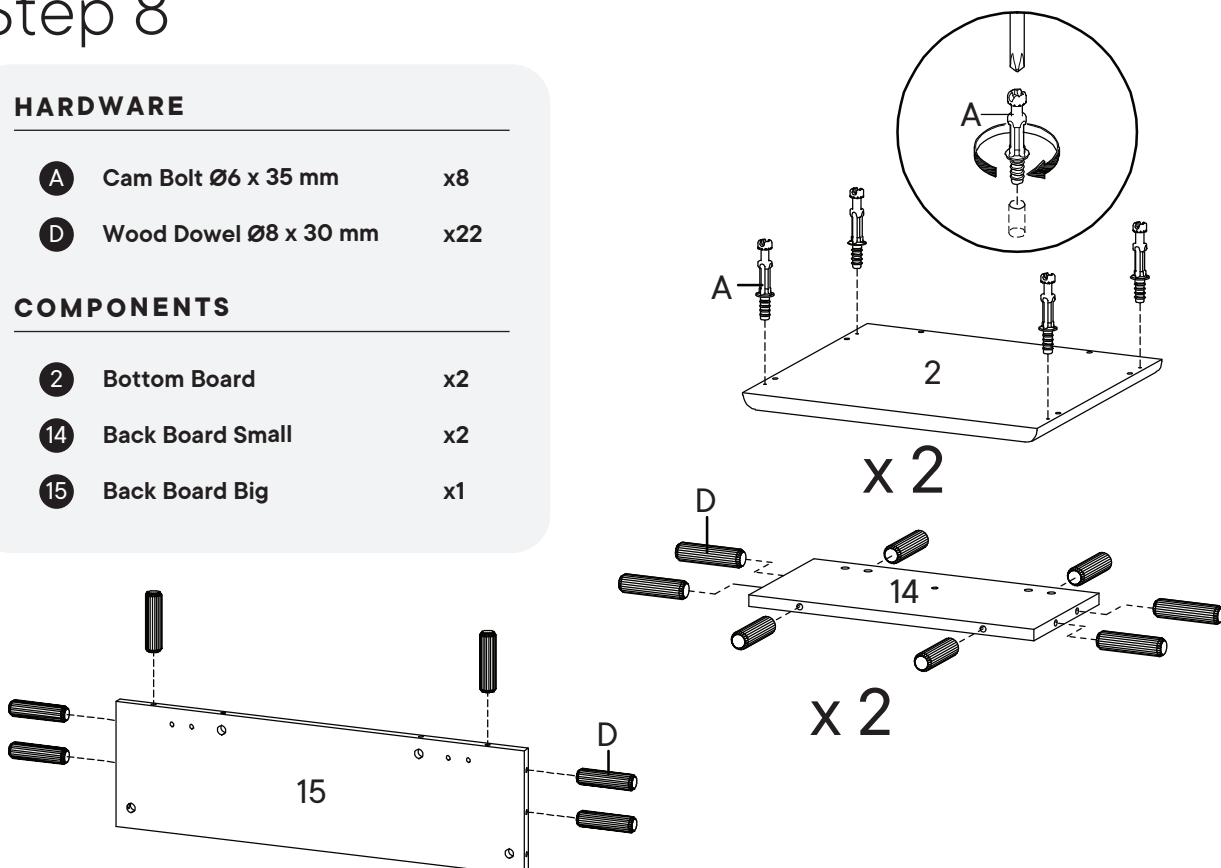

Step 9

COMPONENTS

3	Side Board Left	x1
4	Side Board Right	x1
5	Center Board Left	x1
6	Center Board Right	x1
14	Back Board Small	x2

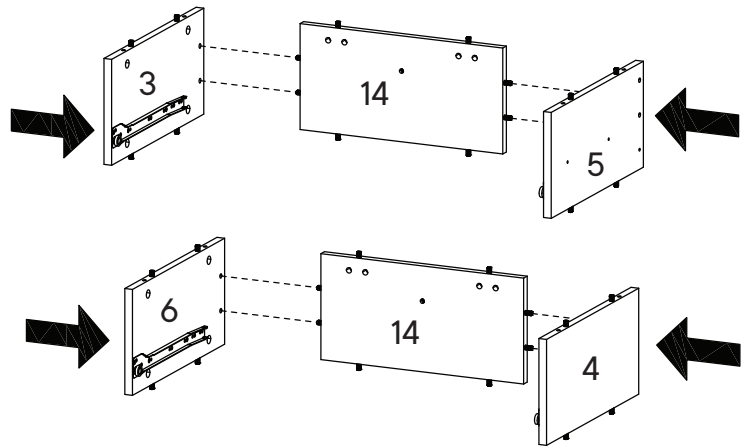

Step 10

HARDWARE

B	Cam Lock Ø15 mm	x8
---	-----------------	----

COMPONENTS

2	Bottom Board	x2
---	--------------	----

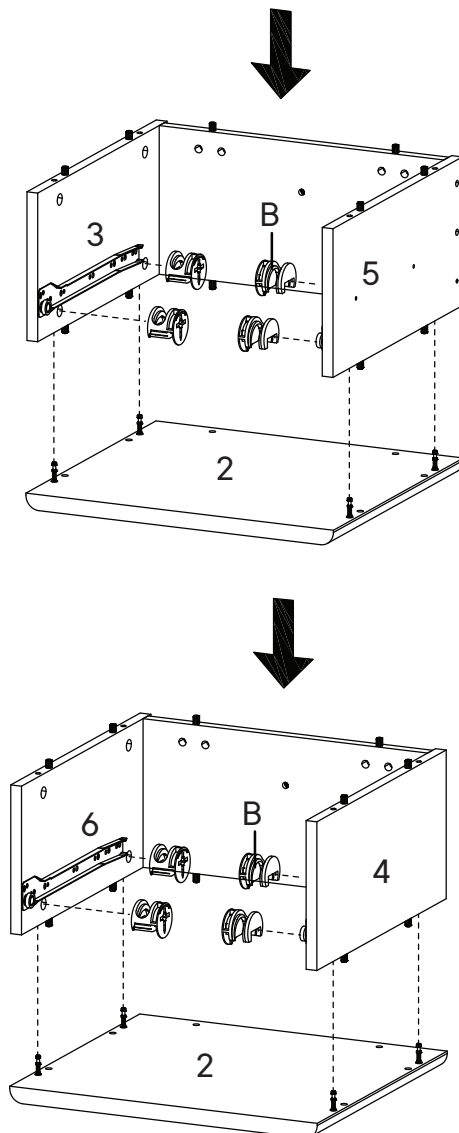
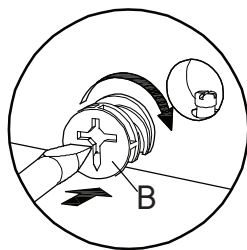

Step 11

HARDWARE

- A** Cam Bolt Ø6 x 35 mm x2
- F** Screw M 6 x 10.5 mm x4
- RB25A** Keyboard Drawer Runner x1

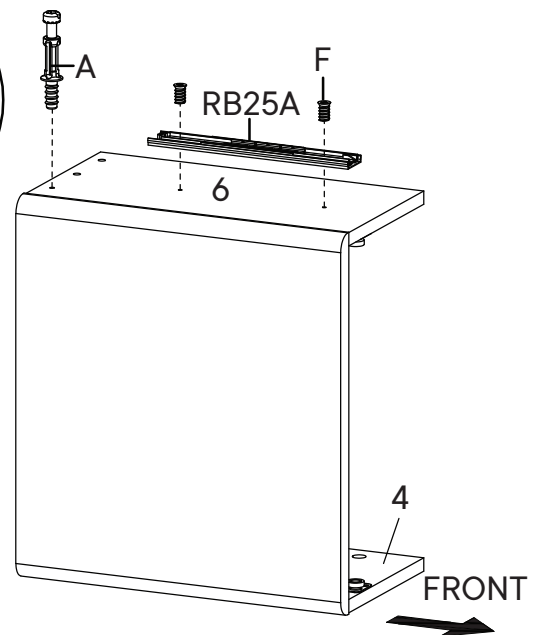
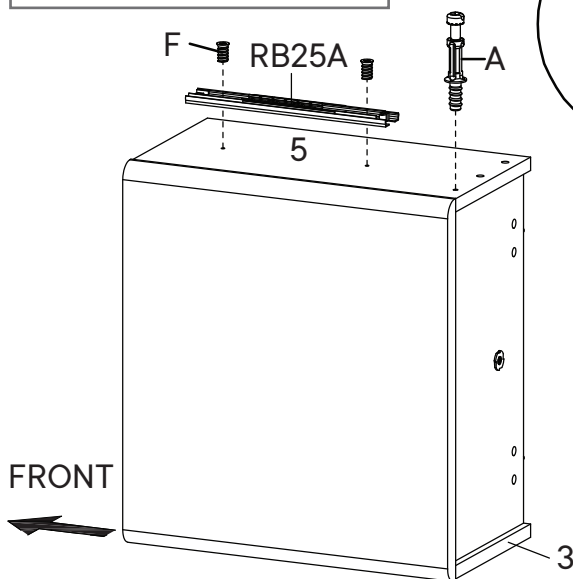
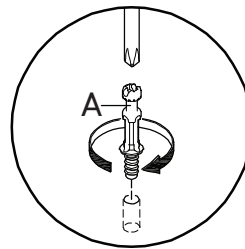
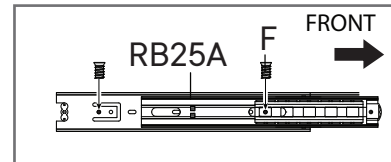
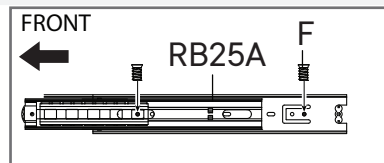

Step 12

HARDWARE

- B** Cam Lock Ø15 mm x2

COMPONENTS

- 15** Back Board Big x1

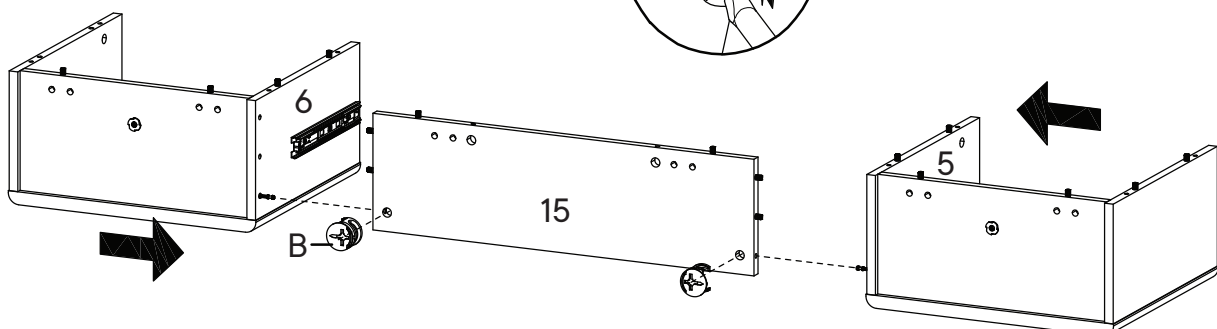
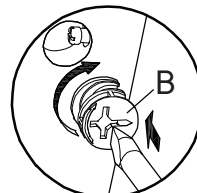

Step 13

HARDWARE

I	Allen Key	x2
K	JCN Nut	x12
Q	Screw M 6 x 15 mm	x12
PA05	Short Bracket	x6

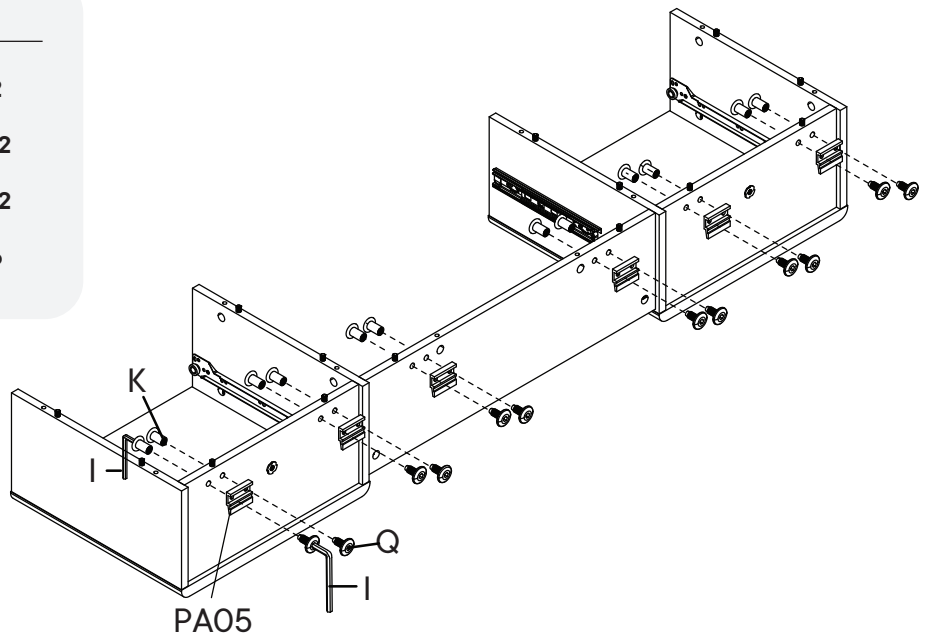
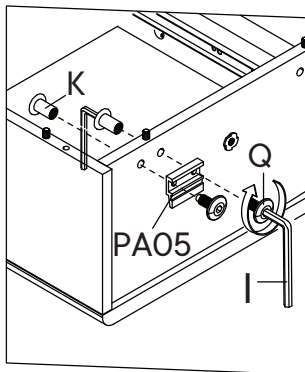

Step 14

HARDWARE

A	Cam Bolt Ø6 x 35 mm	x10
----------	---------------------	-----

COMPONENTS

1	Top Board	x1
----------	-----------	----

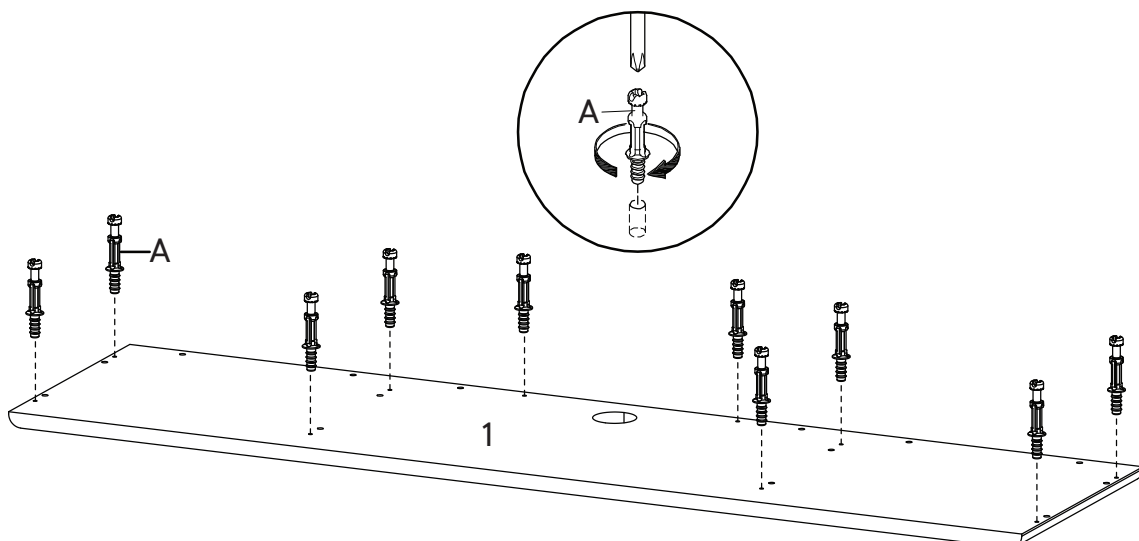

Step 15

HARDWARE

B Cam Lock Ø15 mm x10

COMPONENTS

1 Top Board x1

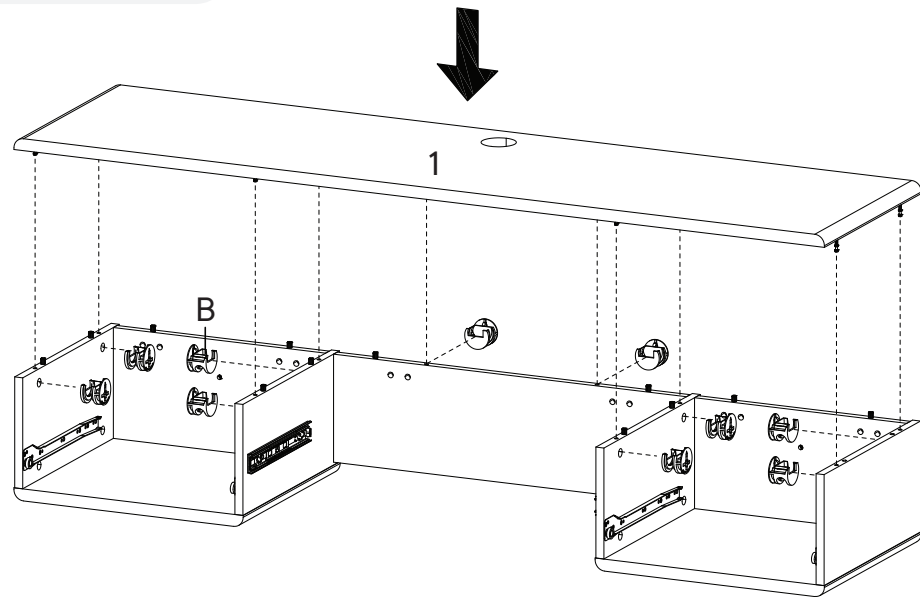
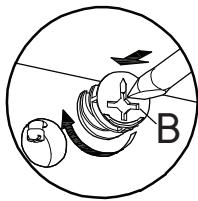

Step 16

Determine your desired height (Y), recommended at 760 mm, then subtract by 85 mm.

This is the drill holes height from the floor (Z).

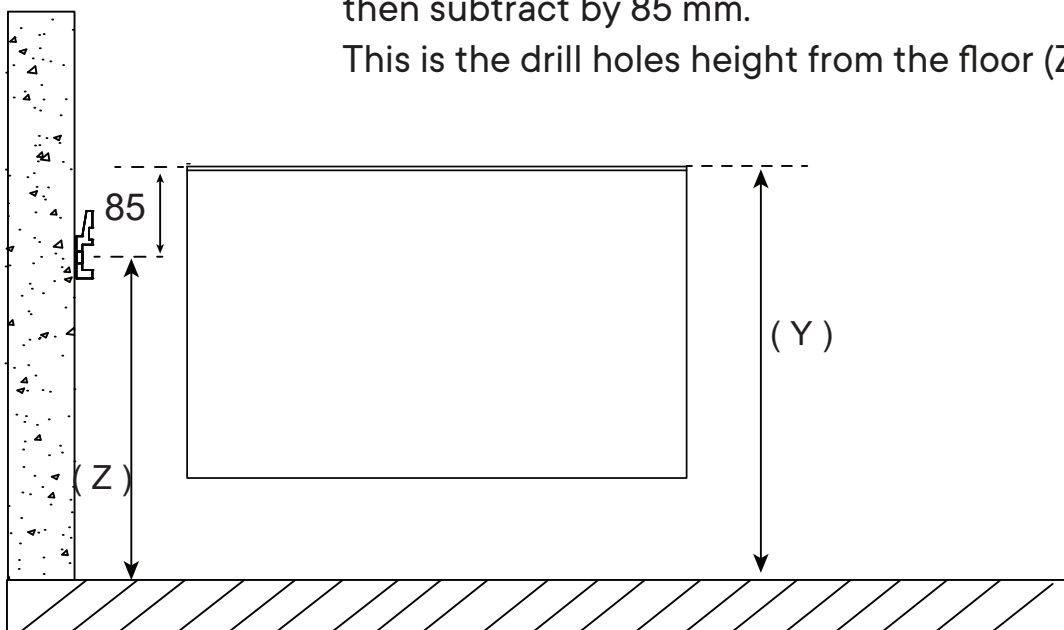

Step 17

Please use minimum 2 holes on each group of the Medium Bracket and Long Bracket, and minimum 1 hole, to apply the wall plug and screw. Use additional holes when necessary.

* Long Bracket and Medium Bracket

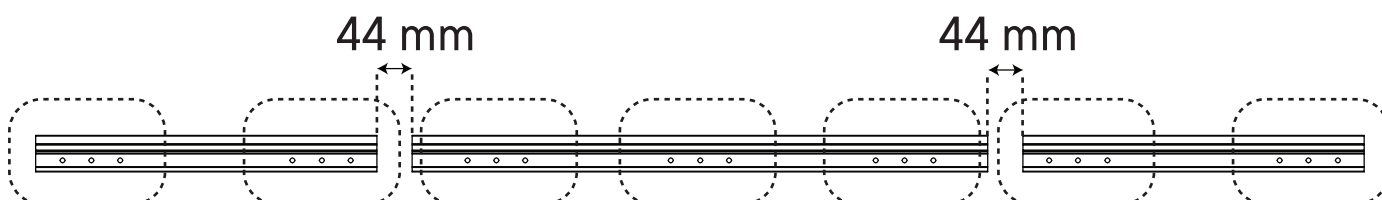





Different wall materials require unique wall fasteners.

The wall plugs (P) and screws (O) are designed for fixing to concrete walls only.

Please consult your local hardware store to ensure you are using the correct hardware for your wall type.

Step 18

HARDWARE

	Screw 5.5 x 45 mm	x14
	Wall Plug	x14
	Medium Bracket	x2
	Long Bracket	x1

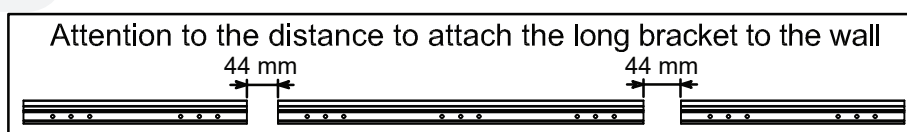

Use Waterpass to ensure the drill position

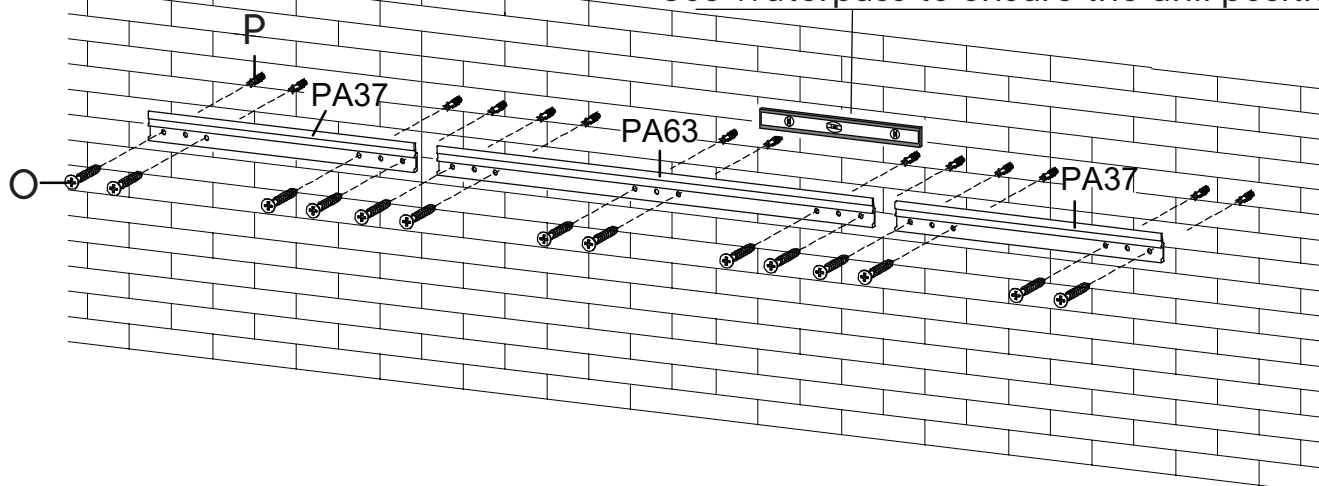

Step 19

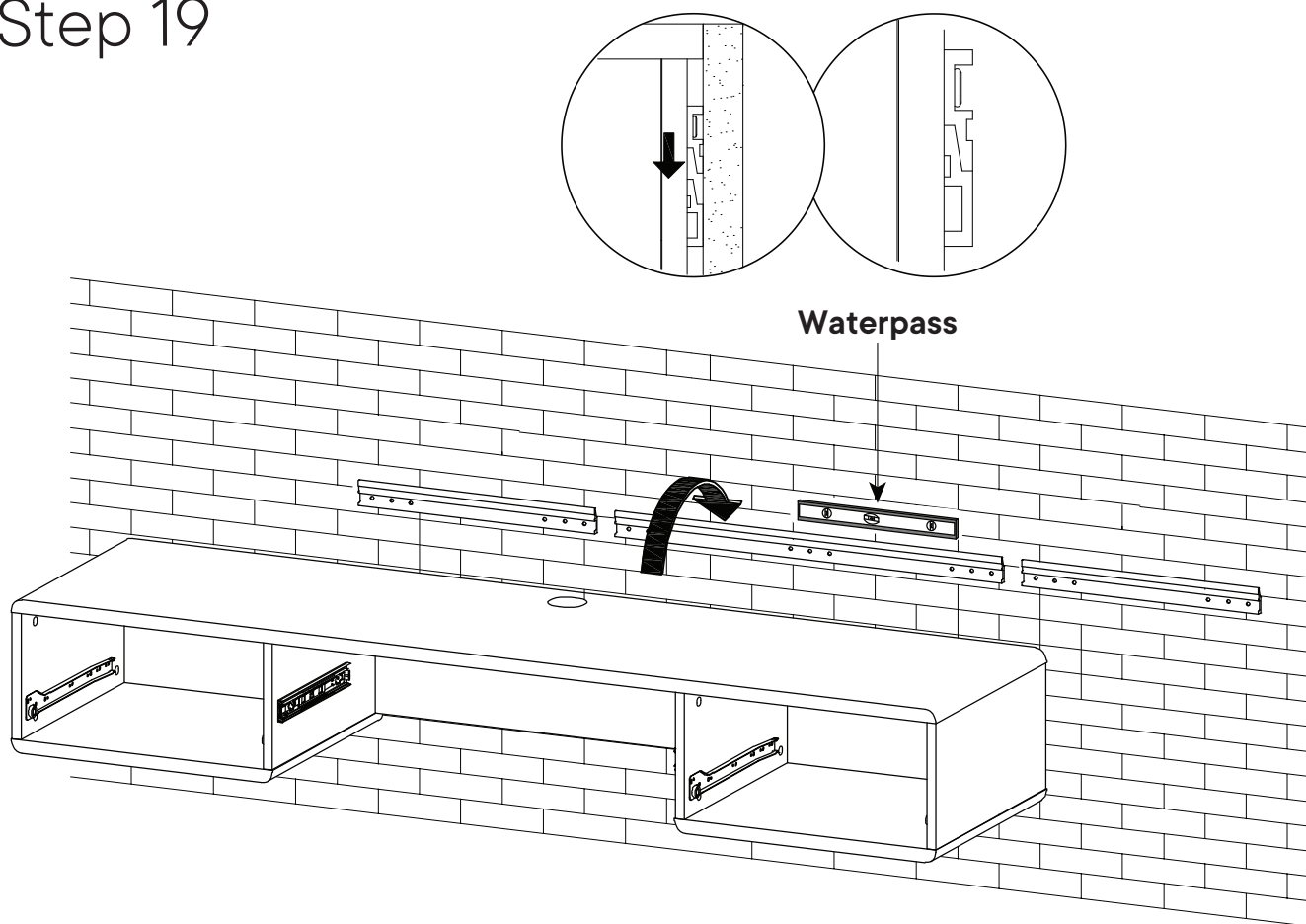

Step 20

HARDWARE

R Wall Mounted Bolt x2

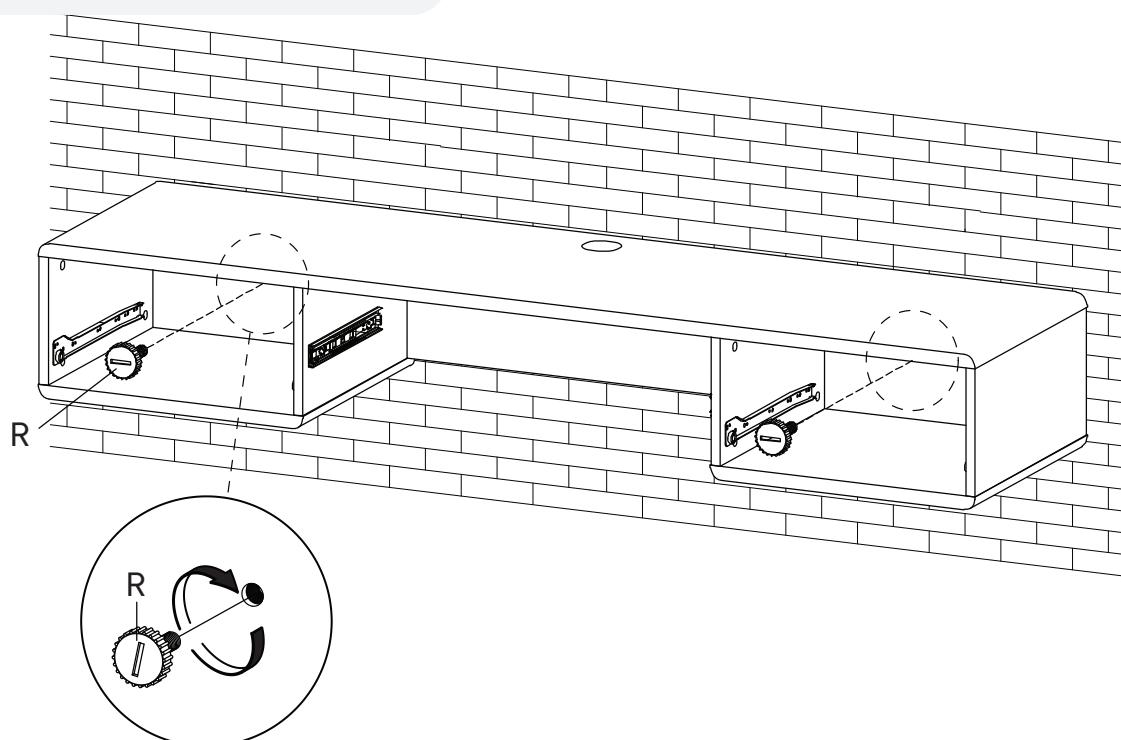

Step 21

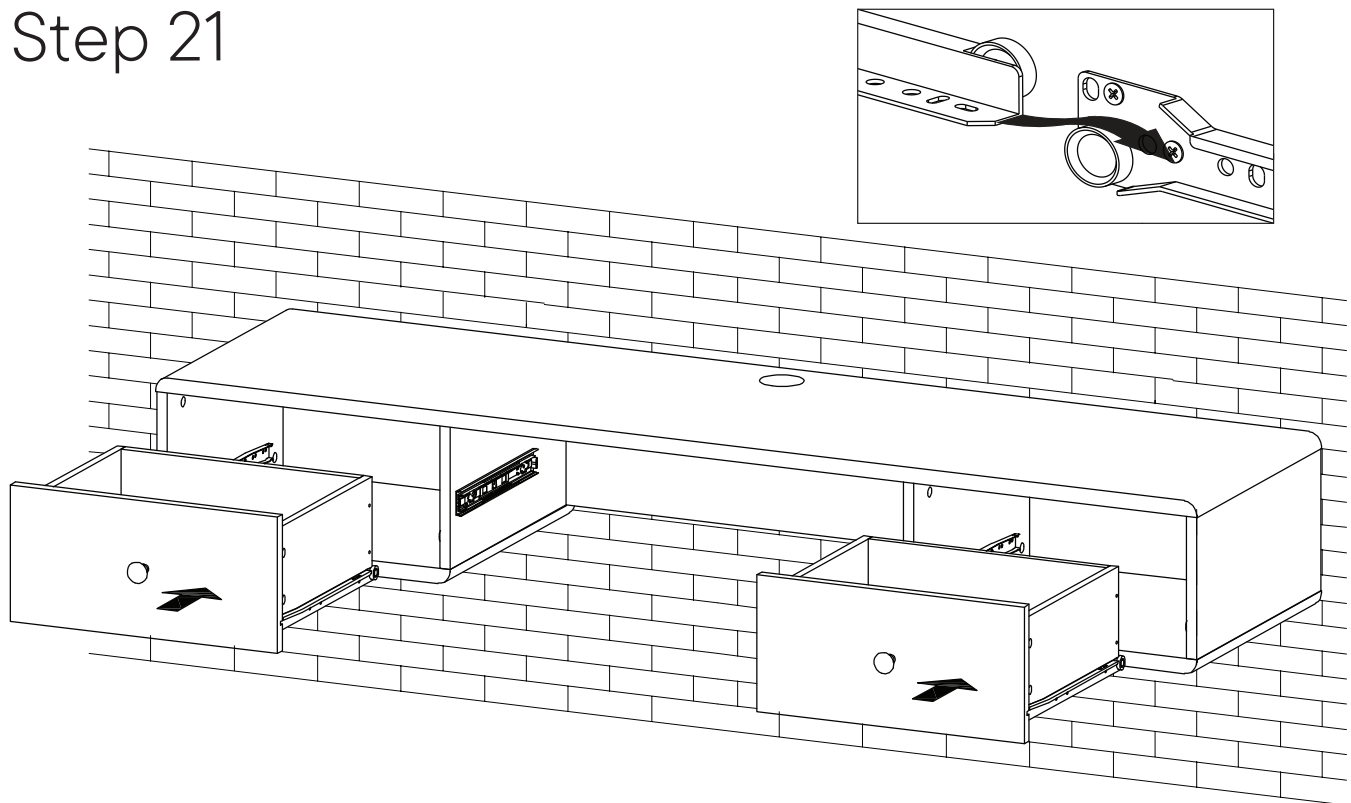

Step 22

HARDWARE

N Grommet Cover x1

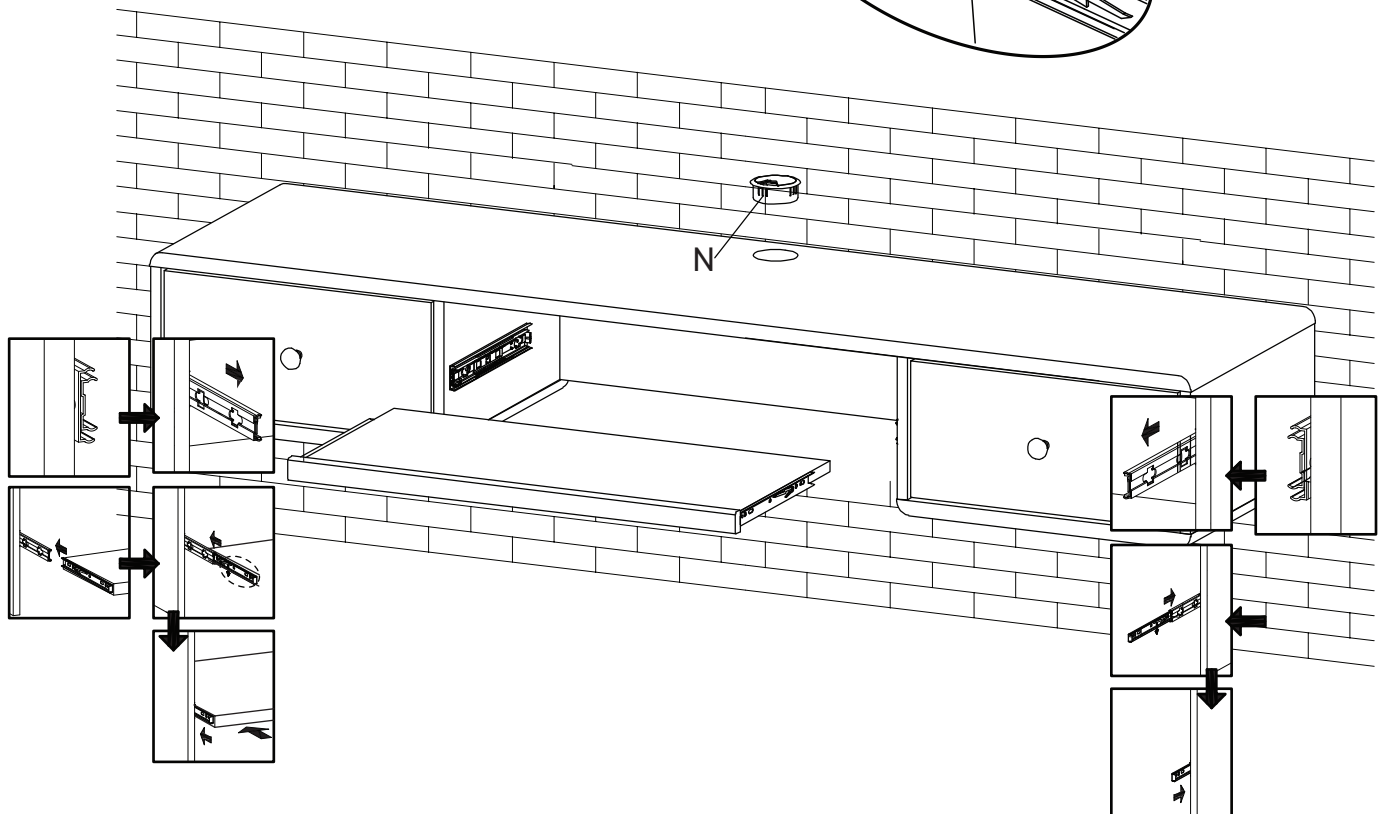
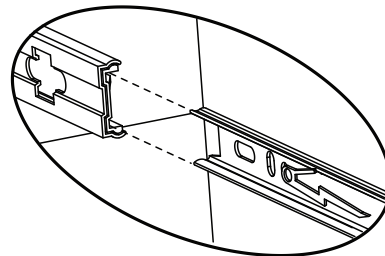

Great job!

Desk assembly is complete.

♥ CARING FOR YOUR ITEM

Indoor use only.

Not contract grade.

Clean using a non-abrasive cloth and a mild cleaner.

Never use harsh chemicals, as they could damage the finish or integrity of the item.

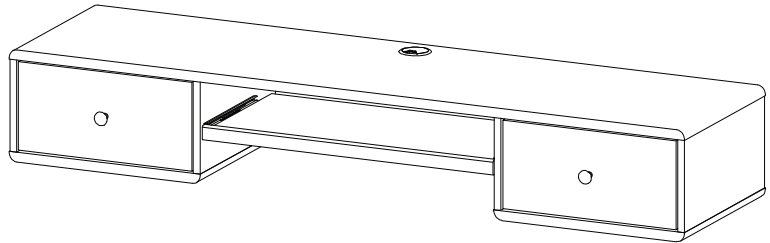

CONNECT WITH US!   

Tag us **@modway_furniture** and **#modway** for a chance to be featured.