

# EEI-2140 ARMLESS SOFA



Thank you for purchasing the **MODWAY ARMLESS SOFA!**

Before you start, here are some helpful advice:

1. We suggest you spend a short time reading through this leaflet and then follow the simple step-by step instructions
2. Owing to the size and weight of the sofa, we recommend that it is assembled by two adults on a carpeted or padded area, in the room that it is intended for. Approximate time: 30 minutes.
3. Please do not use any tools other than those provided or recommended in these instructions.
4. Please do not throw away any of the packaging or instructions until you have checked all the components and hardware and the furniture is fully assembled.
5. Assemble all components loosely until advised to tighten. Depending on use, it may be necessary to tighten the component from time to time,so please save the tools that have been provided.
6. Please keep all pieces out of reach of children.



## Components:

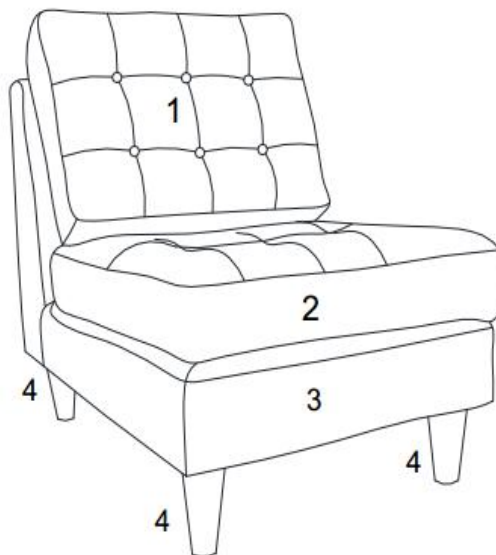

1. Back Cushion x1

2. Seat Cushion x1

3.Sofa Body x1

4. Leg x4

# EEI-2140 ARMLESS SOFA

## STEP 1:

Please put the **Sofa Body (3)** upside down on a carpeted or padded area by two adults to make the corners fully visible. Open the Zipper on the bottom of **Sofa Body (3)** as shown, take out the packages of **Legs (4)**, then close the Zipper on the bottom of **Sofa Body (3)**. Take off the black protection cover on the **Legs (4)**. Insert 1 piece of **Leg (4)** into the bottom of **Sofa Body (3)** as shown. Use hands to tighten the **Leg (4)** clockwise until secure. Repeat the same steps for the other three pieces of **Leg (4)**.

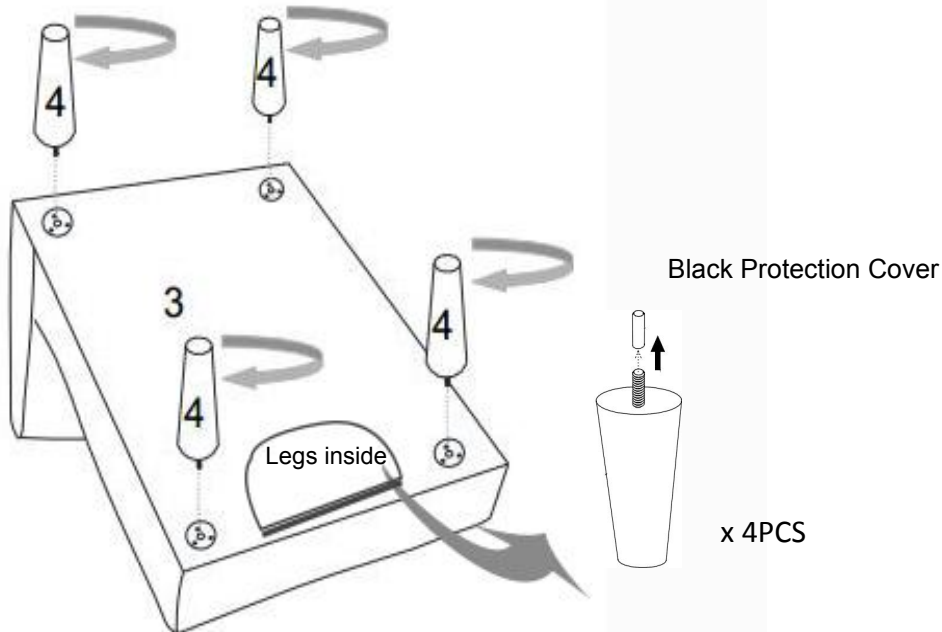

## STEP 2:

Carefully turn over the assembled **Sofa Body (3)** as shown. Tear off the Protect film attached onto the Velcro at first. Then place the **Back Cushion (1)** and **Seat Cushion (2)** to the assembled **Sofa Body (3)** as shown. Attach the **Seat Cushion (2)** by using Velcro.

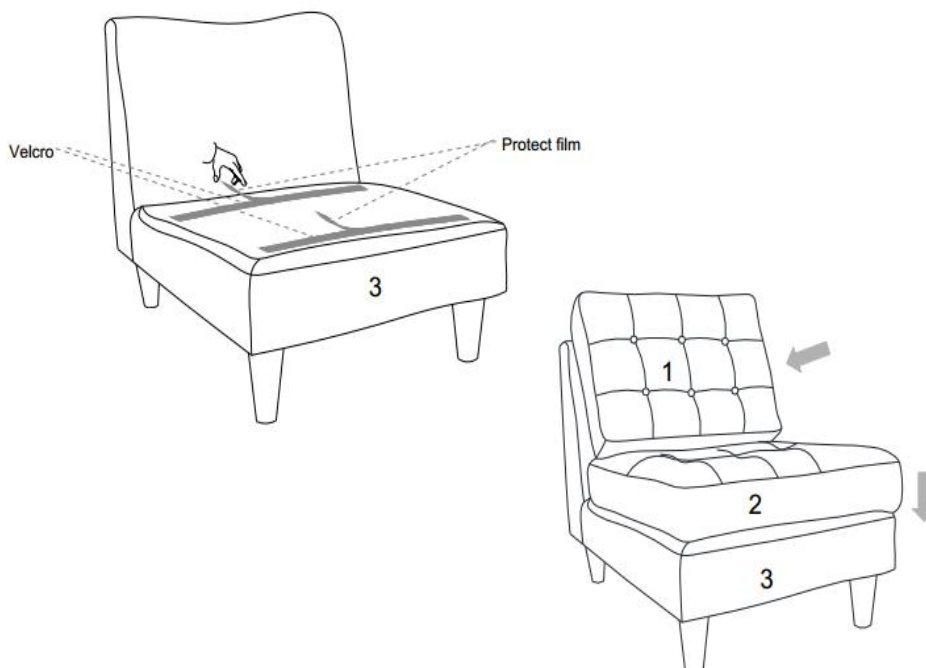

Assembly is complete. The Armless sofa is ready to enjoy now!

# EEI-2140 ARMLESS SOFA

## STEP 3:

If you want the armless sofa combine with other section, put the assembled **Sofa Body (3)** upside down on a carpeted or padded area. Screw the Clip into the bottom of sofa right end by using screws. Using a Phillips head screw driver to tighten the screws. Repeat the same steps for the Post.

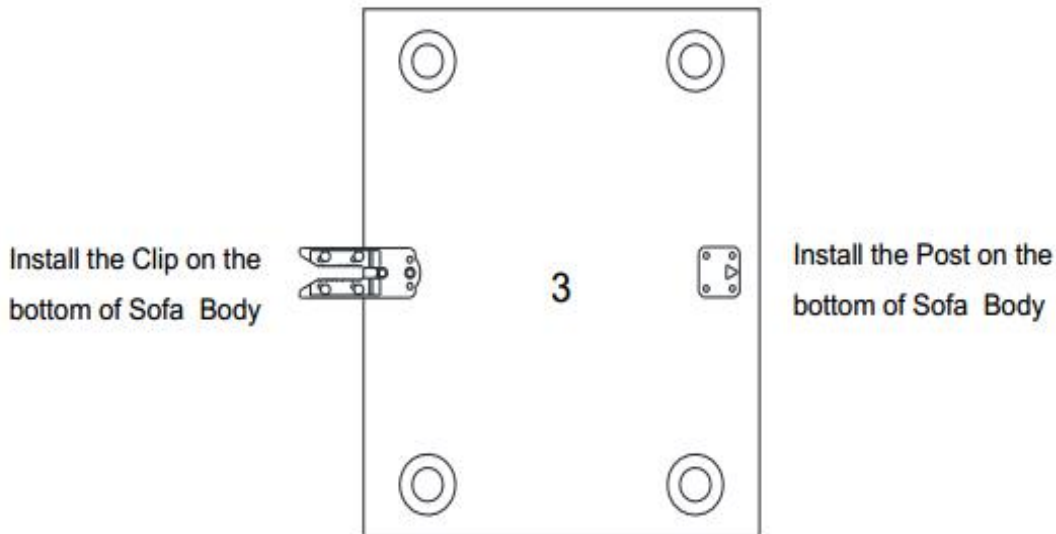

## STEP 4:

Please place the **Left Section** at your desired location.

Align the Post on the bottoms of **Left Section** to the Clip on the bottom of **Armless Sofa** as shown at first.

Push the **Armless Sofa** close to the **Left Section** slowly until the Clip and the Post click together tightly.

Then align the Clip on the bottom of **Right Section** to the Post on the bottom of **Armless Sofa**.

Push the **Right Section** close to the **Armless Sofa** slowly until the Clip and the Post click together tightly.

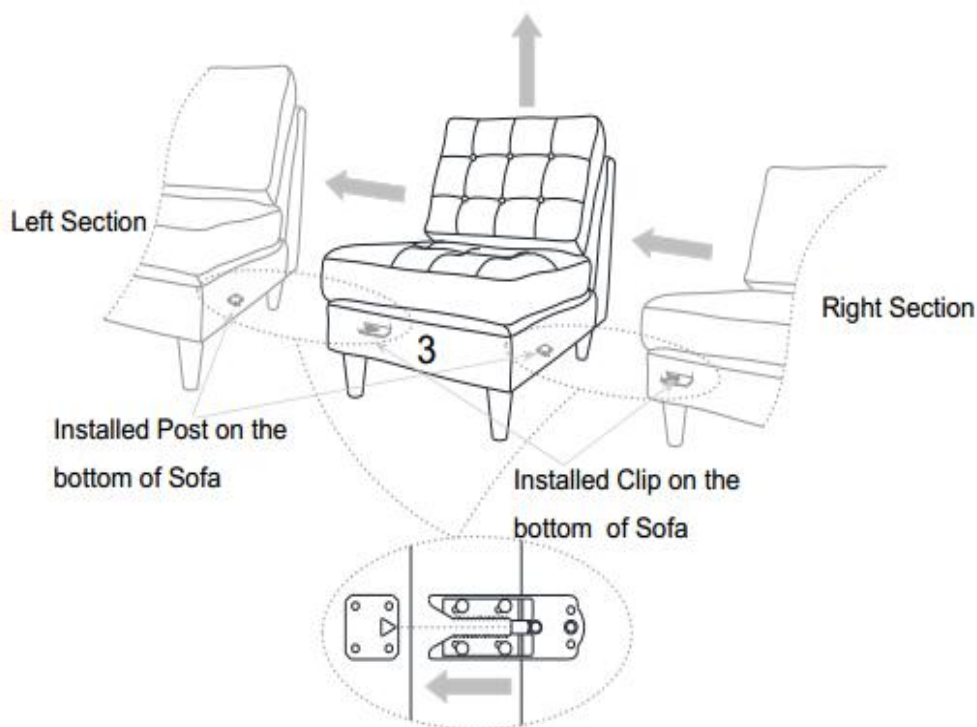

If you want to unlock the sofa. Please lift up the **Armless Sofa** By two adults.